



## **WESTBOURNE GARDENS, W2**

**£495 PER WEEK (£2,145 PCM) Furnished**

**A LOVELY BRIGHT ONE BEDROOM FLAT ON THE SECOND FLOOR OF THIS PERIOD BUILDING ON THIS POPULAR GARDEN SQUARE LOCATED IN THIS PERIOD CONVERSION.**

Long Let, 1 Bedroom, 1 Reception Room, 1 Bathroom, Flat/Apartment, Upper Floor without Lift, Communal Gardens, Furnished, 524 Approx Sq Ft







### **DESCRIPTION:**

A fantastic, bright one bedroom, second floor flat which has just been refurbished. Located in this period conversion on this popular garden square close to all the shopping and restaurant facilities of the Westbourne Park, Queensway, and Notting Hill areas. The property benefits from a bright and spacious reception, separate and fully fitted kitchen, fully tiled bathroom, and a pretty and very spacious double bedroom with good storage. The property is offered furnished and viewings are highly recommended.

### **LOCATION:**

Westbourne Gardens is an attractive and peaceful garden square to the northern end of Porchester Road, moments from Royal Oak tube station, and within easy walking distance of the many shopping and transport amenities of Queensway as well as Paddington train station and the Heathrow Express.

### **LOCAL AUTHORITY AND COUNCIL TAX BAND:**

City Of Westminster (Band D)



# WESTBOURNE GARDENS, W2

Approx. gross internal area  
 524 Sq Ft. / 48.7 Sq M.  
 529 Sq Ft. / 49.2 Sq M. Inc. Reduced Headroom

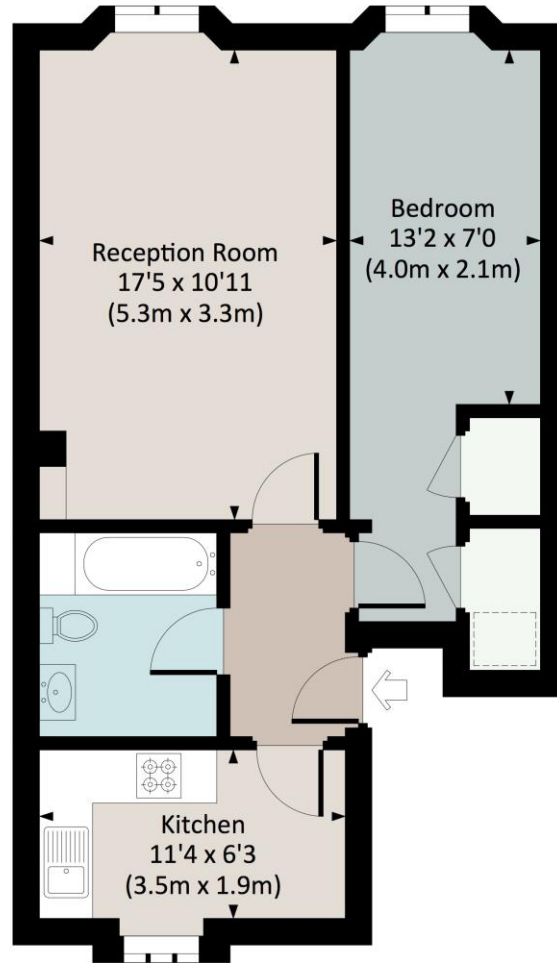

SECOND FLOOR



All measurements have been made in accordance with RICS code of Measuring Practice which are approximate only and only for illustrative purposes. For the avoidance of doubt, Dowling Jones Design shall not be liable for any reliance on these measurements. © 2018 www.dowlingjones.com 020 7610 9933

This floorplan is for illustration purposes only and is not to scale. The position and size of doors, windows, appliances and other features are approximate.

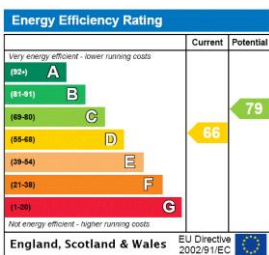

Notting Hill | 0207 727 3227 | nottinghill@winkworth.co.uk



winkworth.co.uk

for every step...

winkworth wishes to inform prospective buyers and tenants that these particulars are a guide and act as information only. All our details are given in good faith and believed to be correct at the time of printing but they don't form part of an offer or contract. No Winkworth employee has authority to make or give any representation or warranty in relation to this property. All fixtures and fittings, whether fitted or not are deemed removable by the vendor unless stated otherwise and room sizes are measured between internal wall surfaces, including furnishings.