

OKEBURN ROAD, SW17  
**£600,000 FREEHOLD**

## A BEAUTIFULLY PRESENTED TERRACED, TWO BEDROOM HOUSE WITH A LARGE WEST FACING GARDEN

Tooting | 020 8767 5221 | [tooting@winkworth.co.uk](mailto:tooting@winkworth.co.uk)

**Winkworth**

for every step...

[winkworth.co.uk](http://winkworth.co.uk)





### **DESCRIPTION:**

A beautifully presented two bedroom, terraced house with a large west facing garden situated in the Totterdown conservation area. The house offers a wonderful open plan living area on the ground floor with a charming bay window to the front. The sitting room area also offers a woodburning stove. The open plan kitchen/dining area leads onto the large rear garden that is mainly laid to patio but is surrounded by mature screening for privacy.

On the first floor there are two double bedrooms with largest being to the front and boasting built in wardrobes. A large, modernised family bathroom is adjacent to bedroom two and has a contemporary yet modern design.

Okeburn road is a popular residential Road which is located off Upper Tooting Road. Tooting Bec Underground Station is within close proximity, as are the wonderful amenities of Tooting Broadway, Tooting market and the open spaces of Tooting Common.







## OKEBURN ROAD, SW17

Approx. Gross Internal Floor Area

**651 Sq. ft/60.52 Sq. m**

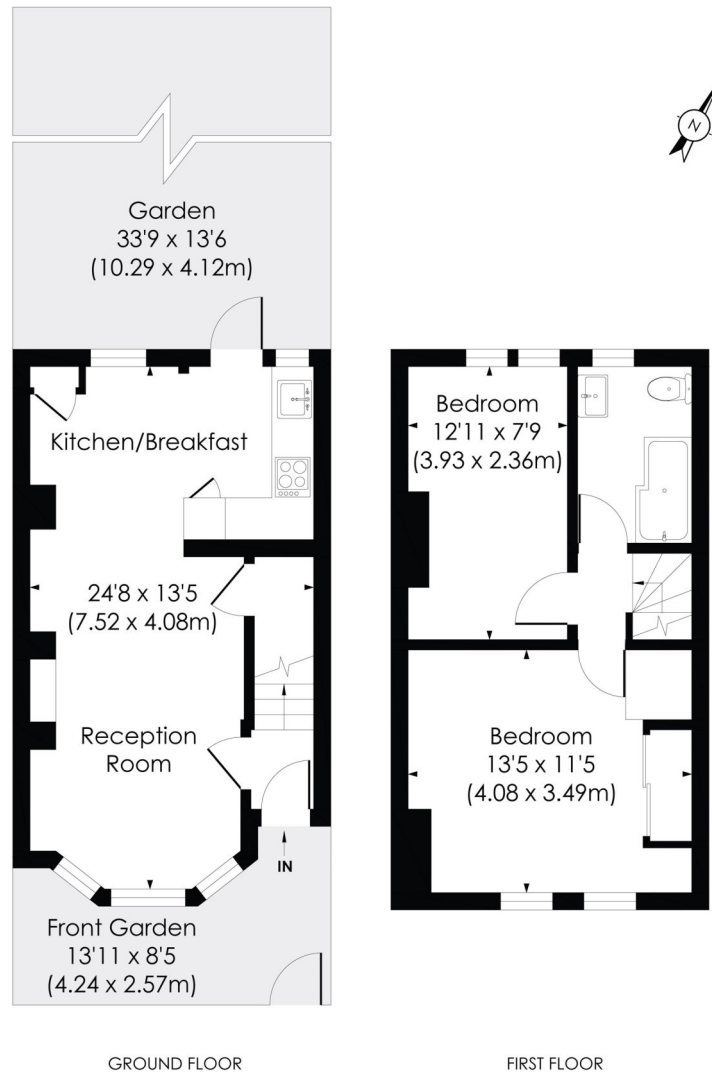

© Pixangle Property Marketing Ltd. info@pixangle.com Tel: 0208 870 2118

**pixangle**  
PROPERTY MARKETING

This floor plan has been prepared for the purpose of illustration only in accordance with the latest RICS code of measuring practice and is not to scale. All measurements and areas are approximate and whilst every effort has been made to ensure the accuracy of the plan contained here, no responsibility is taken for any error, omission or misstatement.

This floorplan is for illustration purposes only and is not to scale. The position and size of doors, windows, appliances and other features are approximate.

**Tooting** | 020 8767 5221 | tooting@winkworth.co.uk

# Winkworth

**for every step...**

**winkworth.co.uk**

Winkworth wishes to inform prospective buyers and tenants that these particulars are a guide and act as information only. All our details are given in good faith and believed to be correct at the time of printing but they don't form part of an offer or contract. No Winkworth employee has authority to make or give any representation or warranty in relation to this property. All fixtures and fittings, whether fitted or not are deemed removable by the vendor unless stated otherwise and room sizes are measured between internal wall surfaces, including furnishings.