



THE CHASE, LONDON, SW4 £2,600 PER MONTH

DESCRIPTION:

This bright and well-presented apartment offers two double bedrooms, a spacious living area and a kitchen that can be open plan or separated by double doors. Located on a prime Clapham street, it also benefits from access to attractive communal gardens and free off-street parking. Ideally positioned next to Clapham Common, it's perfect for professional sharers or a couple seeking a stylish and well-connected home.

Clapham | 0207 871 2777

Winkworth

for every step...

[winkworth.co.uk](https://www.winkworth.co.uk)

The Chase, SW4

Approx. Gross Internal Area 60.39 sq m / 650 sq ft

Key :
CH - Ceiling Height

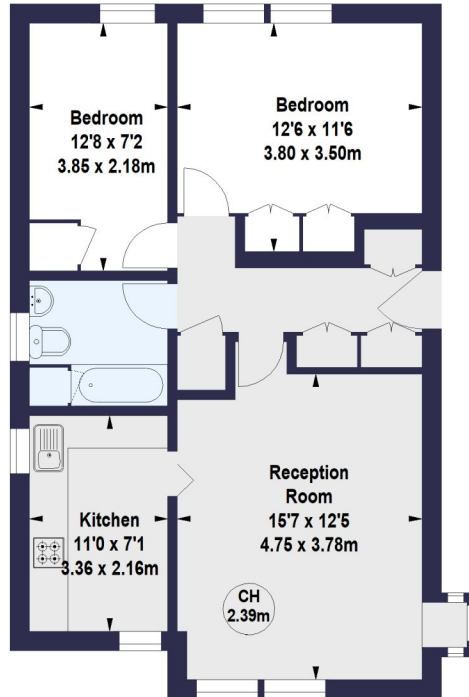

Second Floor

Winkworth

The floor plan is not to scale and measurements and areas shown are approximate and therefore should be used for illustrative purposes only. The plan has been prepared in accordance with the RICS code of Measuring Practice and whilst we have confidence in the information produced, it must not be relied on. If there is any aspect of particular importance, you should carry out or commission your own inspection of the property. Copyright of KTV Photography.

This floorplan is for illustration purposes only and is not to scale. The position and size of doors, windows, appliances and other features are approximate.

Score	Energy rating	Current	Potential
92+	A		
81-91	B		
69-80	C	69 C	77 C
55-68	D		
39-54	E		
21-38	F		
1-20	G		

Deposit: Five Weeks' Rent

Holding Deposit: One Weeks' Rent

Council Tax Band: D

Where no figures are shown, we have been unable to ascertain the information. All figures that are shown were correct at the time of printing.

Clapham | 0207 871 2777

Winkworth

for every step...

winkworth.co.uk

Winkworth wishes to inform prospective buyers and tenants that these particulars are a guide and act as information only. All our details are given in good faith and believed to be correct at the time of printing but they don't form part of an offer or contract. No Winkworth employee has authority to make or give any representation or warranty in relation to this property. All fixtures and fittings, whether fitted or not are deemed removable by the vendor unless stated otherwise and room sizes are measured between internal wall surfaces, including furnishings.