



**WARFIELD YARD, LONDON, NW10**  
**£1,500 PER MONTH UNFURNISHED**

## **FIRST FLOOR ONE BEDROOM APARTMENT LOCATED IN GATED MEWS.**

**Kensal Rise & Queens Park | 0208 960 4947 | [kensalrise@winkworth.co.uk](mailto:kensalrise@winkworth.co.uk)**

**Winkworth**

**for every step...**

*[winkworth.co.uk](http://winkworth.co.uk)*



## DESCRIPTION:

Warfield Yard!

This apartment is set on the first floor, through a gated entrance you walk down a cobbled road and into Warfield Yard. The courtyard is surrounded by other residential homes and offers a community feel.

The apartment is located up a flight of external steps and through a shared entrance door. Comprising of an open-plan kitchen reception, double bedroom with built in storage, separate bathroom and newly fitted appliances.

Unfortunately no parking is available with this apartment

Offered unfurnished and available 16/08/25



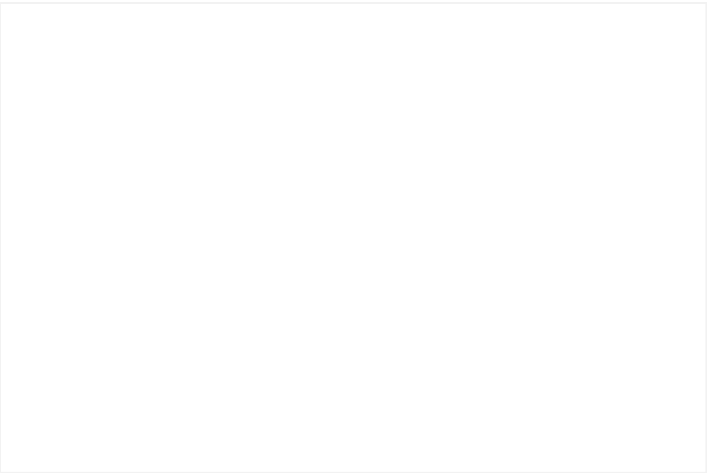
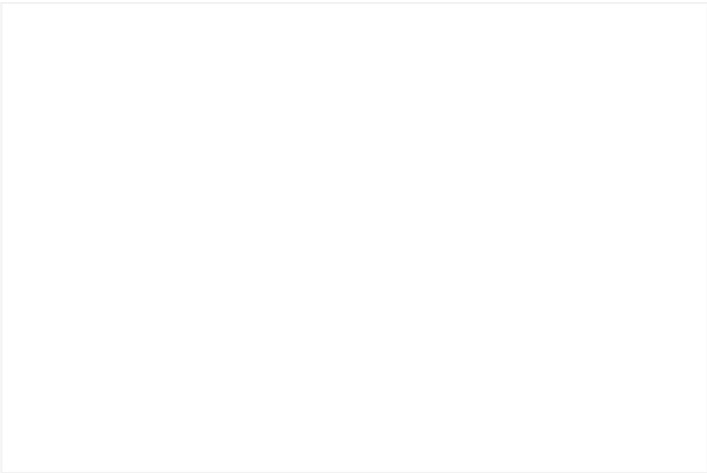

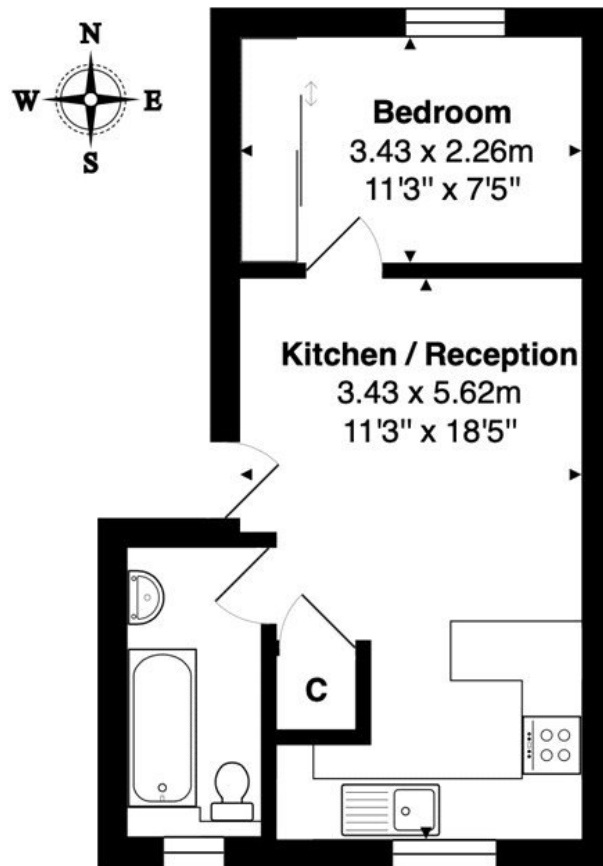

## 1st Floor

**Total Area: 30.8 m<sup>2</sup> ... 332 ft<sup>2</sup>**

All measurements are approximate and for display purposes only

This floorplan is for illustration purposes only and is not to scale. The position and size of doors, windows, appliances and other features are approximate.

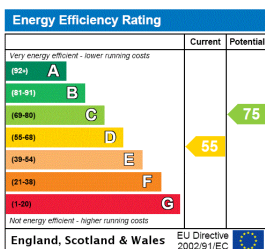

**Deposit:** 5 weeks rent

**Holding Deposit:** 1 weeks rent

**Council Tax Band:** C

Where no figures are shown, we have been unable to ascertain the information. All figures that are shown were correct at the time of printing.

**Winkworth**

Kensal Rise & Queens Park | 0208 960 4947 | kensalrise@winkworth.co.uk

for every step...

[winkworth.co.uk](http://winkworth.co.uk)

Winkworth wishes to inform prospective buyers and tenants that these particulars are a guide and act as information only. All our details are given in good faith and believed to be correct at the time of printing but they don't form part of an offer or contract. No Winkworth employee has authority to make or give any representation or warranty in relation to this property. All fixtures and fittings, whether fitted or not are deemed removable by the vendor unless stated otherwise and room sizes are measured between internal wall surfaces, including furnishings.