

A photograph of a row of red brick townhouses. The building features multiple stories with white-framed windows and decorative balconies with black metal railings. The central entrance is highlighted by a white door and steps. The overall style is classic and elegant.

EGERTON GARDENS | SW3

Winkworth



Egerton Gardens SW3

RENT: £623pw / £2,700pcm

- Two Bedrooms
- One Bathroom
- One Reception room
- Resident Parking
- Period Building

LOCAL AUTHORITY: Royal Borough of Kensington & Chelsea

COUNCIL TAX BAND: Band F

Gross Internal Area: 59 Sq. metres
637 Sq. feet

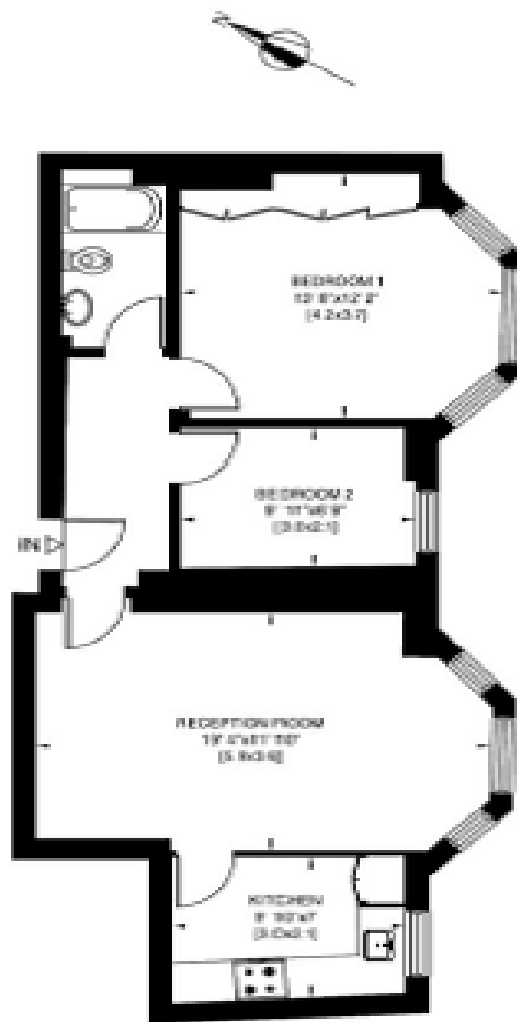

LOWER GROUND FLOOR

Energy Efficiency Rating		
	Current	Potential
Very energy efficient - lower running costs		
(92+) A		
(81-91) B		
(69-80) C		77
(55-68) D	62	
(39-54) E		
(21-38) F		
(1-20) G		
Not energy efficient - higher running costs		
England, Scotland & Wales	EU Directive 2002/91/EC	

Knightsbridge & Chelsea | 020 7589 6616
knightsbridge@winkworth.co.uk



for every step...

winkworth.co.uk

Winkworth wishes to inform prospective buyers and tenants that these particulars are a guide and act as information only. All our details are given in good faith and believed to be correct at the time of printing but they don't form part of an offer or contract. No Winkworth employee has authority to make or give any representation or warranty in relation to this property. All fixtures and fittings, whether fitted or not are deemed removable by the vendor unless stated otherwise and room sizes are measured between internal wall surfaces, including furnishings.