



FLAT 4, SETTLES STREET, LONDON, E1
£555 PER WEEK

**A WELL PRESENTED SPACIOUS THREE
DOUBLE BEDROOM APARTMENT CLOSE TO
ALDGATE EAST UNDERGROUND.**

Shoreditch | 020 7749 7650 | shoreditch@winkworth.co.uk



Tenant Fees Apply: Details of fees for tenant referencing, tenancy agreement admin fees and renewal fees are available on the Winkworth website and the link can be found with the displayed rent for the property. Tenants should ensure they are fully conversant with these upfront fees and other costs that are involved at the outset of the tenancy before making an offer to rent and your local Winkworth office will provide written details upon request.

winkworth.co.uk

See things differently



DESCRIPTION:

An outstanding split level three double bedroom apartment ideal for sharers. The property comprises a large living space with tasteful decoration, separate fitted kitchen, bathroom with luxury shower and upstairs three spacious double bedrooms with plenty of storage space. The property is a short distance to both Aldgate East and Whitechapel train stations providing excellent transport links. Offered furnished. Video available upon request.

Winkworth



Winkworth

Settles Street, E1

Approx. Gross Internal Floor Area 755 sq. ft / 70.15 sq. m (Including Restricted Height Area)
Approx. Gross Internal Floor Area 720 sq. ft / 66.90 sq. m (Excluding Restricted Height Area)

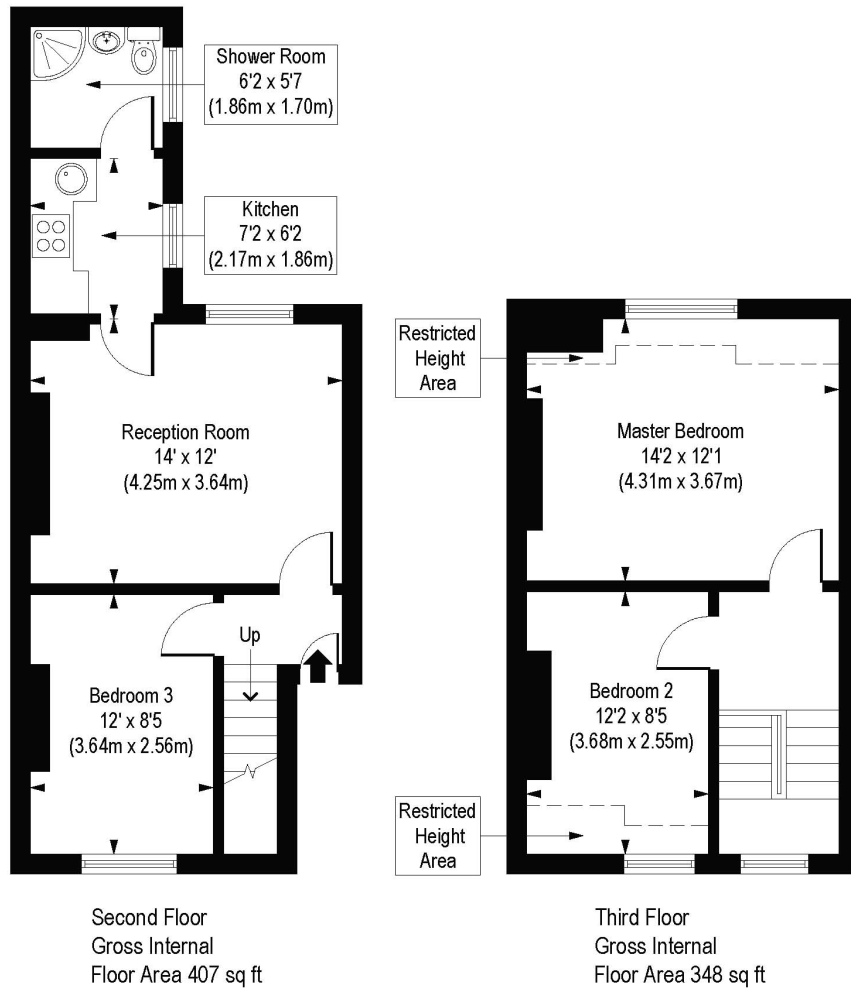

COMPLIANT WITH RICS CODE OF MEASURING PRACTICE. Floorplan is for illustrative purposes only and is not to scale. Every attempt has been made to ensure the accuracy of the floorplan shown, however all measurements, fixtures, fittings and data shown are an approximate interpretation for illustrative purposes only. Liability for errors, omissions or mis-statement through negligence or otherwise, is hereby excluded.

This floorplan is for illustration purposes only and is not to scale. The position and size of doors, windows, appliances, and other features are approximate.

Shoreditch | 020 7749 7650 | shoreditch@winkworth.co.uk

Winkworth

winkworth.co.uk

See things differently

Winkworth wishes to inform prospective buyers and tenants that these particulars are a guide and act as information only. All our details are given in good faith and believed to be correct at the time of printing but they don't form part of an offer or contract. No Winkworth employee has authority to make or give any representation or warranty in relation to this property. All fixtures and fittings, whether fitted or not are deemed removable by the vendor unless stated otherwise and room sizes are measured between internal wall surfaces, including furnishings.