



Arthur Road, Winchester, SO23

Winkworth





Arthur Road, Winchester, SO23

## Charming Period First Floor Apartment in Popular Hyde

This attractive and appealing, period, first-floor apartment is well-presented throughout. The apartment is situated in the popular Hyde area, just moments from River Park and just a short walking distance to Winchester High Street.

The apartment features a spacious and light sitting room, with large, shuttered bay windows to the front. The fireplace is flanked by alcove bookshelves, with storage underneath and complemented by the laminate wooden flooring. A separate, beautifully fitted kitchen offers ample base and drawer units with integrated appliances including oven, hob, fridge-freezer, washing machine and dishwasher, and larder cupboard to one side and a lovely natural stone tile covered floor.

The main double bedroom is a wonderful bright space, with a built-in wardrobe, shuttered bay windows with a lovely window seat with added storage. The second double bedroom also offers a built-in wardrobe with shutters to the window. Both are served by the bathroom which has a classic, white suite with mains shower over the bath and features electric underfloor heating and tongue and groove panelling.

The apartment benefits from allocated parking for one car, a visitor parking space and on street permit parking. There is also a communal garden with BBQ area and garden shed.







## Arthur Road, Winchester, SO23

### Directions

From our offices in Southgate Street, turn right at the lights and follow the road round to the left onto Jewry Street. At the next set of lights go straight over into Hyde Street. At the T-junction go right onto Worthy Lane (B3045) then take the next right into Arthur Road.

### Location

Arthur Road is situated in the sought-after area of Hyde and is superbly positioned for easy access to the mainline railway station (links to London Waterloo in approximately 55 minutes), and city with its high street shops, boutiques, library, coffee shops, public houses, restaurants, theatre, cinema, museums and, of course, the city's historic cathedral. The house is situated in the catchment for good local schools, namely St Bede Primary and Westgate Secondary. The road itself is very desirable, being populated with some of the more substantial period houses available to Winchester buyers.

### Tenure

Share of Freehold

### Services

Mains gas, electricity, water and drainage

### Council tax band

B

### Local Authority

Winchester City Council

### EPC rating

E

### Viewings

Strictly by appointment with Winkworth Winchester Office

[Winkworth.co.uk/winchester](http://Winkworth.co.uk/winchester)

## Arthur House

Approximate Gross Internal Area  
Total = 668 Sq Ft / 62.01 Sq M

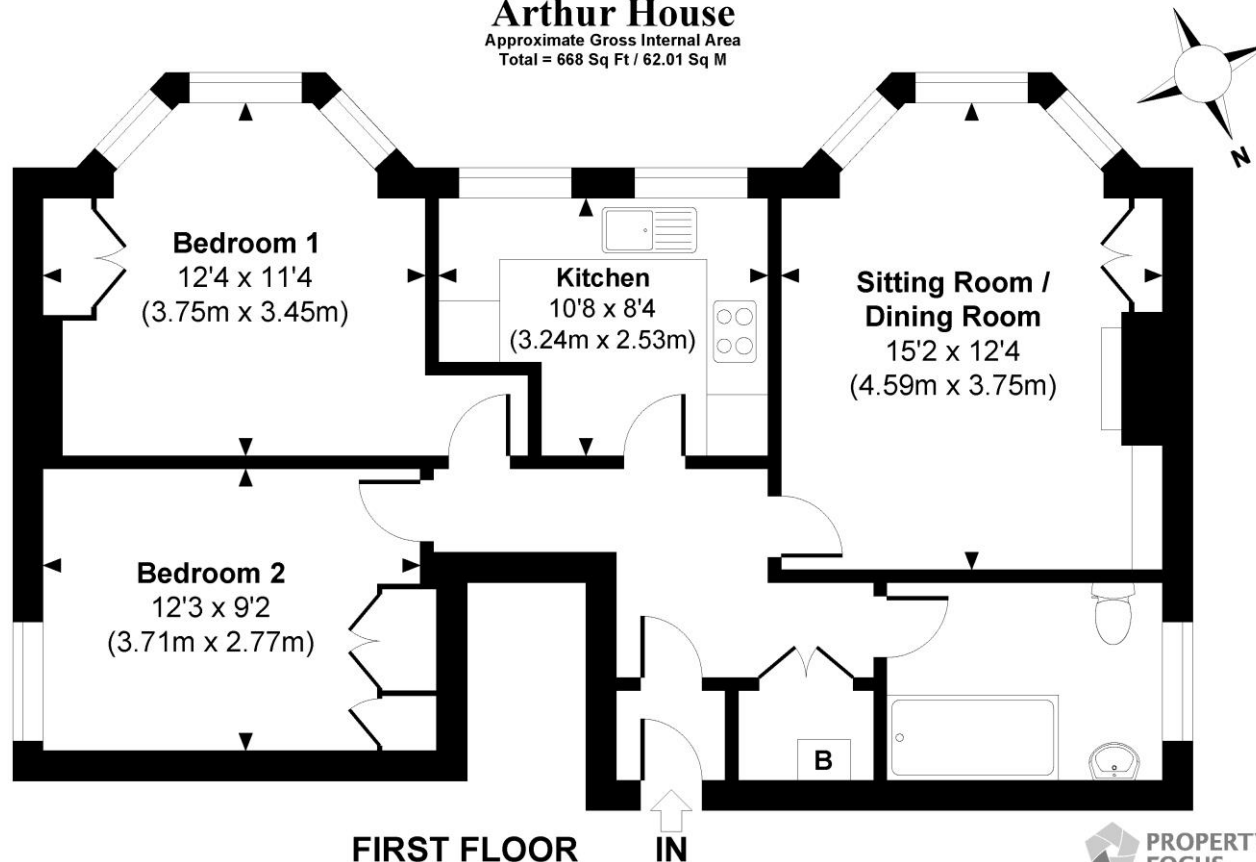

© www.propertyfocus.co | Professional Property Photography & Floorplans

This plan is for illustrative purposes only and is not to scale. If specified, the Gross Internal Area (GIA), dimensions, North point orientation and the size and placement of features are approximate and should not be relied on as a statement of fact. No guarantee is given for the GIA and no responsibility is taken for any error, omission or misrepresentation.

### Winkworth Winchester

2 Black Swan Buildings, Southgate Street, Winchester, SO23 9DT  
01962 866 777 | [winchester@winkworth.co.uk](mailto:winchester@winkworth.co.uk)

### Winkworth Country House Department

11 Berkeley Street, Mayfair, London, W1J 8DS  
020 7871 0589 | [countryhouse@winkworth.co.uk](mailto:countryhouse@winkworth.co.uk)

**Winkworth**

See things differently