



MOLYNEUX DRIVE, SW17
OIEO £300,000 SHARE OF FREEHOLD

A GROUND FLOOR ONE BEDROOM FLAT.

Tooting | 020 8767 5221 | tooting@winkworth.co.uk

Winkworth

for every step...

winkworth.co.uk



DESCRIPTION:

This ground-floor flat features a spacious double bedroom, a kitchen conveniently located off the bright reception room, and a bathroom. The property also benefits from double glazing.

Molyneux Drive in SW17, Tooting, is a quiet residential street with excellent transport links via Tooting Broadway and Tooting Bec stations on the Northern Line. Close to vibrant amenities like Tooting Market, trendy cafes, and diverse restaurants, it also offers easy access to the green spaces of Tooting Common. Combining suburban charm with urban convenience, it's a sought-after spot for families and professionals.

Wandsworth Council Tax Band C

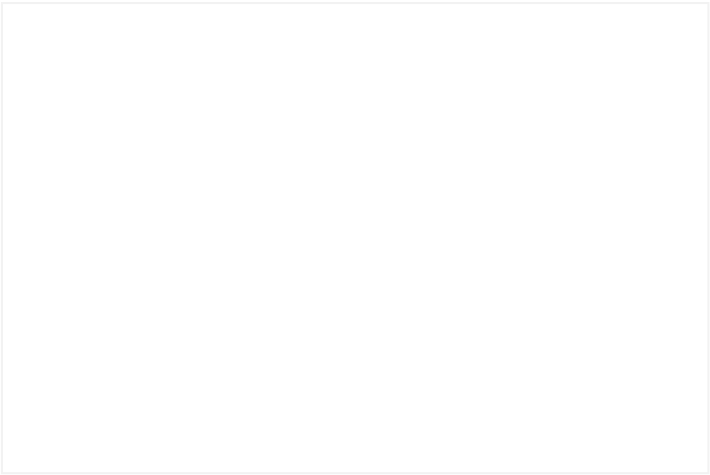
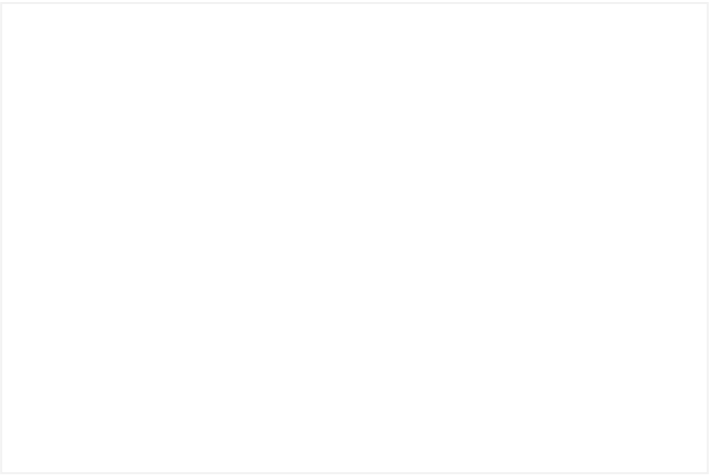

Molyneux Drive, SW17

Approx. Gross Internal Floor Area 416 sq. ft / 38.67 sq. m

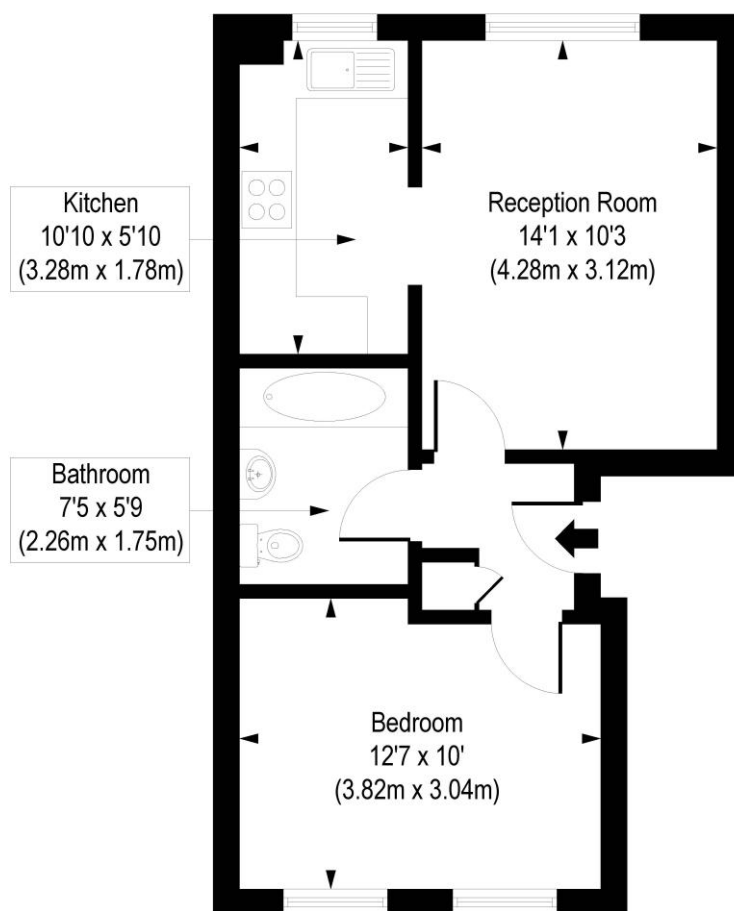

Ground Floor

COMPLIANT WITH RICS CODE OF MEASURING PRACTICE. Floorplan is for illustrative purposes only and is not to scale. Every attempt has been made to ensure the accuracy of the floorplan shown, however all measurements, fixtures, fittings and data shown are an approximate interpretation for illustrative purposes only. Liability for errors, omissions or mis-statement through negligence or otherwise is hereby excluded.

This floorplan is for illustration purposes only and is not to scale. The position and size of doors, windows, appliances and other features are approximate.

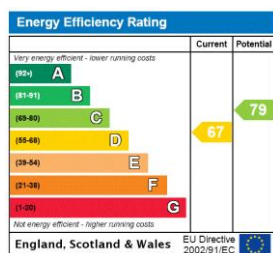

Tooting | 020 8767 5221 | tooting@winkworth.co.uk

Winkworth

for every step...

winkworth.co.uk

Winkworth wishes to inform prospective buyers and tenants that these particulars are a guide and act as information only. All our details are given in good faith and believed to be correct at the time of printing but they don't form part of an offer or contract. No Winkworth employee has authority to make or give any representation or warranty in relation to this property. All fixtures and fittings, whether fitted or not are deemed removable by the vendor unless stated otherwise and room sizes are measured between internal wall surfaces, including furnishings.