



4E THE WORKS, BIRD IN HAND MEWS, LONDON, SE23
£220,000 LEASEHOLD

STYLISH WAREHOUSE-STYLE STUDIO IN THE HEART OF FOREST HILL.

Forest Hill | | foresthill@winkworth.co.uk



DESCRIPTION:

Set within a unique conversion, this spacious studio offers character, a generous layout, and a modern shower room.





The Works, Bird In Hand Mews, London, SE23

Approximate Area = 305 sq ft / 28.3 sq m
For identification only - Not to scale

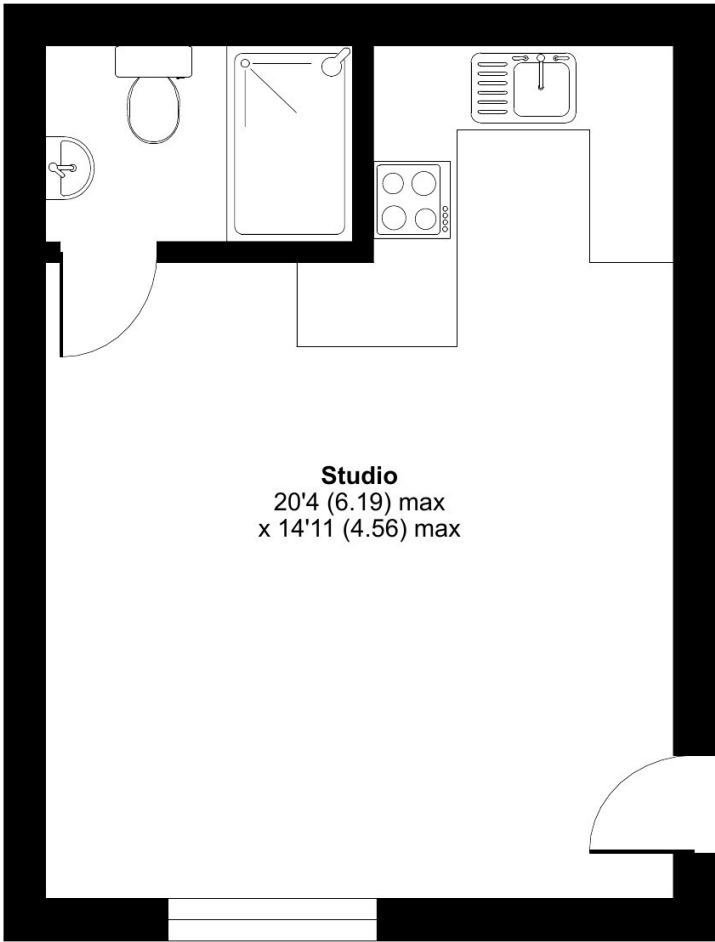

GROUND FLOOR



Floor plan produced in accordance with RICS Property Measurement Standards incorporating International Property Measurement Standards (IPMS2 Residential). © nlc|ecom 2025.
Produced for Winkworth Forest Hill and New Cross. REF: 1289148

This floorplan is for illustration purposes only and is not to scale. The position and size of doors, windows, appliances and other features are approximate.

Score	Energy rating	Current	Potential
92+	A		
81-91	B		
69-80	C		77 C
55-68	D	65 D	
39-54	E		
21-38	F		
1-20	G		

Tenure: Leasehold