



SIENNA ALTO, 2 CORNMILL LANE, LEWISHAM, SE13 7GG
£425,000 LEASEHOLD

A STYLISH TWO DOUBLE BEDROOM, TWO BATHROOM, APARTMENT WITH A TERRACE. FOUND ON THE FOURTH FLOOR OF THE SOUGHT AFTER RENAISSANCE DEVELOPMENT VERY CLOSE TO LEWISHAM STATION AND DLR.

Blackheath | 0208 8520999 | blackheath@winkworth.co.uk

Winkworth

DESCRIPTION:

A stylish two double bedroom, two bathroom, apartment with a terrace. Found on the fourth floor of the sought after Renaissance development very close to Lewisham Station and DLR.

The property is located on the fourth floor, (with a lift,) and is in excellent decorative order throughout. The accommodation briefly comprises; a spacious open plan lounge diner with a very attractive modern kitchen with integrated appliances. A good size master bedroom with built in wardrobes and an attractive ensuite shower room, a second double bedroom and a modern bathroom. There is also utility cupboard and a private terrace from the living room. Residents also benefit from 24 hour concierge service and a communal roof terrace with superb views.

The property is sold chain free and your immediate viewing is essential.

The property is located in a very convenient location very close to Lewisham Station, (Zone 2), and the DLR and just a short walk to the town and shopping centre with the popular Blackheath and Greenwich close by.

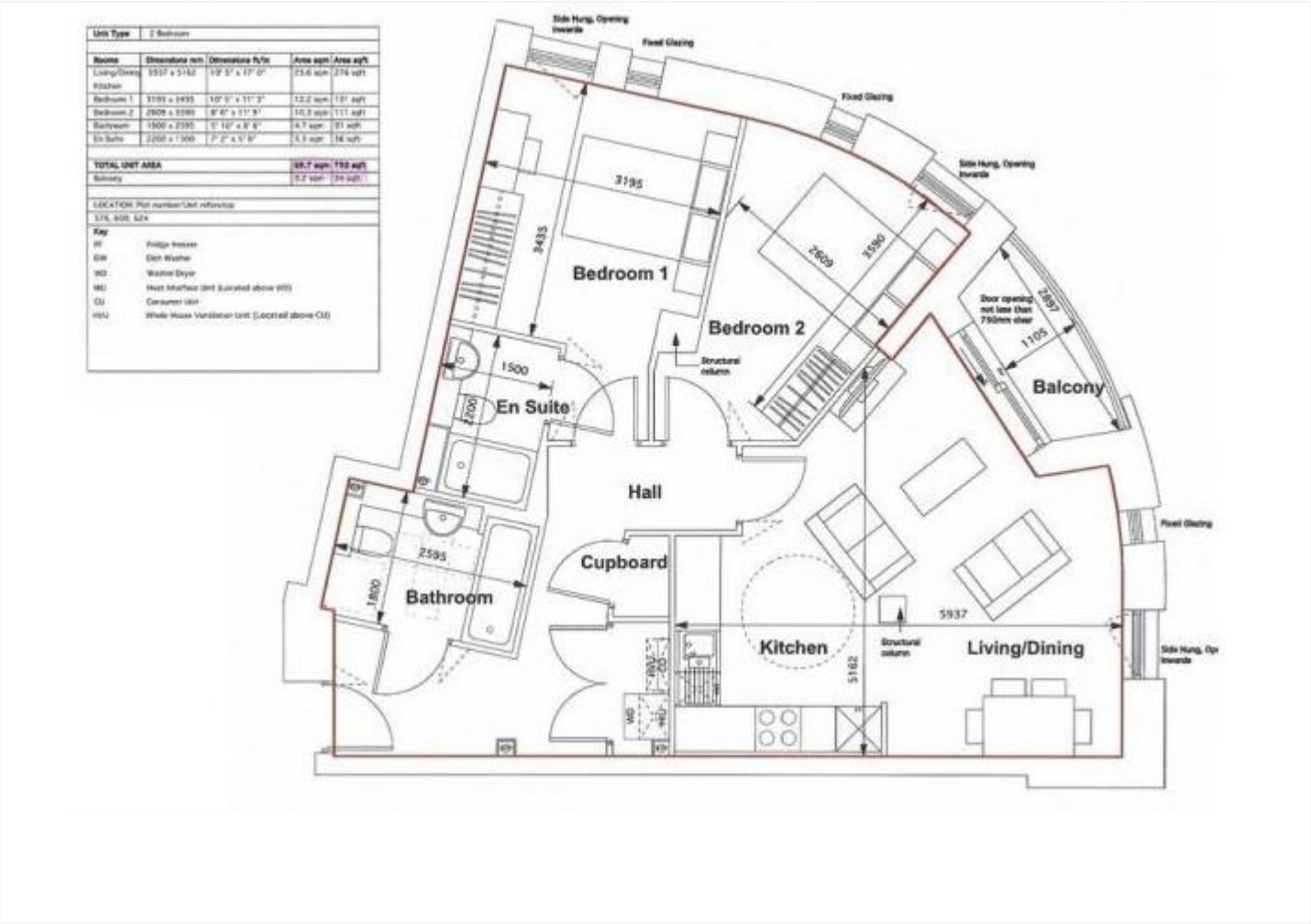

This floorplan is for illustration purposes only and is not to scale. The position and size of doors, windows, appliances and other features are approximate.

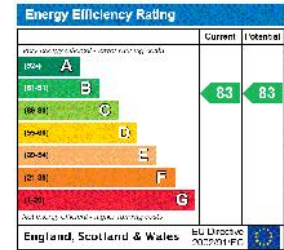

Blackheath | 0208 8520999 | blackheath@winkworth.co.uk

