



CRUIKSHANK STREET, WC1X
£420,000 LEASEHOLD

A ONE BEDROOM PERIOD CONVERSION, IN AN EARLY VICTORIAN TERRACED HOUSE SET WITHIN THE FINSBURY CONSERVATION AREA ON CRUIKSHANK STREET.

Clerkenwell | 020 7405 1288 | clerkenwell@winkworth.co.uk

Winkworth

for every step...

winkworth.co.uk



DESCRIPTION:

The property is well presented and comprises an open plan reception with modern fitted kitchen, wood floors, original panelling and sash windows, double bedroom and modern fitted bathroom. The property benefits from use of a large communal garden.

Cruikshank Street is within a five-minute walk to the transport links of Kings Cross, Farringdon (impending Crossrail) and Angel. The property is close to Percy Circus, Great Percy Street, Amwell Street and Myddelton Square. Bars, cafes, restaurants and boutiques are found on Amwell Street, Upper Street and Exmouth Market.



Winkworth

for every step...



Winkworth

for every step...

Cruikshank Street, WC1X

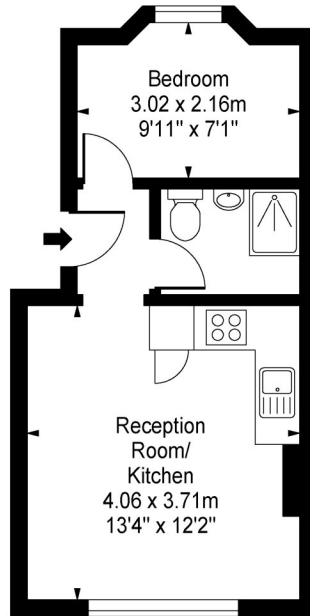

Ground Floor

Approx Gross Internal Area 284 Sq Ft - 26.38 Sq M

This floor plan should be used as a general outline for guidance only and constitute in whole or in part an offer or contract. Any intending purchaser or lessee should satisfy themselves by inspection, searches, enquiries and full survey as to the correctness of each statement. Any areas, measurements or distances quoted are approximate and should not be used to value a property or be the basis of any sale or let.

This floorplan is for illustration purposes only and is not to scale. The position and size of doors, windows, appliances and other features are approximate.

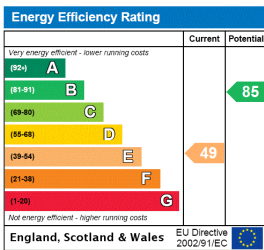

Winkworth

Clerkenwell | 020 7405 1288 | clerkenwell@winkworth.co.uk

for every step...

winkworth.co.uk

Winkworth wishes to inform prospective buyers and tenants that these particulars are a guide and act as information only. All our details are given in good faith and believed to be correct at the time of printing but they don't form part of an offer or contract. No Winkworth employee has authority to make or give any representation or warranty in relation to this property. All fixtures and fittings, whether fitted or not are deemed removable by the vendor unless stated otherwise and room sizes are measured between internal wall surfaces, including furnishings.