



9 Mercer Way, Romsey, Hampshire SO51 7PH

Winkworth



THREE BEDROOM FAMILY HOME IN ESTABLISHED RESIDENTIAL AREA

9 Mercer Way is a three-bedroom end of terrace property located in a sought-after residential area and within close proximity of sought after schools. The property is within easy reach of Romsey's amenities including the town centre with its variety of shops, banks and restaurants. Access to the M3 and M27 motorway's is close at hand, which in turn provides access to Bournemouth and the New Forest to the West and Southampton, Eastleigh, Fareham and Portsmouth to the East. Romsey also has a local railway station connecting with mainline services to London.

This three-bedroom family home is ideally situated on the outskirts of Romsey and offers an excellent opportunity for buyers looking to personalise a property, with modernisation required throughout. Upon entering, a hallway provides access to the principal ground floor rooms. The kitchen/dining room is a good size and overlooks the front elevation. To the rear and overlooking the garden is a sizeable sitting room. Upstairs, you will find three bedrooms, bedroom 1 benefits from built in wardrobes. All bedrooms have use of the family bathroom. 9 Mercer Way is the perfect property for first-time buyers or for those wishing to move up the property ladder.

To the front of the property is off-road parking, the courtyard style garden to the rear is fully paved making it very low maintenance and is fully enclosed.

The property is offered with no onward chain.

- Mains Utilities
- EPC 'TBC'
- Council tax Band 'B' Test valley Borough Council
- Ultrafast Broadband



Winkworth

**Address: 9 Mercer Way, Romsey
SO51 7PH**

**Council Tax Band: 'B' Test Valley
Borough Council
EPC: 'TBC'
Tenure: Freehold**



Ground Floor

Approx. 41.3 sq. metres (444.9 sq. feet)

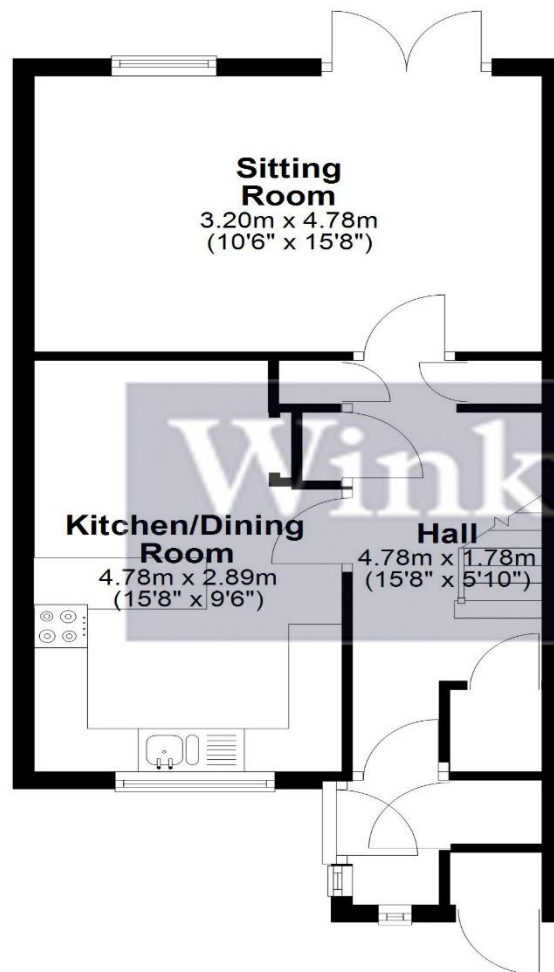

First Floor

Approx. 38.7 sq. metres (416.2 sq. feet)

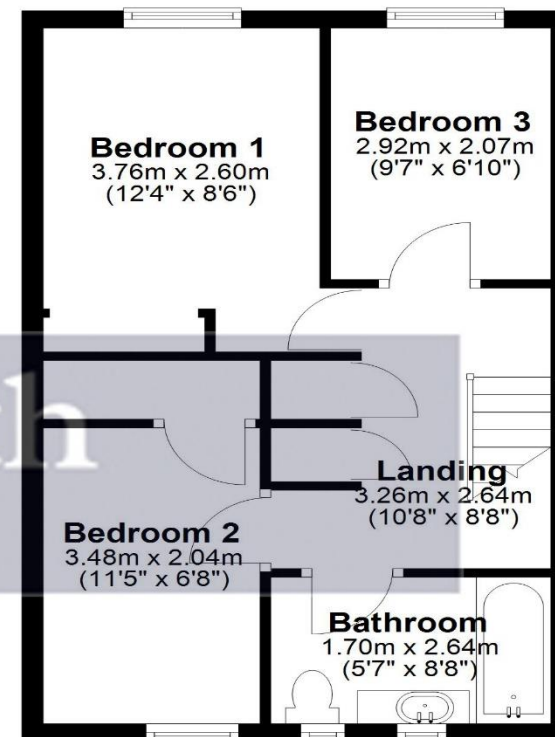

Total area: approx. 80.0 sq. metres (861.1 sq. feet)

SIZES AND DIMENSIONS ARE APPROXIMATE, ACTUAL MAY VARY
Copywrite Ellie Mathieson Photography
Plan produced using PlanUp.

winkworth.co.uk/romsey

winkworth Romsey

18 Market Place, Romsey, Hampshire, SO51 8NA
01794 511911 | romsey@winkworth.co.uk

winkworth.co.uk/romsey

winkworth Winchester

2 Black Swan Buildings, Southgate Street,
Winchester, Hampshire, SO23 9DT
01962 866777 | winchester@winkworth.co.uk

winkworth Mayfair & Country House Department

11 Berkeley Street, Mayfair, London, W1J 8DS
020 7871 0589 | countryhouse@winkworth.co.uk

Winkworth

See things differently