



OSPREY HOUSE, READING, BERKSHIRE, RG2 0PR  
**£1,600 PER MONTH UNFURNISHED**

## TWO BEDROOM FOURTH FLOOR APARTMENT ON THE POPULAR KENNET ISLAND DEVELOPMENT

Reading | 0118 4022 300 | [reading@winkworth.co.uk](mailto:reading@winkworth.co.uk)

**Winkworth**

for every step...

[winkworth.co.uk](http://winkworth.co.uk)





## DESCRIPTION:

Two bedroom fourth floor apartment in the popular Kennet Island Development. Conveniently located close to junction 11 of the M4 and Green Park and offering excellent access in to Reading Town Centre with regular bus services and cycle routes. Accommodation comprises open plan living room / kitchen with integrated appliances, two double bedrooms, en suite shower room and a further three piece bathroom. The property benefits from a large private balcony, lift access and an allocated parking space. Available now. Unfurnished.

## AT A GLANCE

- Fourth Floor (with lift access)
- Two Double Bedrooms
- Two Bathrooms
- Private Balcony
- Council tax band C
- Allocated Parking Space
- Available now
- Unfurnished







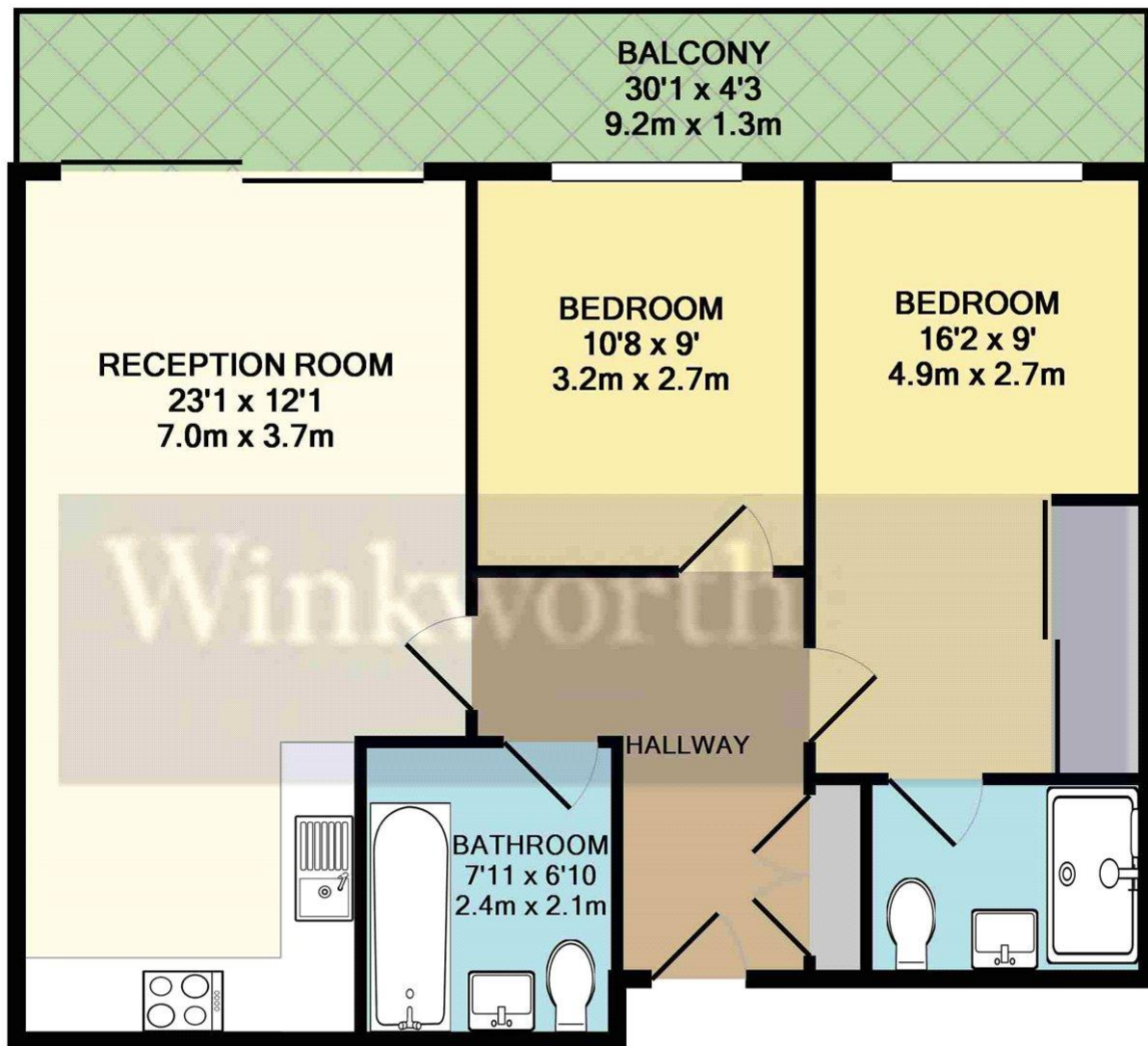

TOTAL APPROX. FLOOR AREA 672 SQ.FT. (62.4 SQ.M.)

Whilst every attempt has been made to ensure the accuracy of the floor plan contained here, measurements of doors, windows, rooms and any other items are approximate and no responsibility is taken for any error, omission, or mis-statement. This plan is for illustrative purposes only and should be used as such by any prospective purchaser. The services, systems and appliances shown have not been tested and no guarantee as to their operability or efficiency can be given

Made with Metropix ©2017

This floorplan is for illustration purposes only and is not to scale. The position and size of doors, windows, appliances and other features are approximate.

**Deposit:** £1,846.15

**Holding Deposit:** £369.23

**Council Tax Band:** C

Where no figures are shown, we have been unable to ascertain the information. All figures that are shown were correct at the time of printing.

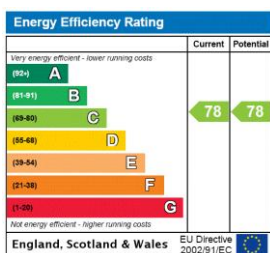

Reading | 0118 4022 300 | [reading@winkworth.co.uk](mailto:reading@winkworth.co.uk)

**Winkworth**

for every step...

[winkworth.co.uk](http://winkworth.co.uk)

Winkworth wishes to inform prospective buyers and tenants that these particulars are a guide and act as information only. All our details are given in good faith and believed to be correct at the time of printing but they don't form part of an offer or contract. No Winkworth employee has authority to make or give any representation or warranty in relation to this property. All fixtures and fittings, whether fitted or not are deemed removable by the vendor unless stated otherwise and room sizes are measured between internal wall surfaces, including furnishings.