



WALCOT TERRACE, SOMERSET, BA1
£1,350PER MONTH FURNISHED

Bath | 01225 829 000 | bath@winkworth.co.uk



SUMMARY:

Furnished, move in ready, 1-bed apartment close to local amenities and Bath City Centre.

ACCOMMODATION

1 Bedrooms, 1 Reception Rooms, 1 Bathrooms,
Flat/Apartment, Upper Floor without Lift, Period,
Town/City, Furnished



3 Walcot Terrace, Bath BA1 6AB
Total Approx. Floor Area
40.3 sq m / 434 sq ft

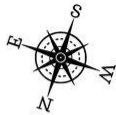
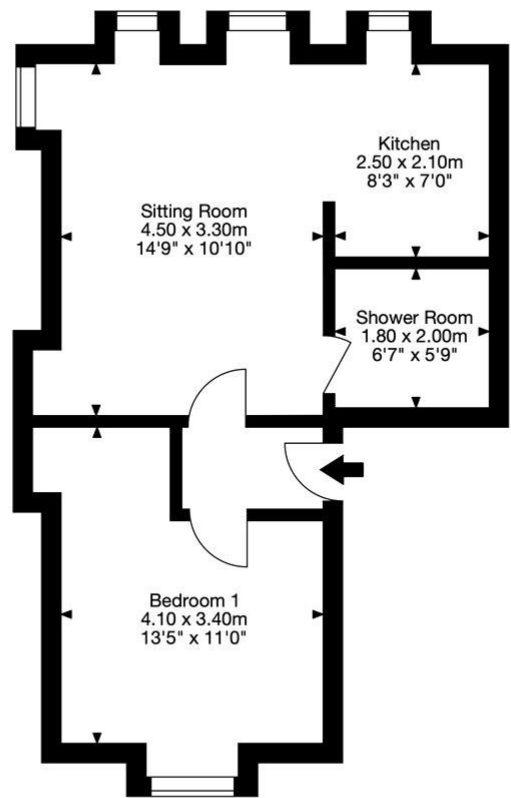

Capture.
Capture Property Marketing 2023. Drawn to RICS guidelines.
All Measurements are approximate and should not be relied on as a statement of fact.
Plan is for illustration purposes only. Not drawn to scale.

This floorplan is for illustration purposes only and is not to scale. The position and size of doors, windows, appliances and other features are approximate.

