



THE VISTA BUILDING, WOOLWICH, LONDON, SE18
£1,575 PER MONTH UNFURNISHED

DESCRIPTION:

Perfectly located in the heart of Woolwich! We are pleased to offer this well presented one bedroom apartment found on the 6th floor of this modern block. Offered unfurnished and available from 30th October 2025, your earliest viewing is advised.

Blackheath | 0208 8520999 | blackheath@winkworth.co.uk

Sixth Floor

Approx. 39.7 sq. metres (427.5 sq. feet)

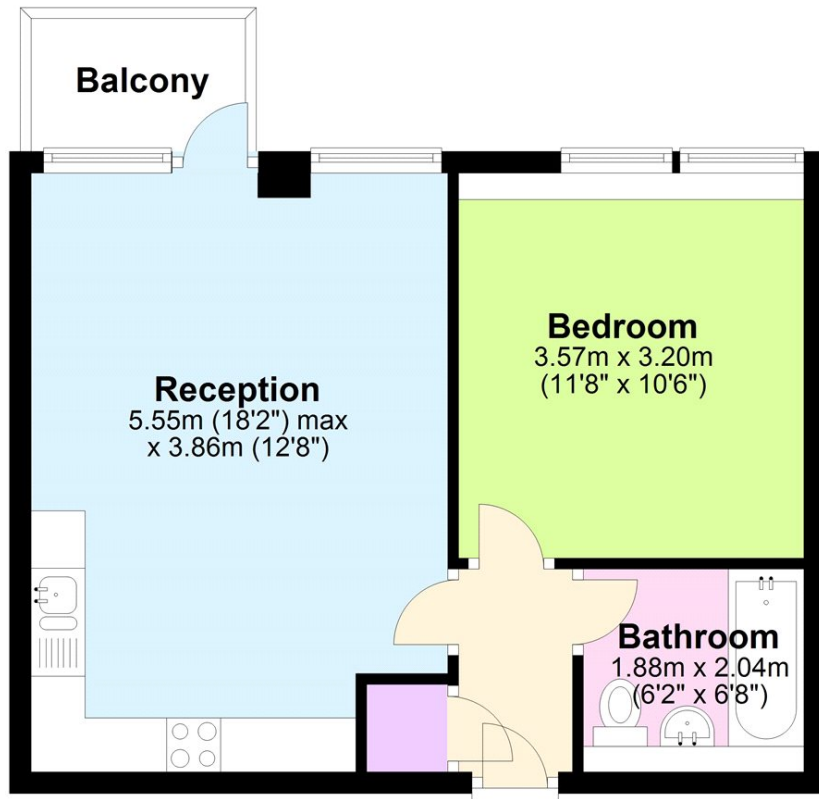

Total area: approx. 39.7 sq. metres (427.5 sq. feet)

This floorplan is for illustration purposes only and is not to scale. The position and size of doors, windows, appliances and other features are approximate.

Energy Efficiency Rating		
	Current	Potential
Very energy efficient - lower running costs		
(92+) A		81
(81-91) B		
(69-80) C		
(55-68) D	64	
(39-54) E		
(21-38) F		
(1-20) G		
Not energy efficient - higher running costs		
England, Scotland & Wales		EU Directive 2002/91/EC

Deposit: £1,817.31

Holding Deposit:

Council Tax Band:

Where no figures are shown, we have been unable to ascertain the information.
All figures that are shown were correct at the time of printing.