



RUSTON MEWS, W11
£1,900 PER MONTH

Winkworth



RUSTON MEWS, W11

Spacious One-Bedroom Apartment in the Heart of W10 – Fully Renovated

This beautifully renovated one-bedroom apartment offers stylish, modern living in one of West London's most vibrant neighbourhoods. Located in the heart of W10, just moments from Ladbroke Grove Underground Station, the property provides excellent transport links across London.

Finished to a high specification throughout, the apartment features a generously sized lounge and dining area, a sleek separate kitchen, a bright and airy double bedroom, and a contemporary bathroom. The interiors have been tastefully decorated, combining modern finishes with a welcoming atmosphere.

Set in the cultural hotspot of Ladbroke Grove, this location offers the best of Notting Hill living — from eclectic restaurants and artisan coffee shops to vintage stores and the iconic Portobello Road Market, all just a short stroll away.





Cervantes Court

Approx. Gross Internal Area 473 Sq Ft - 43.94 Sq M

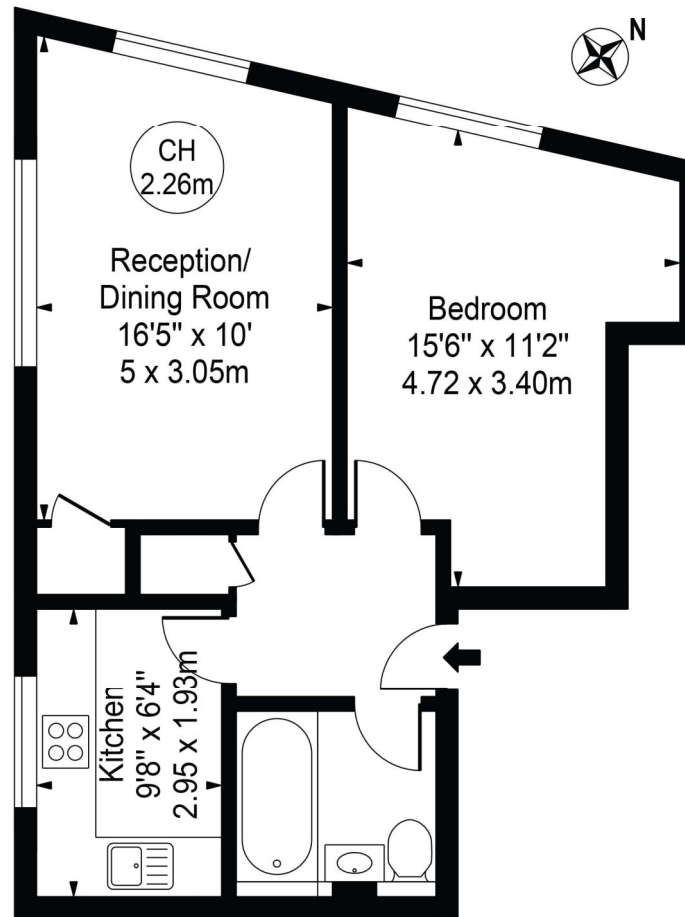

Second Floor

For Illustration Purposes Only - Not To Scale

This floor plan should be used as a general outline for guidance only and does not constitute in whole or in part an offer or contract. Any intending purchaser or lessee should satisfy themselves by inspection, searches, enquiries and full survey as to the correctness of each statement. Any areas, measurements or distances quoted are approximate and should not be used to value a property or be the basis of any sale or let.

Copyright Morriarti Photography & Design LTD

Energy Efficiency Rating		
	Current	Potential
Very energy efficient - lower running costs		
(92-100) A		
(81-91) B		
(69-80) C	77	77
(55-68) D		
(39-54) E		
(21-38) F		
(1-20) G		
Not energy efficient - higher running costs		
England, Scotland & Wales EU Directive 2002/91/EC		

North Kensington | 020 7792 5000 | northkensington@winkworth.co.uk

winkworth.co.uk

Winkworth wishes to inform prospective buyers and tenants that these particulars are a guide and act as information only. All our details are given in good faith and believed to be correct at the time of printing but they don't form part of an offer or contract. No Winkworth employee has authority to make or give any representation or warranty in relation to this property. All fixtures and fittings, whether fitted or not are deemed removable by the vendor unless stated otherwise and room sizes are measured between internal wall surfaces, including furnishings.

Winkworth