



Edison House

16-18 Winchester Road Basingstoke RG21 8UQ

Description

This first floor apartment is set within a 'Gated Development' on the edge of Basingstoke's Old Town Centre, conveniently situated for the Festival Place shopping centre and the mainline railway station (with its excellent service into London Waterloo).

The apartment has a smart open plan layout with a well equipped kitchen incorporating built-in appliances and high gloss finish units. The shower room has a white suite with contemporary wall tiling.

There is a lift within the block and there is an allocated parking space to the rear.



Winkworth

Accommodation

Entrance hall
 Kitchen area
 Living area
 Double bedroom
 Shower room
 Allocated parking space
 No Onward Chain

Under the Property Misdescriptions Act 1991, these Particulars are a guide and act as information only. All details are given in good faith and are believed to be correct at time of printing. Winkworth give no representation as to their accuracy and potential purchasers or tenants must satisfy themselves by inspection or otherwise as to their correctness. No employee of Winkworth has authority to make or give any representation or warranty in relation to this property.

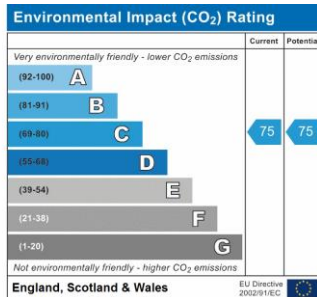
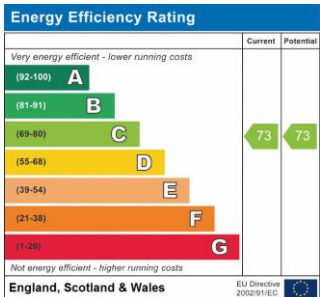
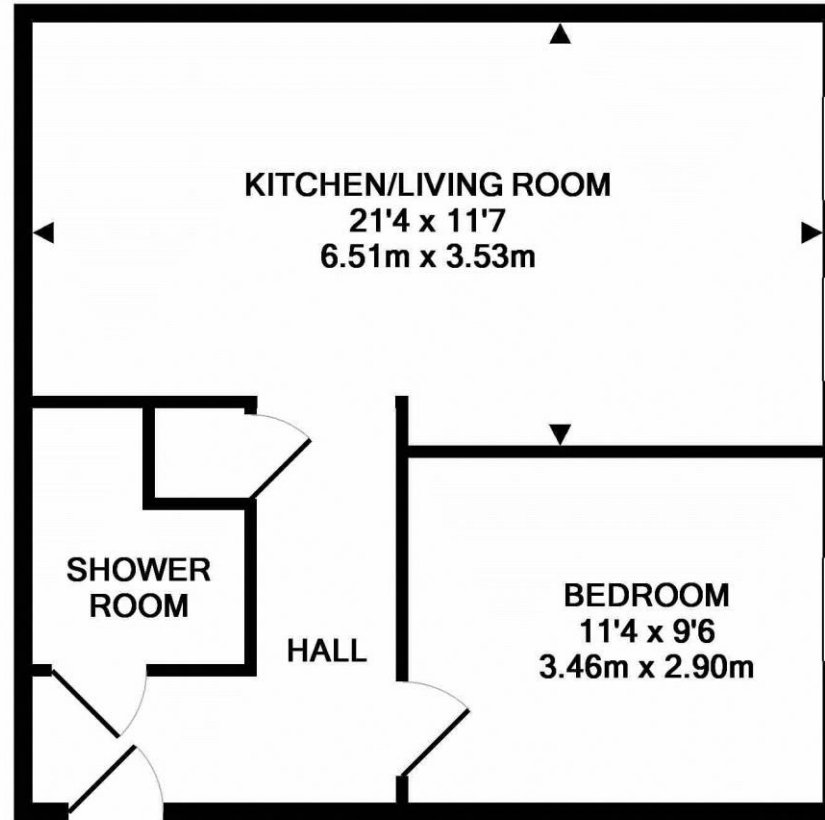

TOTAL APPROX. FLOOR AREA 451 SQ.FT. (41.9 SQ.M.)

Whilst every attempt has been made to ensure the accuracy of the floor plan contained here, measurements of doors, windows, rooms and any other items are approximate and no responsibility is taken for any error, omission, or mis-statement. This plan is for illustrative purposes only and should be used as such by any prospective purchaser. The services, systems and appliances shown have not been tested and no guarantee as to their operability or efficiency can be given
 Made with Metropix ©2018

Basingstoke Office

10B Church Street, Basingstoke, Hampshire, RG21 7QE
 01256 811730 | basingstoke@winkworth.co.uk

winkworth.co.uk/Basingstoke



See things differently.