



BUCHANAN GARDENS, NW10  
**£2,100 PER MONTH PART FURNISHED**

## GROUND FLOOR GARDEN APARTMENT LOCATED IN KENSAL RISE

Kensal Rise & Queens Park | 0208 960 4947 | [kensalrise@winkworth.co.uk](mailto:kensalrise@winkworth.co.uk)

**Winkworth**

for every step...

[winkworth.co.uk](http://winkworth.co.uk)



## DESCRIPTION:

Presenting this spacious ground floor two double bedroom apartment to the lettings market.

Set within a well maintained Victorian building on a sought after residential road in the heart of Kensal Rise, and is but a few minutes walk to the underground station /over ground station at Kensal Green (Zone 2).

Comprising of a spacious bay fronted reception with gorgeous wooden flooring through out, two spacious double bedrooms, modern kitchen, fully fitted bathroom and a private south facing garden.

2025 The furnishing consists of

- Table and 4 chairs
- Double mattress (no bedframe)
- Wardrobe
- Chest of draws
- De-humidifier

Council tax - Band D

Ward - Kensal Green



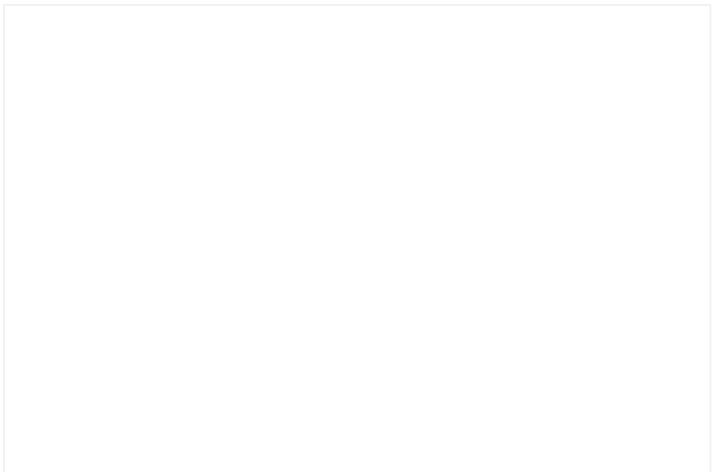
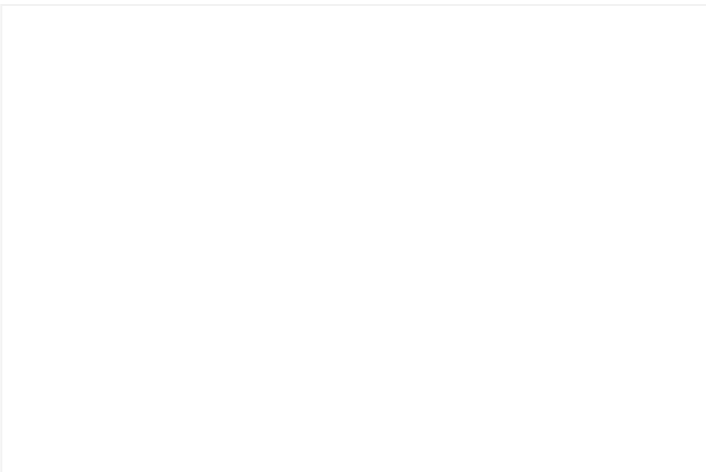

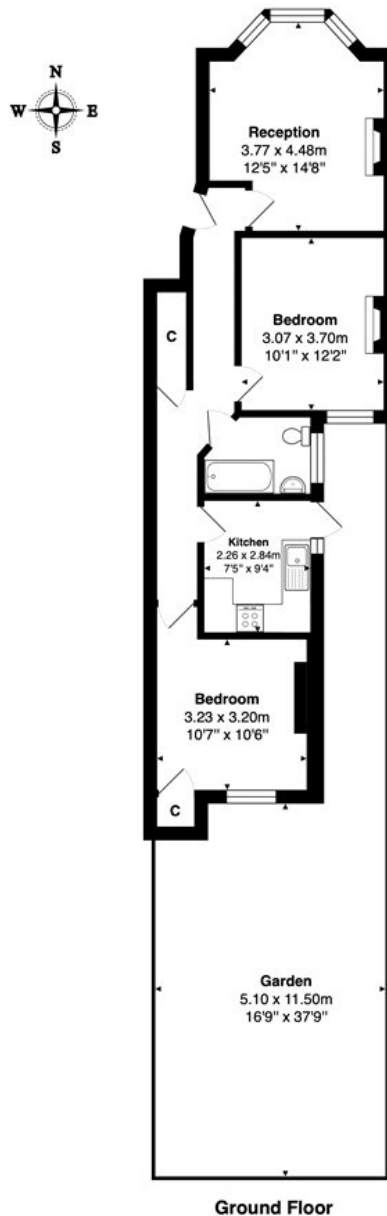

**Total Area: 61.1 m<sup>2</sup> ... 658 ft<sup>2</sup> (excluding garden)**  
All measurements are approximate and for display purposes only

This floorplan is for illustration purposes only and is not to scale. The position and size of doors, windows, appliances and other features are approximate.

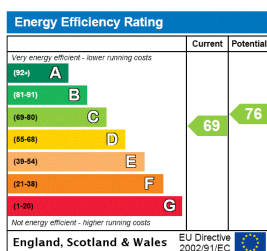

**Deposit:** 5 weeks rent

**Holding Deposit:** 1 weeks rent

**Council Tax Band:** D

Where no figures are shown, we have been unable to ascertain the information. All figures that are shown were correct at the time of printing.

**Winkworth**

Kensal Rise & Queens Park | 0208 960 4947 | kensalrise@winkworth.co.uk

for every step...

[winkworth.co.uk](http://winkworth.co.uk)

Winkworth wishes to inform prospective buyers and tenants that these particulars are a guide and act as information only. All our details are given in good faith and believed to be correct at the time of printing but they don't form part of an offer or contract. No Winkworth employee has authority to make or give any representation or warranty in relation to this property. All fixtures and fittings, whether fitted or not are deemed removable by the vendor unless stated otherwise and room sizes are measured between internal wall surfaces, including furnishings.