



WHITWORTH STREET, GREENWICH, SE10 9EL

£575,000 FREEHOLD

WE ARE DELIGHTED TO OFFER THIS EXTREMELY PRETTY MID TERRACED VICTORIAN COTTAGE, WHICH IS LOCATED ON THIS POPULAR AND QUIET ROAD IN EAST GREENWICH.

Blackheath | 0208 8520999 | blackheath@winkworth.co.uk

Winkworth

for every step...

winkworth.co.uk



DESCRIPTION:

This little gem of a property is in need of refurbishment but does offer the opportunity as a superb project for any buyer! The property briefly comprises a 10ft reception room to the front, with a good sized kitchen breakfast room to the rear. The ground floor also features a good sized bathroom. Upstairs there are two double bedrooms. Additional features include gas central heating and sash windows.

Whitworth Street is quietly nestled just off Trafalgar Road in East Greenwich, just moments from the river walk and is literally seconds from local shops and also mainline Rail and The Royal Park. The town centre is also close by, which offers a fantastic array of shops and restaurants, DLR and riverboat service. Your earliest viewing is recommended.

AT A GLANCE

- Victorian Cottage
- two bedrooms
- mid terrace
- circa 561 sq ft
- 11ft kitchen breakfast room
- one reception
- small paved garden
- quiet road
- very close to shops and rail





Ground Floor

Approx. 27.9 sq. metres (300.8 sq. feet)

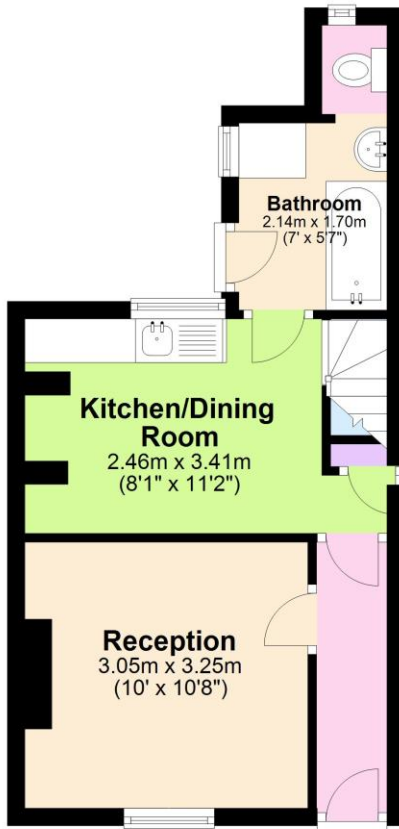

First Floor

Approx. 23.3 sq. metres (250.8 sq. feet)

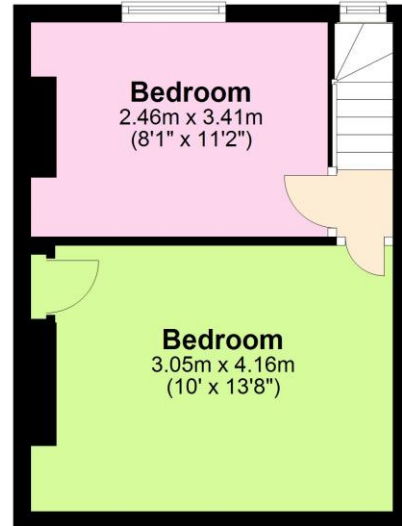

Total area: approx. 51.2 sq. metres (551.6 sq. feet)

This floorplan is for illustration purposes only and is not to scale. The position and size of doors, windows, appliances and other features are approximate. Any lease and service charge details have been provided by the vendor. Any interest party should have these checked by a solicitor as part of the purchase process.

Energy Efficiency Rating	
Current	Potential
Very energy efficient - lower running costs (92-100) A (81-91) B (69-80) C (55-68) D (39-54) E (21-38) F (1-20) G Not energy efficient - higher running costs	89
	59
England, Scotland & Wales EU Directive 2002/91/EC	

Winkworth

for every step...

winkworth.co.uk

Winkworth wishes to inform prospective buyers and tenants that these particulars are a guide and act as information only. All our details are given in good faith and believed to be correct at the time of printing but they don't form part of an offer or contract. No Winkworth employee has authority to make or give any representation or warranty in relation to this property. All fixtures and fittings, whether fitted or not are deemed removable by the vendor unless stated otherwise and room sizes are measured between internal wall surfaces, including furnishings.