

Park Street, London, W1K
£2,800,000 (Negotiable) Leasehold

2  1  2 



Winkworth Mayfair
020 7589 6616 | mayfair@winkworth.co.uk

Winkworth

for every step...

Sophisticated Two-Bedroom on Park Street

ABOUT THE PROPERTY

Located on the first floor of a prestigious building on Park Street, Mayfair, this elegant two-bedroom, two-bathroom apartment combines contemporary luxury with classic design. Set in one of London's most sought-after areas, it offers an exceptional living environment for those seeking comfort and style.

The apartment features large windows that flood the space with natural light, creating a bright and inviting atmosphere throughout. Advanced technology includes a Control4 AV

system, Lutron lighting, and fully integrated air conditioning for year-round comfort. The bespoke kitchen is equipped with high-end Miele appliances. Both bathrooms benefit from underfloor heating, water softener, and boosted water pressure, enhancing daily comfort. The principal bedroom includes ample storage and a stylish en-suite, with a second bedroom ideal for guests or a home office. Completing the home is a private balcony, offering a rare outdoor space in this central Mayfair location.

KEY FEATURES

- 2 bedrooms
- 1 reception room
- 2 bathrooms
- 875 Square Feet
- First floor with balcony
- Decorated to a high standard









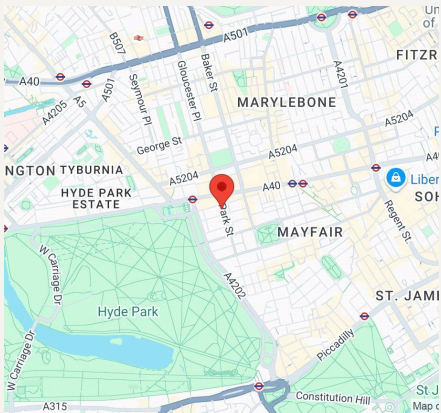

FINER DETAILS

- 2 bedrooms
- 1 reception room
- 2 bathrooms
- 875 Square Feet
- First floor with balcony
- Decorated to a high standard

Leasehold: 125 years

| Score | Energy rating | Current | Potential |
|-------|---------------|---------|-----------|
| 92+ | A | | |
| 81-91 | B | | |
| 69-80 | C | | 77 C |
| 55-68 | D | 63 D | |
| 39-54 | E | | |
| 21-38 | F | | |
| 1-20 | G | | |

Park Street

Approx. Gross Internal Area 875 Sq Ft - 81.29 Sq M
Approx. External Area Of Balcony 36 Sq Ft - 3.35 Sq M

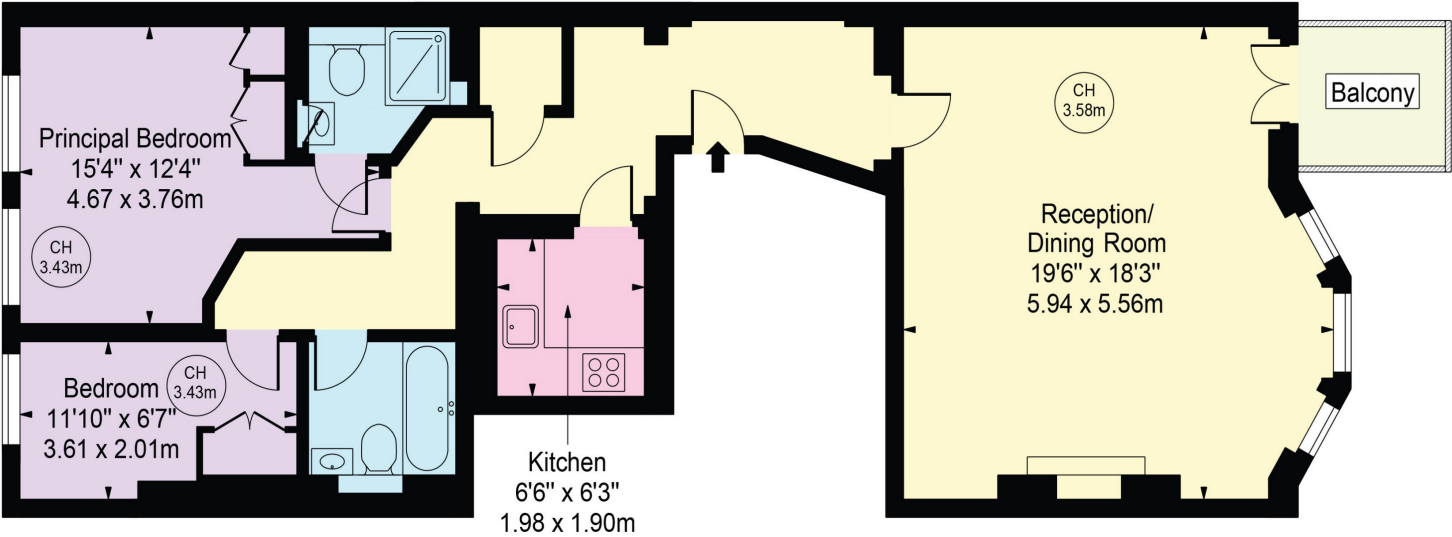

First Floor

For Illustration Purposes Only - Not To Scale

This floor plan should be used as a general outline for guidance only and does not constitute in whole or in part an offer or contract.
Any intending purchaser or lessee should satisfy themselves by inspection, searches, enquiries and full survey as to the correctness of each statement.
Any areas, measurements or distances quoted are approximate and should not be used to value a property or be the basis of any sale or let.

Copyright Morriarti Photography & Design LTD



Winkworth Mayfair
020 7589 6616 | mayfair@winkworth.co.uk

Winkworth

for every step...