



WHITECHAPEL HIGH STREET, LONDON, E1
£3,100 PER MONTH FURNISHED

INTRODUCING AN EXCEPTIONAL TWO-BEDROOM PENTHOUSE WITH OUTDOOR SPACE, PERCHED ATOP A BOUTIQUE

Shoreditch | 020 7749 7650 | shoreditch@winkworth.co.uk

Winkworth

Tenant Fees Apply: Details of fees for tenant referencing, tenancy agreement admin fees and renewal fees are available on the Winkworth website and the link can be found with the displayed rent for the property. Tenants should ensure they are fully conversant with these upfront fees and other costs that are involved at the outset of the tenancy before making an offer to rent and your local Winkworth office will provide written details upon request.

winkworth.co.uk

See things differently



DESCRIPTION:

Introducing an exceptional two-bedroom penthouse with outdoor space, perched atop a boutique warehouse conversion just moments from Aldgate East station. This unique property seamlessly blends modern luxury with charming period design elements, featuring exposed brickwork, oak flooring, and sleek contemporary finishes.

Upon entering, you'll be welcomed by a bright and spacious open-plan living area that effortlessly combines the kitchen and dining spaces. The elevated living area, accessible via a stylish staircase, opens onto a private balcony with stunning views of the city skyline. The fully-equipped kitchen boasts ample storage and a generous dining area, perfect for entertaining.

The hallway leads to a beautifully presented bathroom, complete with a bath and shower attachment. Both bedrooms are generously sized and provide plenty of storage. The master bedroom is a standout feature, offering access to a private balcony, ensuring outdoor space on both sides of the penthouse.

Winkworth



Winkworth

Whitechapel High Street, E1

Approx. Gross Internal Floor Area 627 sq. ft / 58.20 sq. m

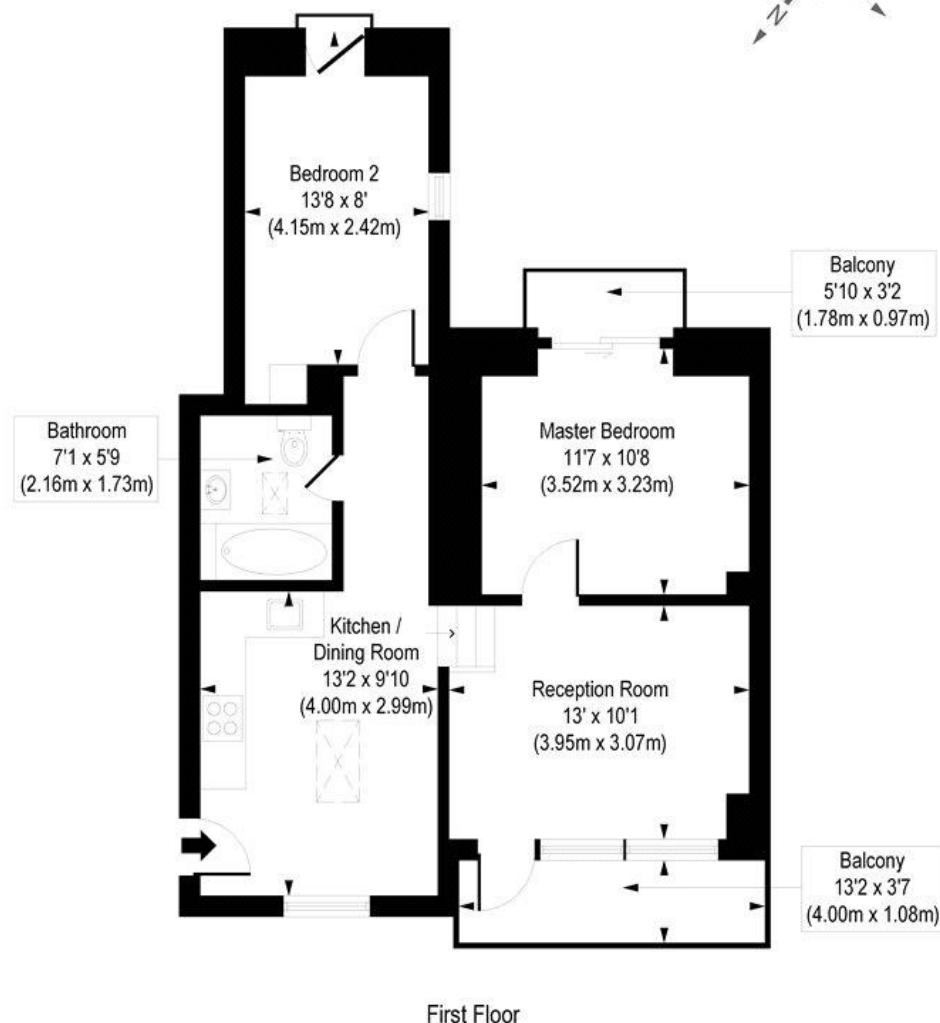
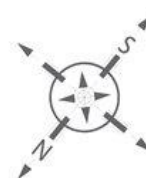

COMPLIANT WITH RICS CODE OF MEASURING PRACTICE. Floorplan is for illustrative purposes only and is not to scale. Every attempt has been made to ensure the accuracy of the floorplan shown, however all measurements, fixtures, fittings and data shown are an approximate interpretation for illustrative purposes only. Liability for errors, omissions or mis-statement through negligence or otherwise is hereby excluded.

This floorplan is for illustration purposes only and is not to scale. The position and size of doors, windows, appliances and other features are approximate.

Shoreditch | 020 7749 7650 | shoreditch@winkworth.co.uk

Winkworth

winkworth.co.uk

See things differently

Winkworth wishes to inform prospective buyers and tenants that these particulars are a guide and act as information only. All our details are given in good faith and believed to be correct at the time of printing but they don't form part of an offer or contract. No Winkworth employee has authority to make or give any representation or warranty in relation to this property. All fixtures and fittings, whether fitted or not are deemed removable by the vendor unless stated otherwise and room sizes are measured between internal wall surfaces, including furnishings.