



RAYMOND ROAD, SW19
£3,500 PER MONTH

Winkworth



RAYMOND ROAD, SW19

Beautifully refurbished three-bedroom apartment is set within a charming period building, ideally located in central Wimbledon

This beautifully refurbished three-bedroom apartment is set within a charming period building, ideally located in central Wimbledon. Situated on the first floor, the apartment boasts a spacious layout with a central hallway that leads to generous living spaces, all tastefully decorated in fresh, neutral tones.

The open-plan kitchen, dining, and living area is bathed in natural light from two large bay windows. The contemporary kitchen offers a sleek range of cabinetry, stone countertops, and high-end Gaggenau integrated appliances. A fully equipped utility room is conveniently located nearby, with a bedroom just off the main living area.

The bright principal bedroom is complemented by built-in wardrobes and a stylish shower room. A second double bedroom also features modern fitted wardrobes, with a contemporary shower room located opposite. Beautiful wooden floors run throughout the apartment, adding warmth and character to the space.

Please note: the reception room images have been staged for illustrative purposes. Unfurnished.

Council Tax Band: E

EPC: D

Holding Fee: £807.69 (1 week's rent) Deposit: £4,038.46 (5 weeks' rent), based on a marketing rent of £3,500 per month. If a higher rent is agreed, the deposit will be adjusted accordingly.





Sussex House, Raymond Road, SW19

Approximate Gross Internal Area 126.7 sq.m (1364 sq.ft)

For Identification Only. Not To Scale.

© Mays Floorplans

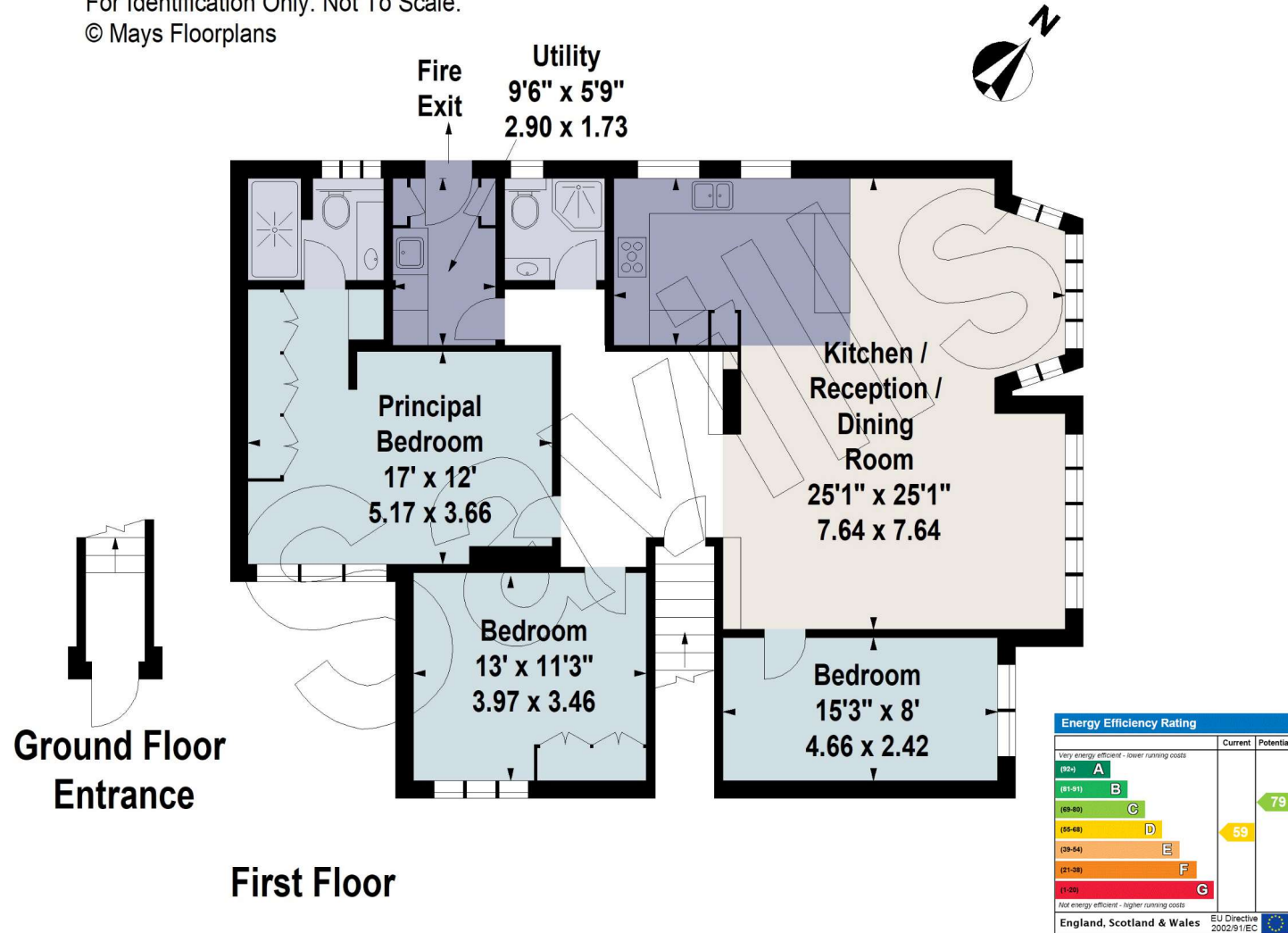

Wimbledon | 02037614040 | wimbledon@winkworth.co.uk

winkworth.co.uk

Winkworth wishes to inform prospective buyers and tenants that these particulars are a guide and act as information only. All our details are given in good faith and believed to be correct at the time of printing but they don't form part of an offer or contract. No Winkworth employee has authority to make or give any representation or warranty in relation to this property. All fixtures and fittings, whether fitted or not are deemed removable by the vendor unless stated otherwise and room sizes are measured between internal wall surfaces, including furnishings.

Winkworth