



ARTIZAN ROAD, NORTHAMPTON, NORTHAMPTONSHIRE, NN1
£210,000 FREEHOLD





ARTIZAN ROAD, NORTHAMPTON, NORTHAMPTONSHIRE, NN1

Located close to local amenities off the Wellingborough Road, is this beautifully presented two bedroom traditional Victorian terrace home which benefits from having a converted basement. The property features an open plan lounge/dining room, with a lovely feature fireplace in the living room. A Upvc double glazed window face to the front aspect. The dining area features a sash window to the rear aspect. The kitchen has a comprehensive range of units at eye and base level with stainless steel drainer sink unit, built in oven with four ring gas hob and space and plumbing for a washing machine. A Upvc double glazed window face to the side aspect and a part glazed door leads out to the rear garden. A further door from the kitchen leads down to the converted basement. The basement has power and lighting and a window to the front aspect.

To the first floor there are two bedrooms and a large family bathroom. The master bedroom features a Upvc double glazed window to the front aspect. Bedroom two features a Upvc double glazed window to the rear aspect. The bathroom features a three piece suite incorporating a panel enclosed bath, with wall mounted shower and monsoon style shower head, low flush WC and pedestal wash hand basin.

The rear garden has been beautifully hard landscaped, providing a large entertaining area. The garden has benefited from having replaced fencing, paved patio area, with hard borders surrounding.





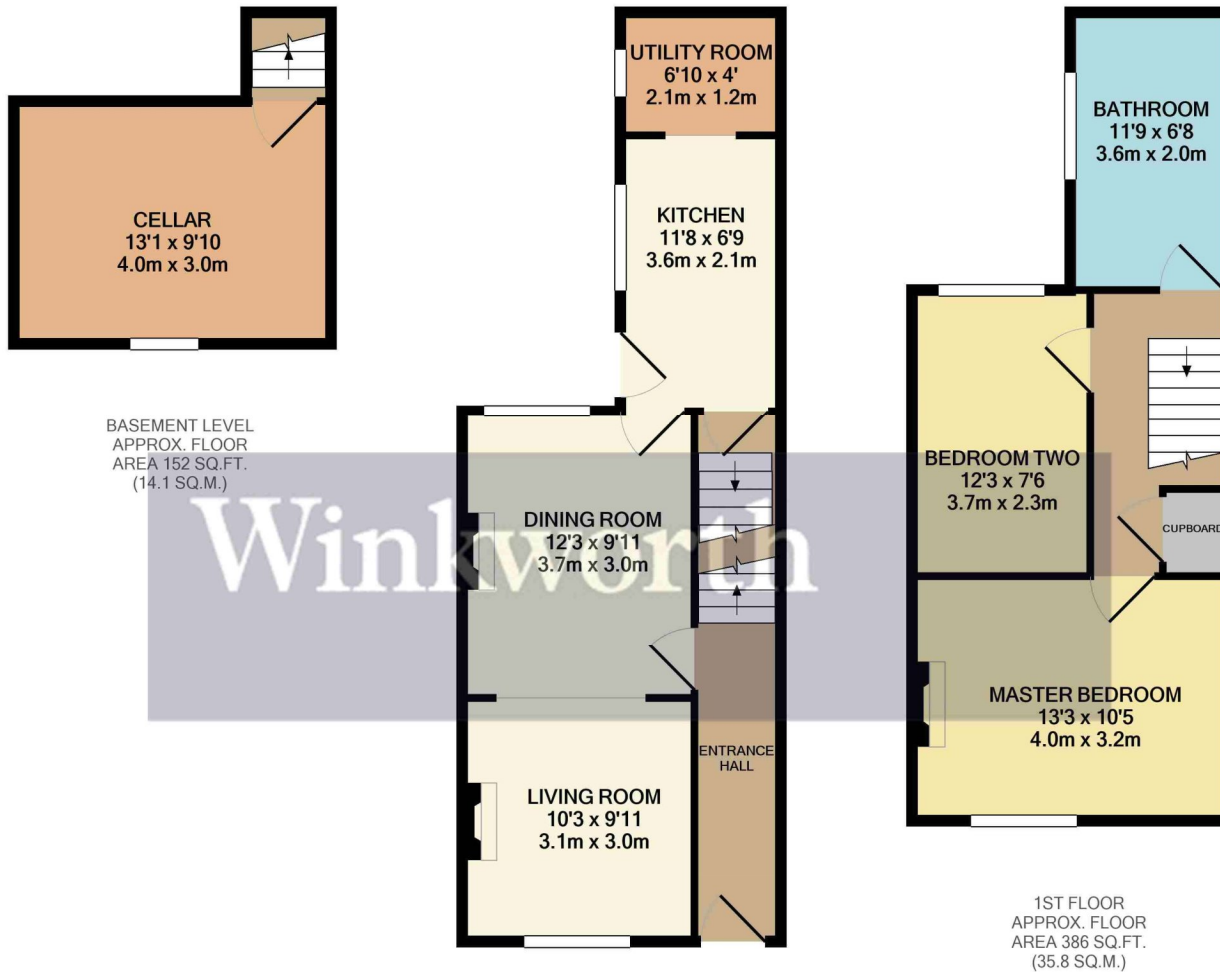

Winkworth

GROUND FLOOR
APPROX. FLOOR
AREA 420 SQ.FT.
(39.1 SQ.M.)

TOTAL APPROX. FLOOR AREA 958 SQ.FT. (89.0 SQ.M.)

Whilst every attempt has been made to ensure the accuracy of the floor plan contained here, measurements of doors, windows, rooms and any other items are approximate and no responsibility is taken for any error, omission, or mis-statement. This plan is for illustrative purposes only and should be used as such by any prospective purchaser. The services, systems and appliances shown have not been tested and no guarantee as to their operability or efficiency can be given

Made with Metropix ©2021

Northampton | 01604 204455 | northampton@winkworth.co.uk

winkworth.co.uk

Winkworth wishes to inform prospective buyers and tenants that these particulars are a guide and act as information only. All our details are given in good faith and believed to be correct at the time of printing but they don't form part of an offer or contract. No Winkworth employee has authority to make or give any representation or warranty in relation to this property. All fixtures and fittings, whether fitted or not are deemed removable by the vendor unless stated otherwise and room sizes are measured between internal wall surfaces, including furnishings.

