



CREDENHILL STREET, SW16
£500,000 LEASEHOLD

**A FABULOUS SPLIT LEVEL FLAT SITUATED IN
THE SOUGHT AFTER AREA OF FURZEDOWN**

Tooting | 020 8767 5221 | tooting@winkworth.co.uk

Winkworth

for every step...

winkworth.co.uk



DESCRIPTION

A fabulous split level flat situated in the sought after area of Furzedown. Beautifully decorated throughout this wonderful flat consists of three well-proportioned double bedrooms. To the front of the flat is a wonderful reception room with high ceilings, feature fireplace and sash windows. There is a modern kitchen with ample storage and integral appliances and a spacious family bathroom is also on the first floor. On the second floor, the master bedroom boasts an ensuite shower room. The property has been superbly maintained and offers modern living whilst keep many original features.

Credenhill Street is situated within the highly acclaimed Furzedown location. A wide range of local amenities can be found within easy reach on Moyser Road and Tooting High Road. Transport links are found a short walk away at Tooting Bec Underground (Northern Line), Streatham Common (providing access to London Bridge, Victoria and Clapham Junction), and Streatham Overground Station (providing Thames Link services).





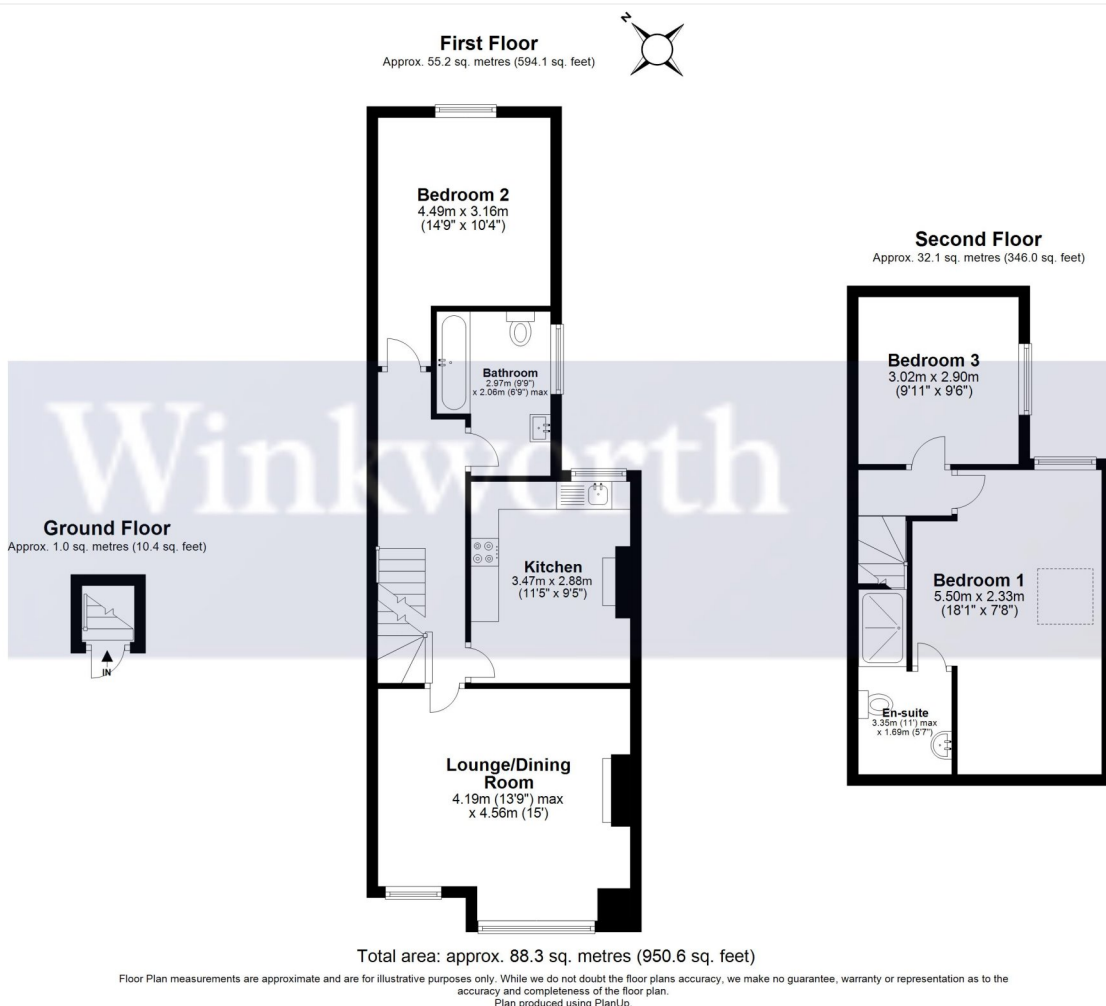

This floorplan is for illustration purposes only and is not to scale. The position and size of doors, windows, appliances and other features are approximate.

Energy Efficiency Rating		
	Current	Potential
Very energy efficient - lower running costs		
A (92-100)		
B (81-91)		
C (69-80)		
D (55-68)		
E (39-54)		
F (21-38)		
G (1-20)		
Not energy efficient - higher running costs		
England, Scotland & Wales	75	81
EU Directive 2002/91/EC		

Tooting | 020 8767 5221 | tooting@winkworth.co.uk

Winkworth

for every step...

winkworth.co.uk

Winkworth wishes to inform prospective buyers and tenants that these particulars are a guide and act as information only. All our details are given in good faith and believed to be correct at the time of printing but they don't form part of an offer or contract. No Winkworth employee has authority to make or give any representation or warranty in relation to this property. All fixtures and fittings, whether fitted or not are deemed removable by the vendor unless stated otherwise and room sizes are measured between internal wall surfaces, including furnishings.