



FELLBRIGG ROAD, EAST DULWICH, SE22  
£950,000 FREEHOLD

A FANTASTIC VICTORIAN TERRACED HOUSE,  
SITUATED ON A PRIME ROAD IN SE22 CLOSE  
TO LORDSHIP LANE.

Dulwich | 020 8299 2722 | [dulwich@winkworth.co.uk](mailto:dulwich@winkworth.co.uk)

**Winkworth**

[winkworth.co.uk](http://winkworth.co.uk)

See things differently



## DESCRIPTION:

A fantastic Victorian terraced house, situated on a prime road in SE22 close to Lordship Lane. This charming family home is offered to the market chain free. Comprising on the ground floor is a spacious double reception, complete with high ceilings. Spacious kitchen-diner is situated to the rear, boasting a fully fitted kitchen and separate utility room. The garden is extremely spacious, comprising a spacious outhouse and the potential to extend the property to the rear and side STPP. The first floor comprises three double bedrooms and a spacious family bathroom. There is potential to extend into the loft allowing a spacious master en-suite or two large doubles and shower room. The location offers fantastic access to Lordship Lane with its impressive array of shops, bars, and restaurants. Transport links are provided via East Dulwich station for direct links to London Bridge, alternatively a short bus to Peckham Rye or Denmark Hill for overground connections. School catchments are in abundance with Harris, Goodrich, and Heber to name a few, and Charter East for secondary.

## AT A GLANCE

- Three Bedrooms
- Victorian Terraced House
- Double Reception
- Kitchen-Diner
- Large Bathroom
- Freehold
- Potential to Extend to the Rear and Side STPP
- Chain Free





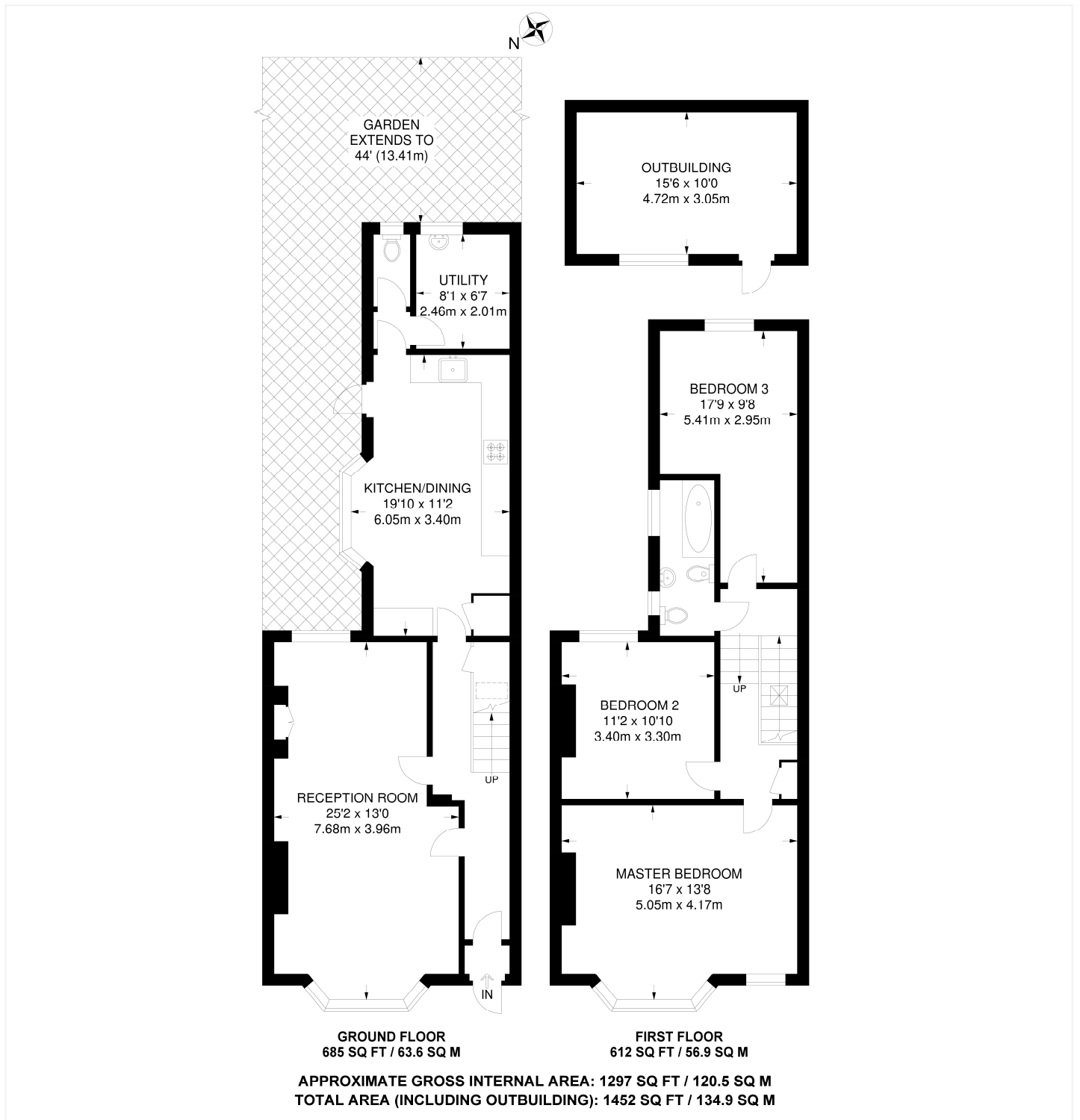

This floorplan is for illustration purposes only and is not to scale. The position and size of doors, windows, appliances and other features are approximate.

Dulwich | 020 8299 2722 | dulwich@winkworth.co.uk



winkworth.co.uk

See things differently

Winkworth wishes to inform prospective buyers and tenants that these particulars are a guide and act as information only. All our details are given in good faith and believed to be correct at the time of printing but they don't form part of an offer or contract. No Winkworth employee has authority to make or give any representation or warranty in relation to this property. All fixtures and fittings, whether fitted or not are deemed removable by the vendor unless stated otherwise and room sizes are measured between internal wall surfaces, including furnishings.