

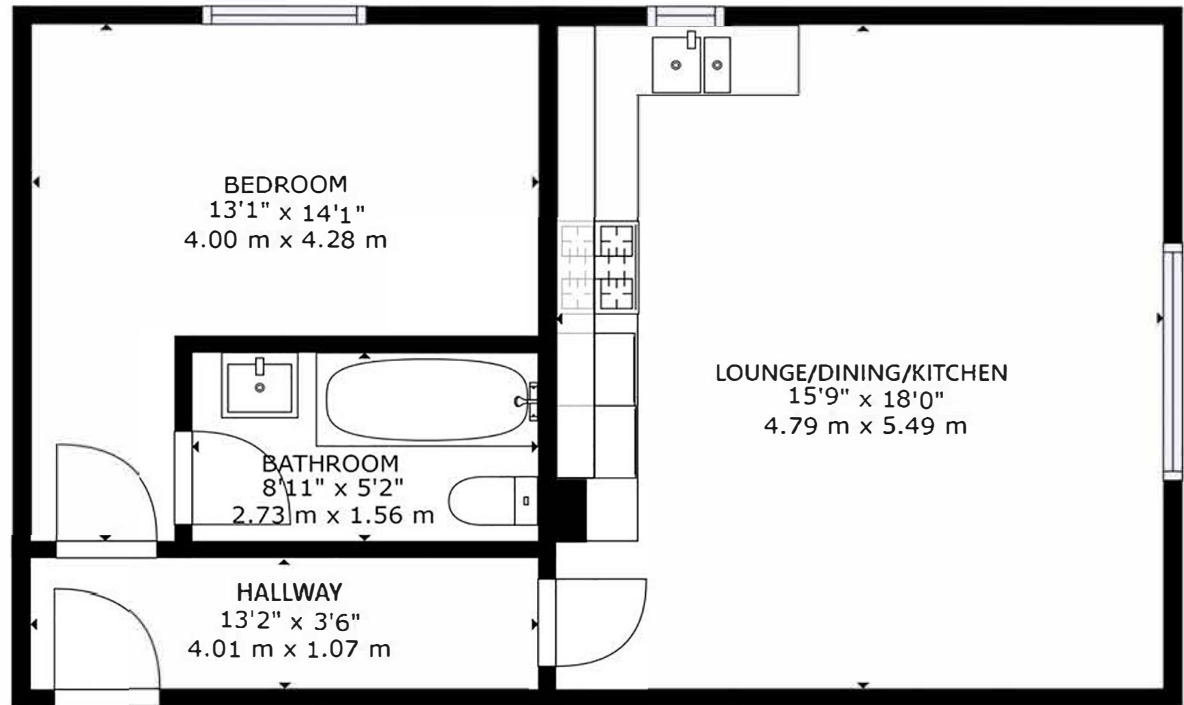

Monkton Heights
Boscombe Spa BH5 1AU
ASKING PRICE £170,000





FLOOR 1

GROSS INTERNAL AREA
FLOOR 1: 577 sq. ft, 54 m²
TOTAL: 577 sq. ft, 54 m²
SIZES AND DIMENSIONS ARE APPROXIMATE, ACTUAL MAY VARY.





ASKING PRICE - £170,000

01202 434365 | southbourne@winkworth.co.uk

A tastefully decorated and modernised, top floor apartment, with a brand new kitchen, complete with a NEFF integrated gas hob and oven, and an integrated fridge / freezer and new herringbone flooring, leading the to the open-plan lounge / dining area. The bedroom is a spacious double room with ample space for a range of furniture and a new bathroom suite with bath and over head shower, wash basin, w/c and a LED lit mirror with storage.

Share of freehold | EPC: TBC | Pets: Permitted | Short term / holiday lets: Not Permitted | Maintenance: £1800pa

- One Double Bedroom
- Open-plan Living
- Modern Kitchen
- Spacious Lounge / Diner
- Convenient Location
- Residents Parking





Boscombe is the suburb of Bournemouth and is located to the south east and neighbours both Bournemouth and Southbourne. Boscombe High Street offers a varied shopping experience with a number of well known high street stores. The area benefits from a number of local attractions including the award-winning blue flag sandy beaches with a level walk promenade extending from Hengistbury Head through to Sandbanks.

A local bus service provides links to Bournemouth and Poole with a different shopping experience together with a number of restaurants and bars providing a vibrant nightlife. A local train station provides direct links to Southampton, Southampton Airport and London which is approximately 100 miles away. Bournemouth International airport (6 miles) offers a varied schedule of flights to a number of European destinations.

Winkworth Southbourne

29 Southbourne Grove, Bournemouth, Dorset, BH6 3QT

01202 434365 | southbourne@winkworth.co.uk

winkworth.co.uk/southbourne

Winkworth