

Winkworth

Haldon Road, London, SW18 1QB







A large and beautifully presented maisonette set over two floors of this attractive period property in Putney. Offered to the market in immaculate condition, accommodation totals 1,650 sq. ft. and includes a spacious kitchen/dining room, separate front reception room, five bedrooms and two smart modern bathrooms. At the rear is a private westerly facing roof terrace leading down onto a well-presented and low maintenance courtyard garden. The property benefits from high ceilings adding the already impressive sense of space and retains many of its original period fireplaces. Sold with a long lease with approximately 950 years remaining.

Haldon Road is a popular residential road located only a short distance from East Putney underground and Putney mainline stations. There are also numerous buses with swift access to Clapham Junction and beyond. Wandsworth Southside Shopping Centre is also close by.

- Period Maisonette
- Five Bedrooms
- Kitchen/Dining Room
- Separate Reception Room
- Private Garden
- Leasehold – Approx. 950 Years
- 1,650 Sq. Ft.

Haldon Road, London, SW18 1QB



## Leasehold

Approximately 950 Years Remaining

### Internal area

Approximate gross internal area:

**Total 1,650 sq ft/ 153.2 sq m**

# Haldon Road, London, SW18 1QB



## Haldon Road



Approximate Gross Internal Area Total = 153.2 sq m / 1650 sq ft

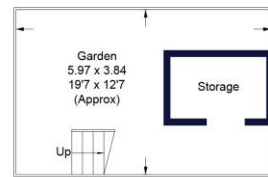

Ground Floor

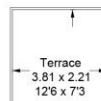

Ground Floor  
Sq m 2.2 / Sq ft 24

First Floor  
Sq m 84.3 / Sq ft 907

= Reduced headroom below 1.5m / 5'0



Second Floor  
Sq m 66.7 / Sq ft 719

Illustration for identification purposes only, measurements are approximate, not to scale. FloorplansUsketch.com © 2022 (ID866825)

W621 Ravensworth 01670 713330



Under the Property Misdescriptions Act these particulars are intended as a guide and act as information only. They give a fair overall description for the guidance of potential purchasers or tenants but do not constitute an offer or part of a contract. All details and approximate measurements are given in good faith and are believed to be correct at the time of printing, but any potential purchasers or tenants should not rely on the mis-statements or representations of fact but must satisfy themselves by inspection or otherwise as to their correctness. No employee of Winkworth has authority to make or give any representation or warranty to this property.

Putney Office 241 Wimbledon Park Road, SW18 5RJ | Tel: 0208 877 1000 | E-mail: Southfields@winkworth.co.uk  
winkworth.co.uk