



Ritherdon Road, SW17

£285,000 *Leasehold*



Presenting this exquisite period first floor apartment, located in a sought-after area between Tooting Bec and Balham.

KEY FEATURES

- Period Property
- One bedroom
- Communal Gardens
- Chain Free
- Long Lease
- Between Balham and Tooting Bec



Tooting

020 8767 5221 | tooting@winkworth.co.uk

Winkworth

for every step...



This charming property boasts one bedroom, a bright reception room and a fitted open plan kitchen, and a bathroom. The apartment features high ceilings, large windows allowing natural light to flood in. Early viewing recommended.

Located in the ever-popular Heaver Estate, Ritherdon Road is close to the open spaces of Tooting Bec Common and is situated equidistant to both Tooting Bec and Balham Tube stations and Balham National Rail. The bustling Balham High Road is nearby, providing a variety of shops, cafes, and restaurants.





MATERIAL INFO

Tenure: Leasehold

Term: 146 years

Service Charge: £1700 per annum

Ground Rent: N/A

Council Tax Band: Band B

EPC rating: E

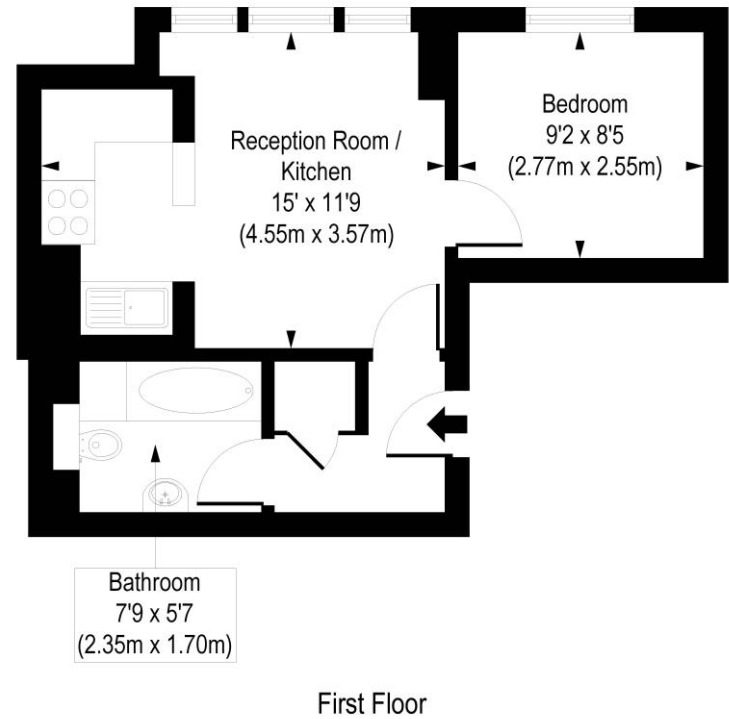
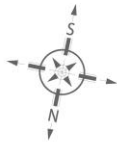

COMPLIANT WITH RICS CODE OF MEASURING PRACTICE: Floorplan is for illustrative purposes only and is not to scale. Every attempt has been made to ensure the accuracy of the floorplan shown, however all measurements, fixtures, fittings and data shown are an approximate interpretation for illustrative purposes only. Liability for errors, omissions or mis-statement through negligence or otherwise is hereby excluded.

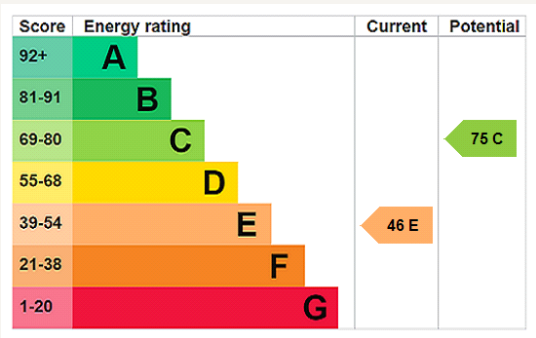

Where no figures are shown, we have been unable to ascertain the information. All figures that are shown were correct at the time of printing.