



ASHDOWN WAY, LONDON, SW17
£350,000 LEASEHOLD

TWO BEDROOM GROUND FLOOR APARTMENT CLOSE TO BALHAM TRAIN STATION

Tooting | 020 8767 5221 | tooting@winkworth.co.uk

Winkworth

for every step...

winkworth.co.uk



DESCRIPTION:

A two bedroom, ground floor apartment situated on a quiet residential development yet being within striking distance of Balham train station. The property is an ideal first time purchase and benefits from generous proportions throughout. The property requires modernisation throughout.

Ashdown Way is conveniently located for commuters being close to Balham train station offering overground and underground services. Balham High Road is a short walk away offering all local and national amenities and a selection of bars/restaurants. Tooting Bec common is a short 10 minute walk away.

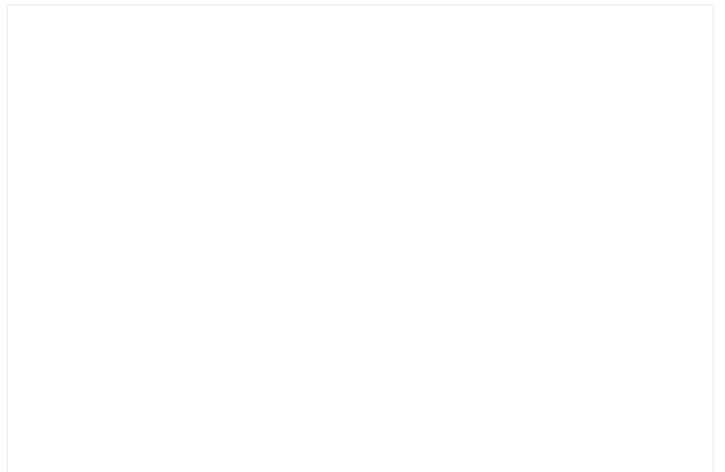
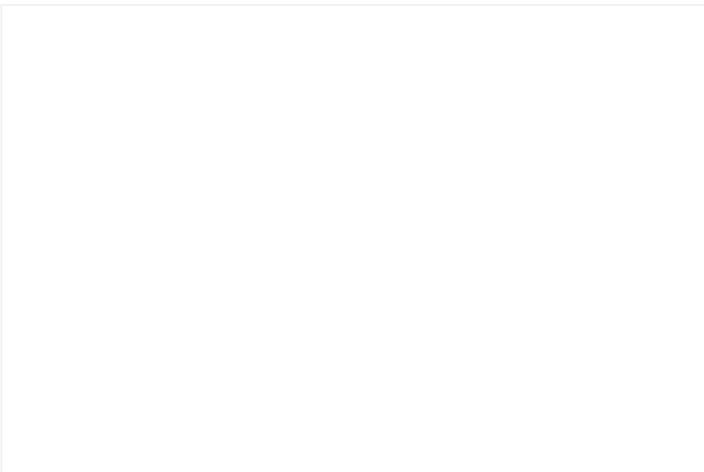

Ashdown Way, SW17

Approx. Gross Internal Floor Area 519 sq. ft / 48.18 sq. m

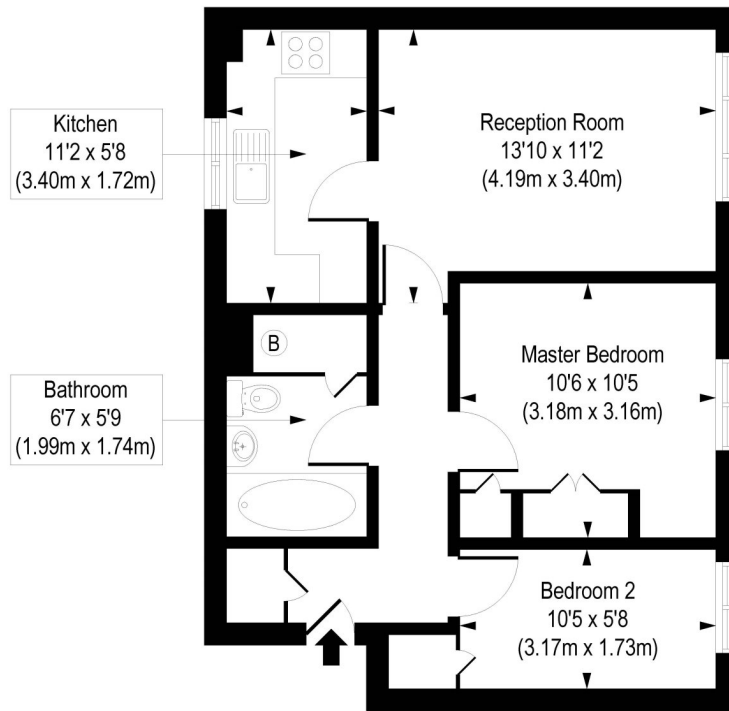
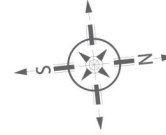

Ground Floor

COMPLIANT WITH RICS CODE OF MEASURING PRACTICE. Floorplan is for illustrative purposes only and is not to scale. Every attempt has been made to ensure the accuracy of the floorplan shown, however all measurements, fixtures, fittings and data shown are an approximate interpretation for illustrative purposes only. Liability for errors, omissions or mis-statement through negligence or otherwise is hereby excluded.

This floorplan is for illustration purposes only and is not to scale. The position and size of doors, windows, appliances and other features are approximate.

Tooting | 020 8767 5221 | tooting@winkworth.co.uk

Winkworth

for every step...

winkworth.co.uk

Winkworth wishes to inform prospective buyers and tenants that these particulars are a guide and act as information only. All our details are given in good faith and believed to be correct at the time of printing but they don't form part of an offer or contract. No Winkworth employee has authority to make or give any representation or warranty in relation to this property. All fixtures and fittings, whether fitted or not are deemed removable by the vendor unless stated otherwise and room sizes are measured between internal wall surfaces, including furnishings.