



EGREMONT ROAD, WEST NORWOOD, LONDON, SE27  
**£750,000 FREEHOLD**

**A WELL PRESENTED THREE BEDROOM, SEMI-  
DETACHED, 1930'S FAMILY HOME.**

West Norwood | 02086700035 | westnorwood@winkworth.co.uk

**Winkworth**

for every step...

*winkworth.co.uk*





## DESCRIPTION:

A well presented three bedroom, semi-detached, 1930's family home. Further accommodation comprises; reception room, kitchen, dining room and private front and rear gardens. The property offers a fantastic opportunity in that subject to the usual planning consents you can extend into both the loft and at the rear of the property to provide extra living accommodation and is located on a popular residential road within West Norwood with the amenities of Knights Hill and Norwood close to hand. Nearest transport is provided at West Norwood with its frequent services to London Bridge and Victoria. An internal viewing is highly recommended! CHAIN FREE! Council Tax band D.



**Winkworth**

for every step...





**Winkworth**

for every step...

## EGREMONT ROAD, SE27

Approx. Gross Internal Floor Area  
1076 Sq. ft/99.92 Sq. m

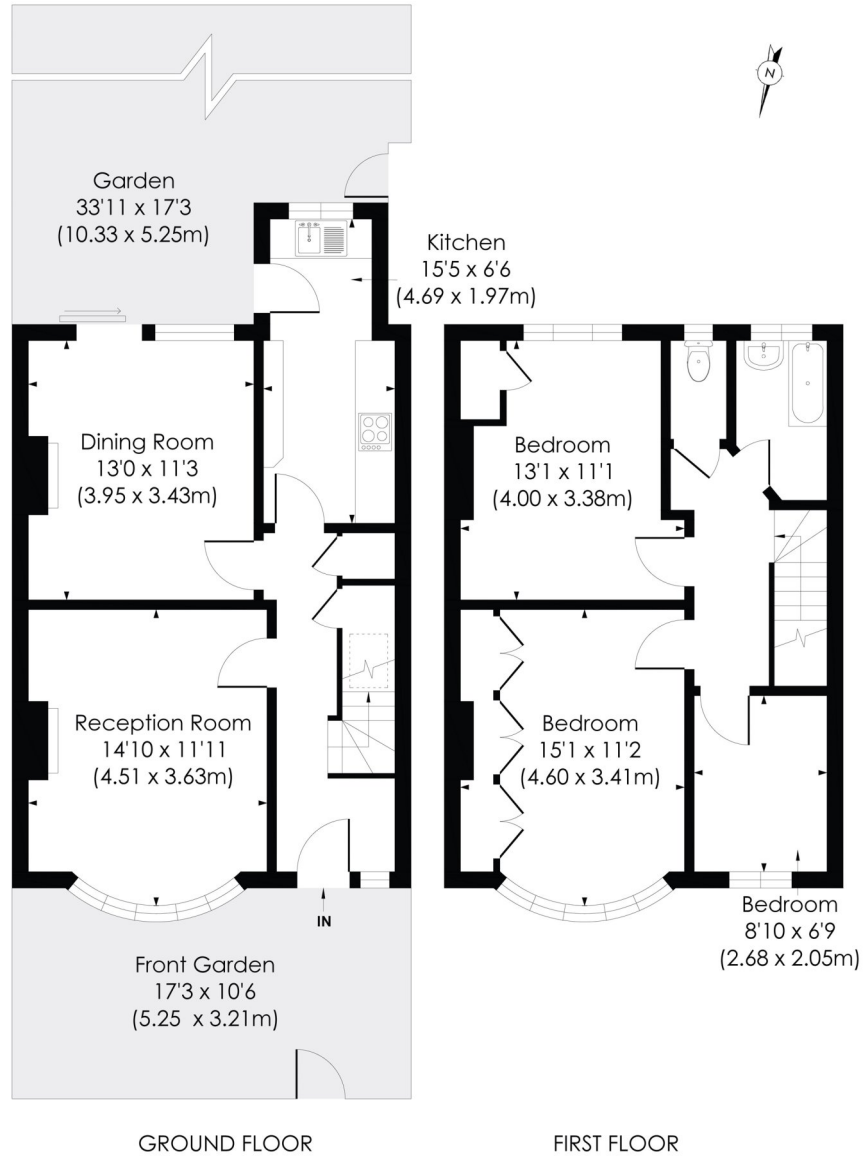

© Pixangle Property Marketing Ltd. info@pixangle.com Tel: 0208 870 2118

pixangle  
PROPERTY MARKETING

This floor plan has been prepared for the purpose of illustration only in accordance with the latest RICS code of measuring practice and is not to scale. All measurements and areas are approximate and whilst every effort has been made to ensure the accuracy of the plan contained here, no responsibility is taken for any error, omission or misstatement.

This floorplan is for illustration purposes only and is not to scale. The position and size of doors, windows, appliances and other features are approximate.

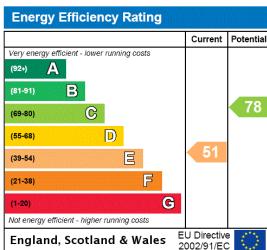

West Norwood | 02086700035 | westnorwood@winkworth.co.uk

for every step...

winkworth.co.uk

Winkworth wishes to inform prospective buyers and tenants that these particulars are a guide and act as information only. All our details are given in good faith and believed to be correct at the time of printing but they don't form part of an offer or contract. No Winkworth employee has authority to make or give any representation or warranty in relation to this property. All fixtures and fittings, whether fitted or not are deemed removable by the vendor unless stated otherwise and room sizes are measured between internal wall surfaces, including furnishings.