



MOON COURT, LEE, LONDON, SE12
£2,200 PER MONTH UNFURNISHED

DESCRIPTION:

A beautiful three bedroom modern house with garage and garden located on this popular development in Lee. Offered on an unfurnished basis and available from 14th November 2025.

Blackheath | 0208 8520999 | blackheath@winkworth.co.uk

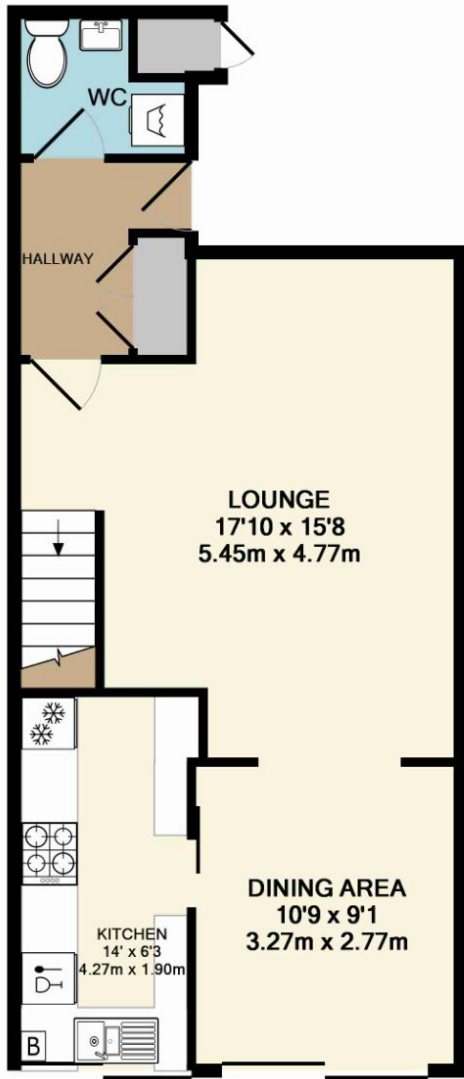

GROUND FLOOR
APPROX. FLOOR
AREA 503 SQ.FT.
(46.8 SQ.M.)

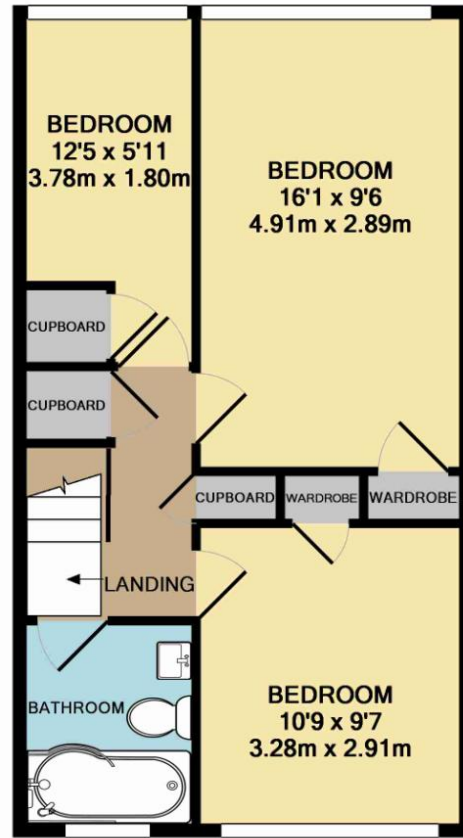

1ST FLOOR
APPROX. FLOOR
AREA 449 SQ.FT.
(41.7 SQ.M.)



TOTAL APPROX. FLOOR AREA 952 SQ.FT. (88.4 SQ.M.)

Whilst every attempt has been made to ensure the accuracy of the floor plan contained here, measurements of doors, windows, rooms and any other items are approximate and no responsibility is taken for any error, omission, or mis-statement. This plan is for illustrative purposes only and should be used as such by any prospective purchaser. The services, systems and appliances shown have not been tested and no guarantee as to their operability or efficiency can be given
Made with Metropix ©2013

This floorplan is for illustration purposes only and is not to scale. The position and size of doors, windows, appliances and other features are approximate.

Score	Energy rating	Current	Potential
92+	A		
81-91	B		
69-80	C		
55-68	D		
39-54	E		
21-38	F		
1-20	G		
		70 C	83 B

Deposit: £2,538.46

Holding Deposit:

Council Tax Band:

Where no figures are shown, we have been unable to ascertain the information. All figures that are shown were correct at the time of printing.