



KENSINGTON WAY, HERTFORDSHIRE, WD6
£1,700 PER MONTH

**AN IMMACULATELY PRESENTED TWO DOUBLE
BEDROOM HOUSE WITH GARAGE AND
ALLOCATED PARKING.**

Borehamwood | 020 8953 8899 | borehamwood@winkworth.co.uk



DESCRIPTION:

.



Approximate Gross Internal Area = 61.2 sq m / 659 sq ft
 Garage = 13.6 sq m / 146 sq ft
 Total = 74.8 sq m / 805 sq ft
 (Including Store)

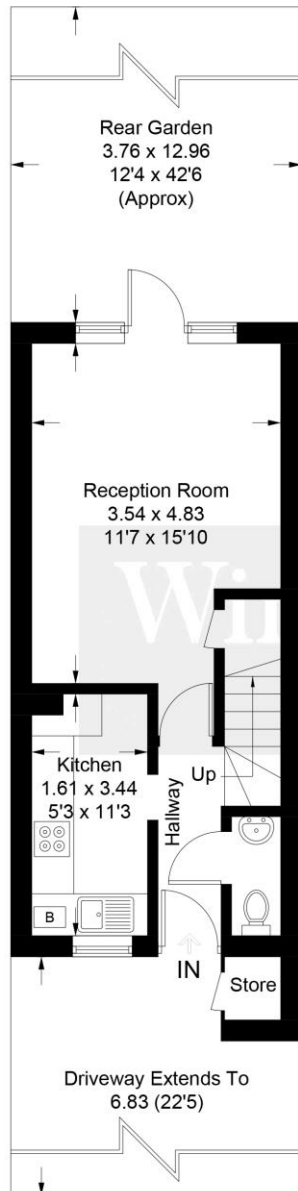

Ground Floor

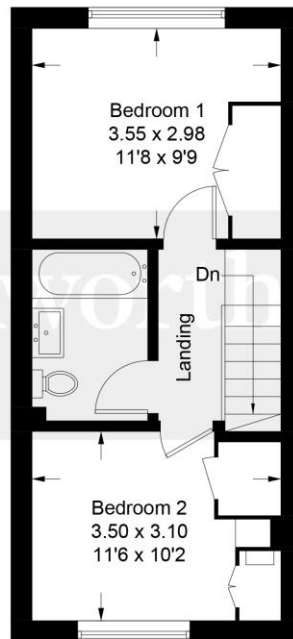

First Floor



(Not Shown In Actual Location / Orientation)

Illustration for identification purposes only, measurements are approximate, not to scale. Winkworth © 2019 (ID591703)

This floorplan is for illustration purposes only and is not to scale. The position and size of doors, windows, appliances and other features are approximate.

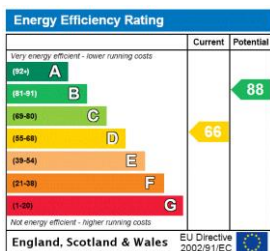

Deposit: £1,961.54

Holding Deposit:

Council Tax Band: D

Where no figures are shown, we have been unable to ascertain the information. All figures that are shown were correct at the time of printing.