



## Minerva Lodge, Blackheath, SE3

£2,200 per month *Part Furnished, Unfurnished*



**SORRY BUT NOT SUITABLE FOR SHARERS.** With its own private entrance and beautifully presented, is this large three double bedroom ground floor apartment set just off Blackheath Park, the flagship road of the private Cator Estate. Offered unfurnished/part-furnished and available immediately.



### Blackheath

0208 8520999 | [blackheath@winkworth.co.uk](mailto:blackheath@winkworth.co.uk)

## Ground Floor

Approx. 88.1 sq. metres (948.5 sq. feet)

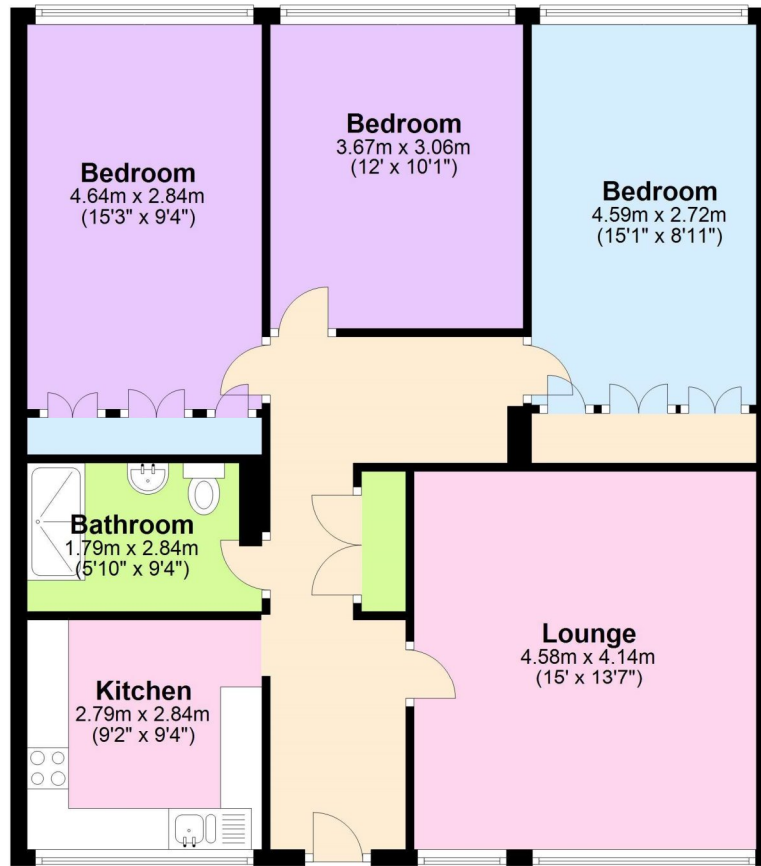

Total area: approx. 88.1 sq. metres (948.5 sq. feet)

## MATERIAL INFO

For more information, scan the QR code or visit the link below

**Deposit: £0.00**  
**Holding Deposit:**  
**Council Tax Band: E**  
**EPC rating: C**

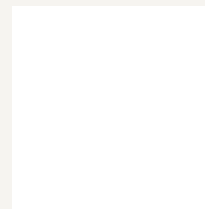

<https://www.winkworth.co.uk/rent/property/BLA250781>

Where no figures are shown, we have been unable to ascertain the information. All figures that are shown were correct at the time of printing.

**Blackheath**

0208 8520999 | [blackheath@winkworth.co.uk](mailto:blackheath@winkworth.co.uk)