



66 CALIFORNIA COUNTRY PARK HOMES, FINCHAMPSTEAD, RG40 4HT
£150,000

Winkworth



CALIFORNIA COUNTRY PARK HOMES

Offered to the market with NO ONWARD chain is this 2 bedroom park home within the grounds of the beautiful California Country Park for the over 45's.

You enter this property into the bright and airy entrance hall. The hall connects you to the rest of this wonderful home. There are 2 bedrooms one of which is perfectly suited to be used as a home office or hobby space with the master having a walk in wardrobe and ensuite. There is a large living room with an open plan fully equipped kitchen. The property is fully double glazed throughout with large windows and doors which overlook a large attractive green, also to the property there is a good sized parking area for a minimum of three cars and a decent garden space.

California park homes is situated next to the popular country park offering fabulous woodland walks with its very own café.

EPC exempt





GROUND FLOOR
457 sq.ft. (42.4 sq.m.) approx.

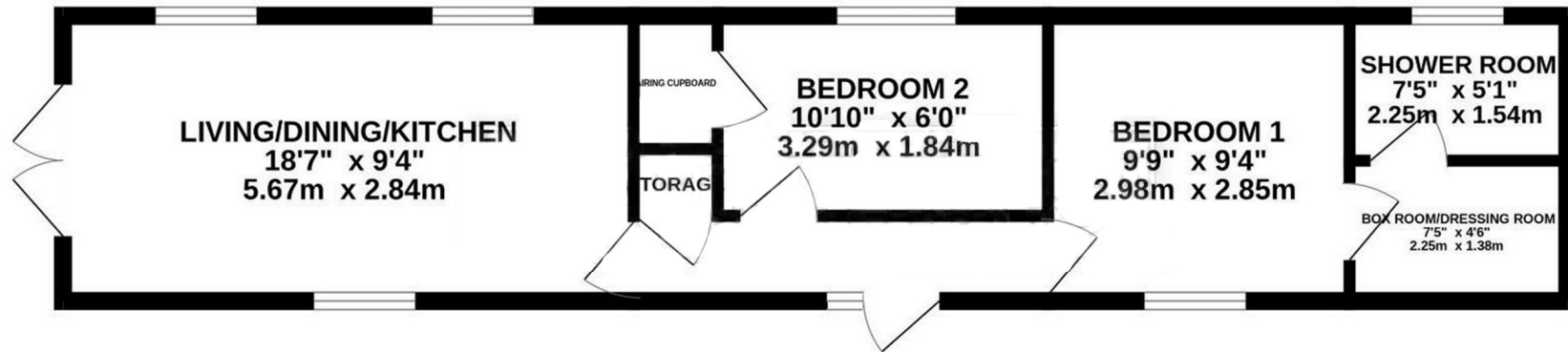

TOTAL FLOOR AREA : 457 sq.ft. (42.4 sq.m.) approx.
Measurements are approximate. Not to scale. Illustrative purposes only.
Made with Metropix ©2023

Wokingham | 01189 072777 | wokingham@winkworth.co.uk



Winkworth wishes to inform prospective buyers and tenants that these particulars are a guide and act as information only. All our details are given in good faith and believed to be correct at the time of printing but they don't form part of an offer or contract. No Winkworth employee has authority to make or give any representation or warranty in relation to this property. All fixtures and fittings, whether fitted or not are deemed removable by the vendor unless stated otherwise and room sizes are measured between internal wall surfaces, including furnishings.