



Montpelier Row, SE3

£1,700 per month *Furnished*



A wonderful one bedroom raised ground floor period flat in the heart of Blackheath with period features, communal garden and Heath views. Offered furnished and available from 3rd January 2026, your earliest viewing is highly recommended.



Blackheath

0208 8520999 | blackheath@winkworth.co.uk

Ground Floor

Approx. 51.0 sq. metres (548.9 sq. feet)

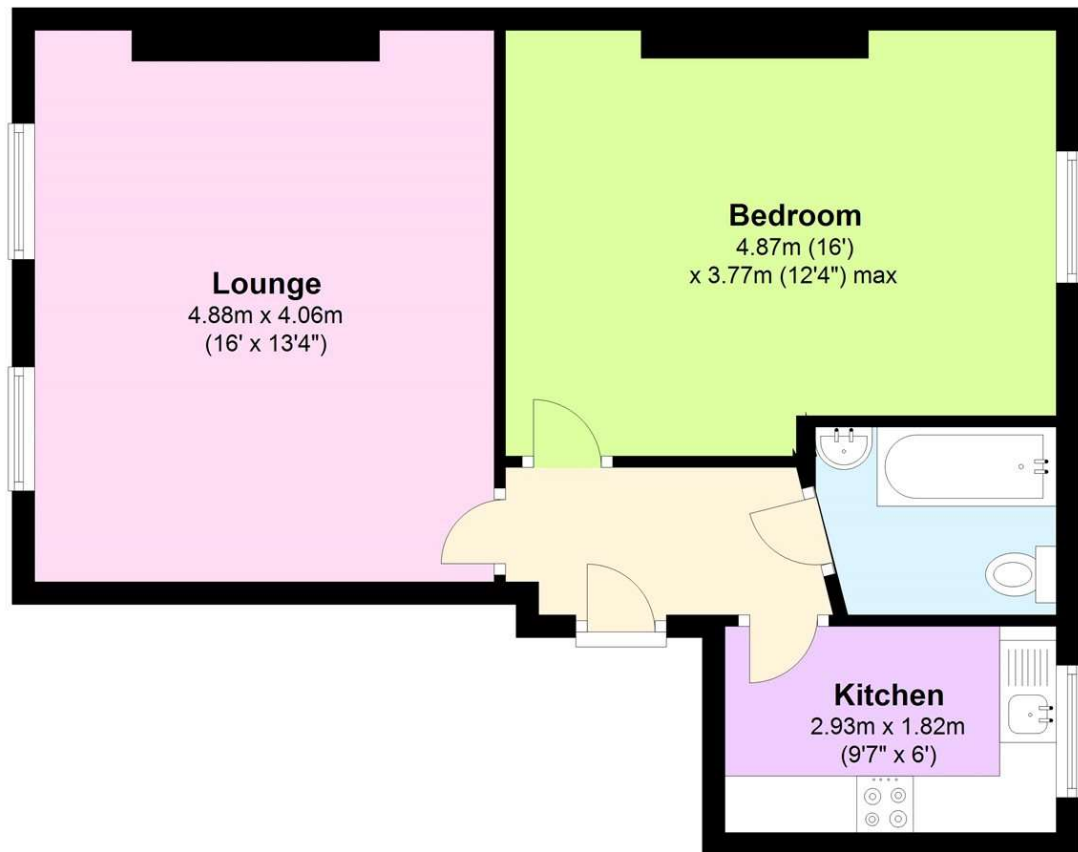

Total area: approx. 51.0 sq. metres (548.9 sq. feet)

MATERIAL INFO

For more information, scan the QR code or visit the link below

Deposit: £1,961.54

Holding Deposit:

Council Tax Band:

EPC rating: C

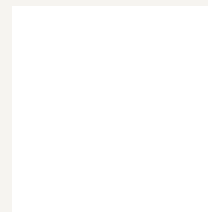

<https://www.winkworth.co.uk/rent/property/GRE180030>

Where no figures are shown, we have been unable to ascertain the information. All figures that are shown were correct at the time of printing.

Blackheath

0208 8520999 | blackheath@winkworth.co.uk