



**MONTPELIER ROW, SE3**  
**£1,750 PER MONTH FURNISHED**

### **DESCRIPTION:**

A stunning one bedroom raised ground floor period flat in the heart of Blackheath with period features, communal garden and Heath views. Offered furnished and available from 5th December 2025, your earliest viewing is highly recommended.

**Blackheath** | 0208 8520999 | [blackheath@winkworth.co.uk](mailto:blackheath@winkworth.co.uk)

## Ground Floor

Approx. 51.0 sq. metres (548.9 sq. feet)

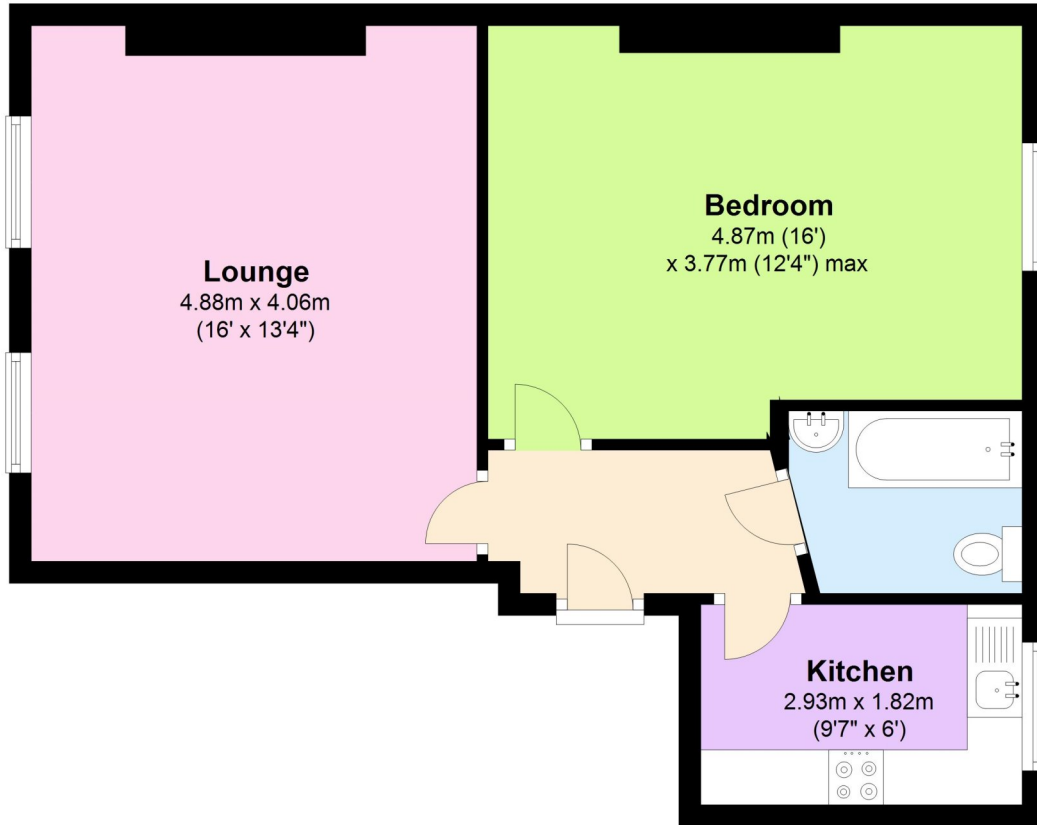

Total area: approx. 51.0 sq. metres (548.9 sq. feet)

This floorplan is for illustration purposes only and is not to scale. The position and size of doors, windows, appliances and other features are approximate.

Energy Efficiency Rating		
	Current	Potential
Very energy efficient - lower running costs		
(92+) <b>A</b>		
(81-91) <b>B</b>		
(69-80) <b>C</b>	71	79
(55-68) <b>D</b>		
(39-54) <b>E</b>		
(21-38) <b>F</b>		
(1-20) <b>G</b>		
Not energy efficient - higher running costs		
England, Scotland & Wales	EU Directive 2002/91/EC	

**Deposit:** £2,019.23

**Holding Deposit:**

**Council Tax Band:**

Where no figures are shown, we have been unable to ascertain the information.  
All figures that are shown were correct at the time of printing.