



1 NEVILLE HOUSE, HIGH STREET ST GREGORYS, CANTERBURY, CT1
£175,000 LEASEHOLD

Canterbury | 01227 456 645 | canterbury@winkworth.co.uk

Winkworth

for every step...

winkworth.co.uk



DESCRIPTION:

This light and spacious one bedroom apartment has its own entrance and is located in the courtyard of a Grade II listed building recently converted into a selection of luxury apartments



Winkworth

for every step...

Situated in the popular Northgate area of the City this apartment benefits from being on the doorstep of all the City has to offer and within walking distance of the Station Road West mainline station and so in London in about an hour.

The apartment has been tastefully converted and is fitted out as a one bedroom apartment with a spacious living/dining area. The kitchen has been fitted out with a modern design. The bedroom is a double room and a separate shower room with plumbing for a washing machine completes the accommodation.

There is also gas central heating and the property has secondary glazing.

This property would make a great first time buy, or may be attractive to buy as an investment and is available to purchase chain free

Leasehold: 125 Years remaining

Service charge: £1100 pa

Ground rent: £100 pa

Canterbury City Centre is approximately five minutes' walk. Close to the High street with its vast array of shops , restaurants , the popular, Marlowe Theatre and Cathedral. Trains go to London, and the high speed rail network takes about an hour to London, St Pancras

The logo for Winkworth, featuring the word "Winkworth" in a white serif font on a dark blue rectangular background.

for every step...



Winkworth
for every step...

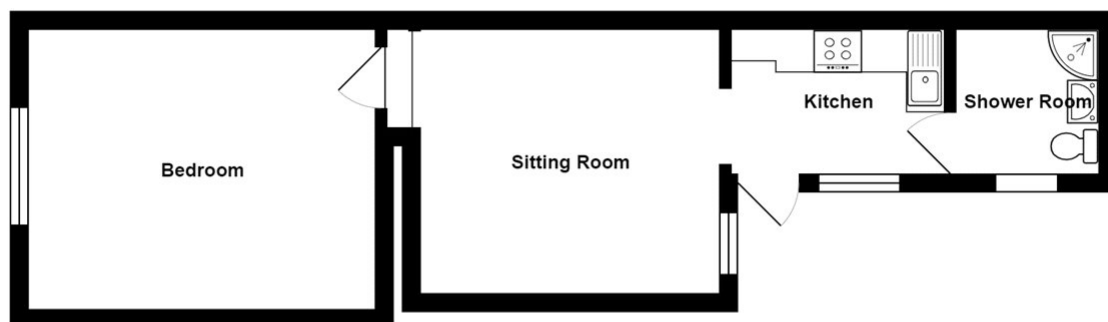

Ground Floor

Measurements of doors, windows and rooms and any other item are approximate and no responsibility is taken for any error, omission or mis-statement. This plan is for illustrative purpose only .

This floorplan is for illustration purposes only and is not to scale. The position and size of doors, windows, appliances and other features are approximate.

Canterbury | 01227 456 645 | canterbury@winkworth.co.uk

Winkworth

for every step...

winkworth.co.uk

Winkworth wishes to inform prospective buyers and tenants that these particulars are a guide and act as information only. All our details are given in good faith and believed to be correct at the time of printing but they don't form part of an offer or contract. No Winkworth employee has authority to make or give any representation or warranty in relation to this property. All fixtures and fittings, whether fitted or not are deemed removable by the vendor unless stated otherwise and room sizes are measured between internal wall surfaces, including furnishings.