



PETHERTON ROAD, HIGHBURY, N5
£350,000 LEASEHOLD

A STUNNING FIRST FLOOR ONE BEDROOM PERIOD CONVERSION SET MOMENTS FROM CLISSOLD PARK

Islington | 0207 354 2480 | islington@winkworth.co.uk

Winkworth

winkworth.co.uk

See things differently



DESCRIPTION:

Set over the first floor of this period building on Petherton road, this one bed flat offers light and well proportioned living space in a great location.

Petherton Road is located moments from Clissold Park and withing easy reach of the many restaurants, pubs and shops on the vibrant Stoke Newington Church Street. Canonbury overground offers the closest overground links whilst Highbury and Islington underground station provides the closest underground links on the Victoria Line. Numerous bus routes provide easy access to the City and West End.

Winkworth



Winkworth

Petherton Road, N5
 Approx. Gross Internal Area 455 sq. ft / 42.28 sq. m

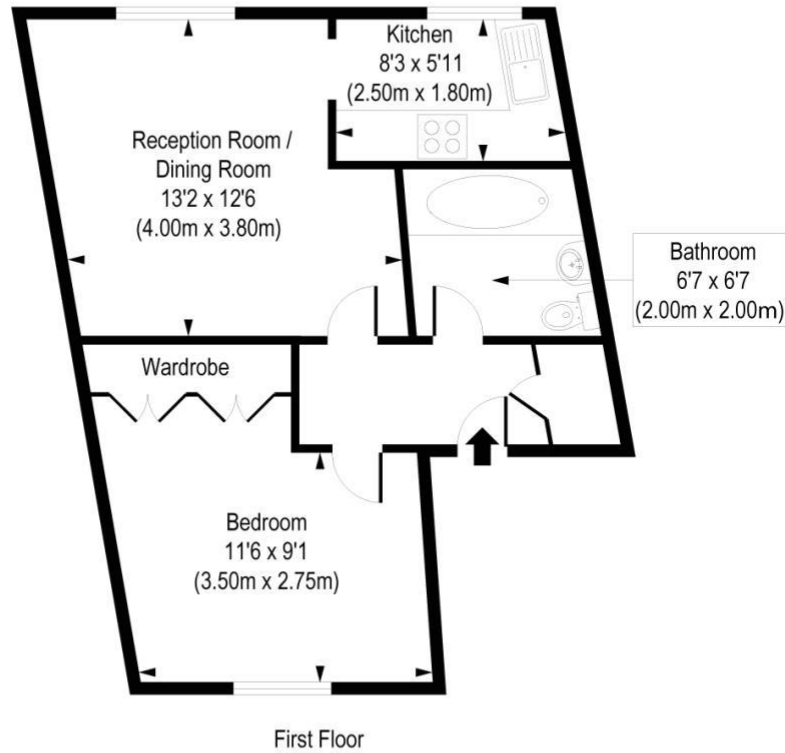

COMPLIANT WITH RICS CODE OF MEASURING PRACTICE Floorplan is for illustrative purposes only and is not to scale. Every attempt has been made to ensure the accuracy of the floorplan shown, however all measurements, fixtures, fittings and data shown are an approximate interpretation for illustrative purposes only. Liability for errors, omissions or mis-statement through negligence or otherwise is hereby excluded.

This floorplan is for illustration purposes only and is not to scale. The position and size of doors, windows, appliances and other features are approximate.

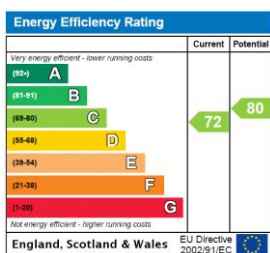

Islington | 0207 354 2480 | islington@winkworth.co.uk

Winkworth

winkworth.co.uk

See things differently

Winkworth wishes to inform prospective buyers and tenants that these particulars are a guide and act as information only. All our details are given in good faith and believed to be correct at the time of printing but they don't form part of an offer or contract. No Winkworth employee has authority to make or give any representation or warranty in relation to this property. All fixtures and fittings, whether fitted or not are deemed removable by the vendor unless stated otherwise and room sizes are measured between internal wall surfaces, including furnishings.