



HENDON LANE, LONDON, N3
OFFERS IN THE REGION OF £550,000 LEASEHOLD

A SPACIOUS AND WELL PRESENTED FLAT,
SET IN A SOUGHT AFTER BLOCK ON HENDON
LANE.

Finchley | 020 8349 3388 | finchley@winkworth.co.uk

Winkworth

for every step...

winkworth.co.uk



DESCRIPTION:

We are pleased to offer this spacious and elegant apartment, set in a very desirable development on Hendon Lane. Greenacres is a very well maintained block and comes with an on-site caretaker, lift in block, spacious communal gardens, residents' parking and garage in block.

The property is bright and spacious throughout and comprises of a large reception room, incorporating living and dining areas, three bedrooms, kitchen, en-suite bathroom to the primary bedroom and an additional bathroom.

This truly is a wonderful property and an internal viewing is highly recommended.

Offered on a chain free basis

AT A GLANCE

- Purpose Built Block
- Second floor with a lift in the block
- Three bedrooms
- En suite to primary bedroom
- Large Reception Room
- Further Bathroom
- Residents Parking & Garage
- Chain free





Greenacres Hendon Lane, N3
 Approx. Gross Internal Floor Area 1032 sq. ft / 95.89 sq. m

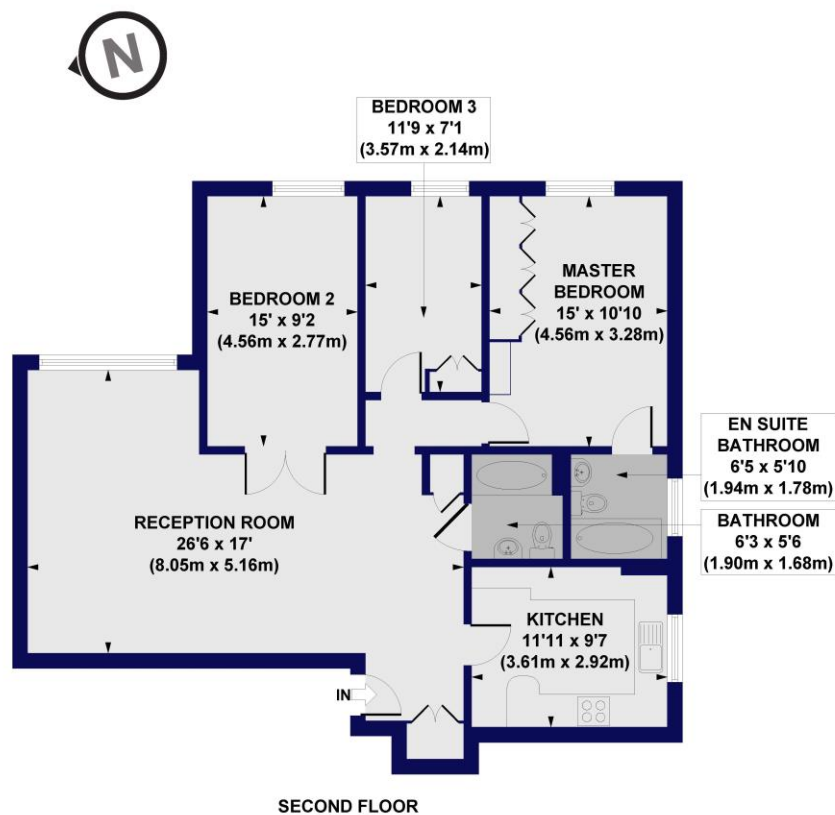

All measurements of walls, doors, windows, fittings and appliances, including their size and location, are shown as standard sizes and do not constitute any warranty or representation by the seller, their agent or CP Creative. Any intending purchaser must satisfy himself by inspection or otherwise as to the correctness of the information contained in these plans. This plan is for illustrative purposes only and should be used as such by any prospective purchasers.

Winkworth

This floorplan is for illustration purposes only and is not to scale. The position and size of doors, windows, appliances and other features are approximate.

Tenure: Leasehold

Term: 122 year and 8 months

Council Tax Band: G

Where no figures are shown, we have been unable to ascertain the information. All figures that are shown were correct at the time of printing.

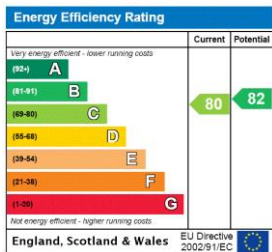

Winkworth

for every step...

Finchley | 020 8349 3388 | finchley@winkworth.co.uk

winkworth.co.uk

Winkworth wishes to inform prospective buyers and tenants that these particulars are a guide and act as information only. All our details are given in good faith and believed to be correct at the time of printing but they don't form part of an offer or contract. No Winkworth employee has authority to make or give any representation or warranty in relation to this property. All fixtures and fittings, whether fitted or not are deemed removable by the vendor unless stated otherwise and room sizes are measured between internal wall surfaces, including furnishings.