



FOX LANE, N13
£995,000 FREEHOLD

AN IMPRESSIVE FOUR BEDROOM CHARACTER HOME BOASTING SPACIOUS ACCOMMODATION WITH HIGH CEILINGS.

Palmers Green | 020 8920 9900 | palmersgreen@winkworth.co.uk

Winkworth

for every step...

winkworth.co.uk



DESCRIPTION:

A charming four bedroom semi-detached house situated in a desirable location, close to Palmers Green mainline BR station to Moorgate, and equidistant to the popular Broomfield Park and Grovelands Park.

The property boasts just under 1560 Sq.ft of well-appointed accommodation with character features including high panelled ceilings, fireplaces, stained glass windows, picture rails, stripped wood doors and some original flooring. A spacious reception room at the front of the house enjoys a southerly-aspect bay window and an open fireplace. The rear of the house has been reconfigured to create a stunning open-plan kitchen and a dining area. The dining area has an ornate wooden fireplace surround and bi-fold doors leading out to the garden, ideal for entertaining during the summer months. The kitchen provides an extensive range of units with a solid wood worktop and a breakfast bar, whilst a door at one end leads into a utility room which has space and plumbing for a washing machine. The ground floor also benefits from an impressive entrance hall with original parquet wood flooring and a guest WC. A wide L-shaped staircase leads up to the first floor where you will find four generously sized bedrooms, a contemporary family bathroom and a separate WC. The main bedroom is superbly sized and has a feature cast iron fireplace and a walk-in wardrobe. Externally the property enjoys a mature 80' long x 28' wide rear garden and a paved garden at the front.





Fox Lane, N13
Approx. Gross Internal Floor Area 1557 sq. ft / 144.68 sq. m

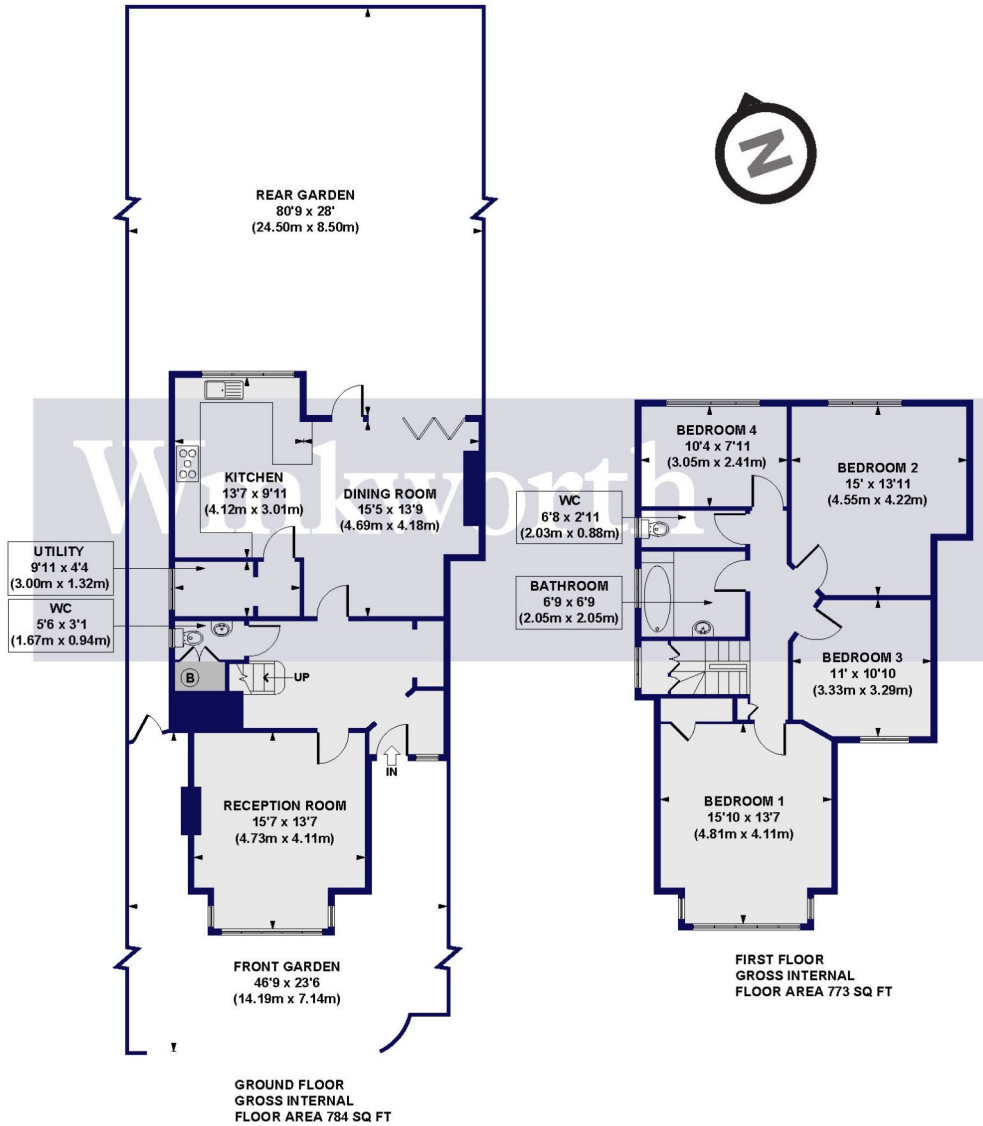

All measurements of walls, doors, windows, fittings and appliances, including their size and location, are shown as standard sizes and do not constitute any warranty or representation by the seller, their agent or CP Creative. Any intending purchaser must satisfy himself by inspection or otherwise as to the correctness of the information contained in these plans.

This floorplan is for illustration purposes only and is not to scale. The position and size of doors, windows, appliances and other features are approximate.

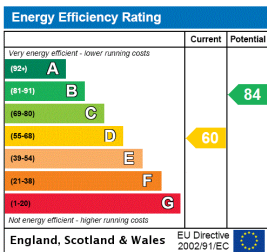

Palmers Green | 020 8920 9900 | palmersgreen@winkworth.co.uk

for every step...

winkworth.co.uk

Winkworth wishes to inform prospective buyers and tenants that these particulars are a guide and act as information only. All our details are given in good faith and believed to be correct at the time of printing but they don't form part of an offer or contract. No Winkworth employee has authority to make or give any representation or warranty in relation to this property. All fixtures and fittings, whether fitted or not are deemed removable by the vendor unless stated otherwise and room sizes are measured between internal wall surfaces, including furnishings.