



RADCLIFFE AVENUE, LONDON, NW10
£785,000 LEASEHOLD

**AT WINKWORTH WE ARE DELIGHTED TO BRING TO MARKET THIS TRULY
UNIQUE AND VISUALLY STUNNING THREE BEDROOM, TWO BATHROOM
APARTMENT MEASURING 1342 SQ.FT WITH THE ADDED BENEFIT OF A SOUTH
WEST FACING ROOM TERRACE.**

Kensal Rise & Queens Park | 0208 960 4947 | kensalrise@winkworth.co.uk

Winkworth

winkworth.co.uk

See things differently



LOCATION:

Radcliffe Avenue is situated in a lovely pocket of Edwardian streets just to the west of Kensal Rise in Kensal Green. Transport links from this location are very good with options at Kensal Green Tube Station or Willesden Junction which is a major hub including London Overground, Underground and links to National Rail. Local amenities, including an array of restaurants, deli's and cafes can be found at College Road which is less than a 1/2 mile from the front door. If it's green spaces that you require then look no further than Roundwood Park or King Edwards Park which are both close to this property.



Winkworth



DESCRIPTION:

The core of this fully extended and refurbished apartment is a unique central staircase that spirals upwards from the entrance on the ground floor all the way to the loft conversion. This loft space is incredible and houses a master bedroom, en-suite shower room, reading area and a west facing roof terrace. Below this on the first floor there is stunning 27ft x 17ft open plan living area with a contemporary fitted kitchen and island breakfast bar, plus lounging and dining areas. A wonderful living space indeed. Furthermore on this floor there is a family bathroom, kids bedroom and guest double with vaulted ceilings to the rear of the apartment. No expense has been spared in the design and creation of the fantastic property which must be viewed to be appreciated.

Winkworth

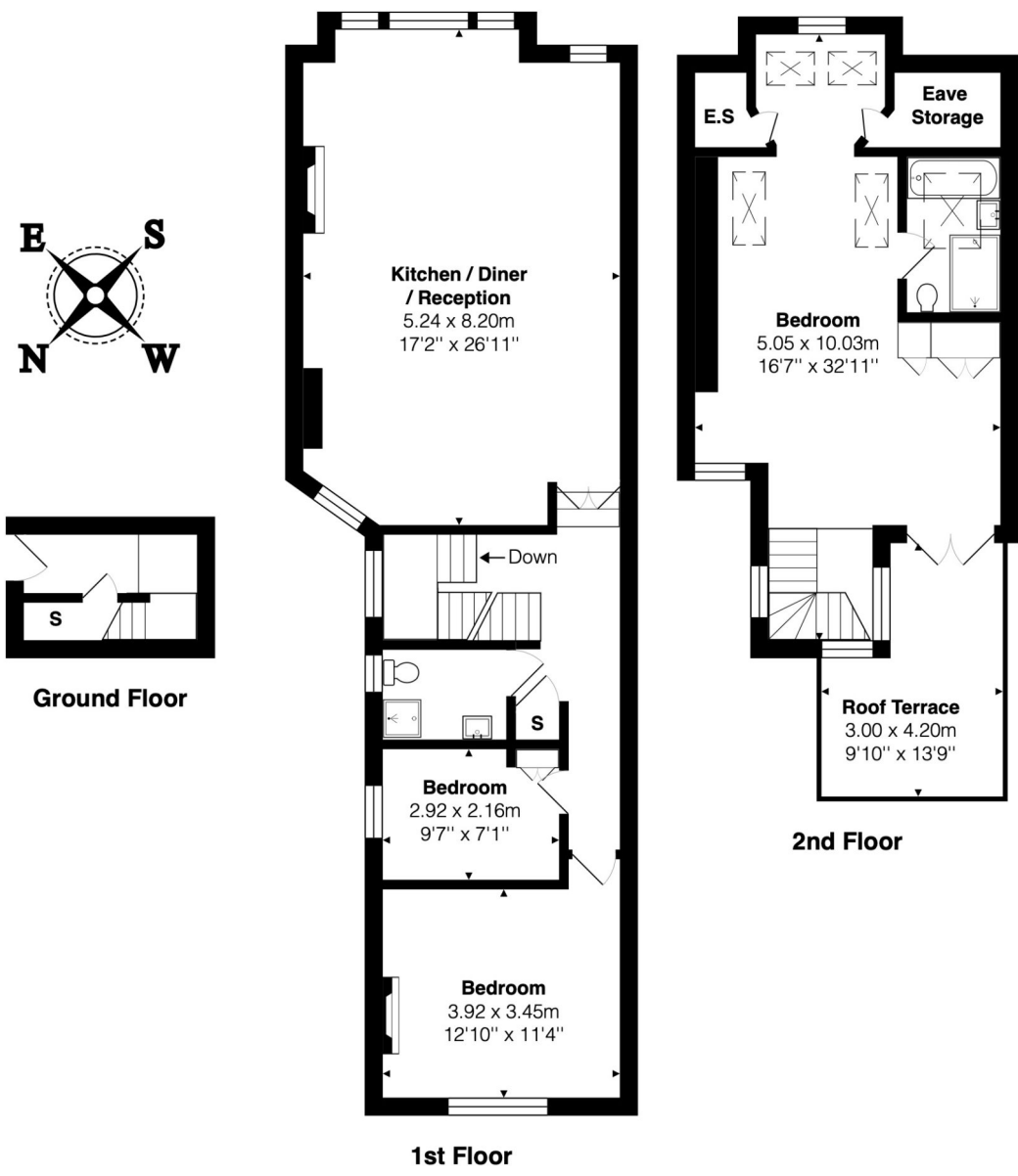

Total Area: 124.7 m² ... 1342 ft² (excluding roof terrace)
All measurements are approximate and for display purposes only

This floorplan is for illustration purposes only and is not to scale. The position and size of doors, windows, appliances and other features are approximate.

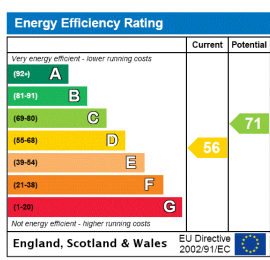

Kensal Rise & Queens Park | 0208 960 4947 | kensalrise@winkworth.co.uk



winkworth.co.uk

See things differently

winkworth wishes to inform prospective buyers and tenants that these particulars are a guide and act as information only. All our details are given in good faith and believed to be correct at the time of printing but they don't form part of an offer or contract. No winkworth employee has authority to make or give any representation or warranty in relation to this property. All fixtures and fittings, whether fitted or not are deemed removable by the vendor unless stated otherwise and room sizes are measured between internal wall surfaces, including furnishings.