



WAREHOUSE COURT, WOOLWICH ARSENAL, LONDON, SE18
£320,000 LEASEHOLD

AN IMMACULATE ONE BEDROOM MODERN APARTMENT THAT IS ON THE GROUND FLOOR OF THIS EXCITING NEW DEVELOPMENT LOCATED IN THE HEART OF THE ROYAL ARSENAL. JUST MOMENTS FROM CROSSRAIL AND SHOPS, MEASURING CIRCA 467 SQ FT. NO CHAIN!

Greenwich | 02030533033 | greenwich@winkworth.co.uk

Winkworth

for every step...

winkworth.co.uk



DESCRIPTION:

An immaculate one bedroom modern apartment that is on the ground floor of this exciting new development located in the heart of the Royal Arsenal. Just moments from Crossrail and shops, measuring circa 467 sq ft. No chain!

In fine decorative order the accommodation comprises of a lovely 23ft reception room, that has an open plan kitchen with integral white goods. This room in turn leads onto a large private terrace that overlooks the well kept central communal grounds. The main bedroom is a good size and has fitted wardrobes, plus there is a lovely family bathroom. Benefits include extra storage, video entry and access to a concierge. The property also comes with a parking space (which is a right to park).

The Woolwich Arsenal itself offers a superb array of shops, restaurants and food courts, plus sits adjacent to the river walkway. Moments from Crossrail, DLR and also riverboat service. The town centre is also close by. Your earliest

AT A GLANCE

- one bedroom apartment
- lovely condition
- ground floor
- circa 467 sq ft
- parking space (right to park)
- private terrace
- concierge service
- Royal Arsenal development
- moment from shops
- next to Crossrail





Ground Floor

Approx. 43.4 sq. metres (467.6 sq. feet)

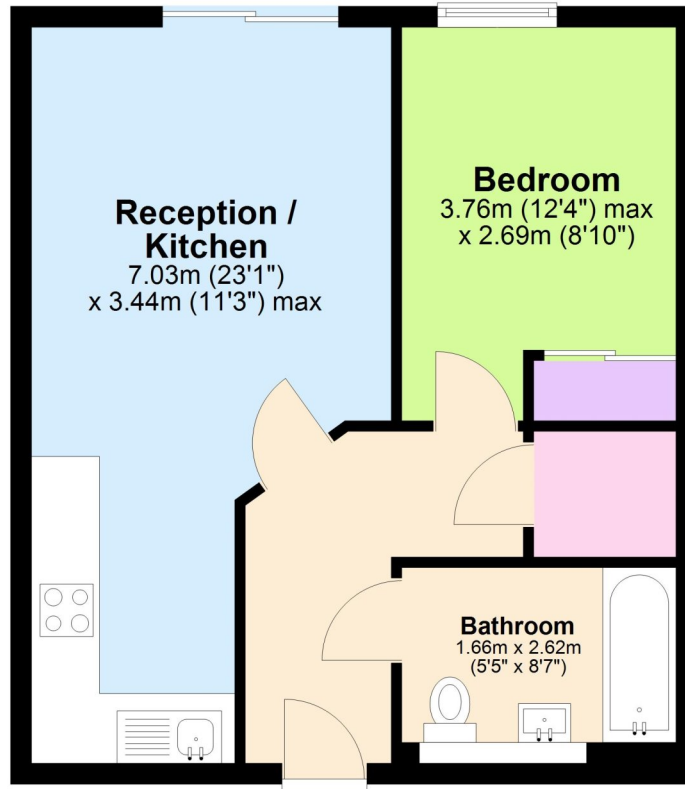

Total area: approx. 43.4 sq. metres (467.6 sq. feet)

This floorplan is for illustration purposes only and is not to scale. The position and size of doors, windows, appliances and other features are approximate.

Tenure: Leasehold

Term: tbc

Service Charge: £1951 per annum

Ground Rent: £ 452 Annually (subject to increase)

Council Tax Band: tbc

Where no figures are shown, we have been unable to ascertain the information. All figures that are shown were correct at the time of printing.

Greenwich | 02030533033 | greenwich@winkworth.co.uk

Winkworth

for every step...

winkworth.co.uk

Winkworth wishes to inform prospective buyers and tenants that these particulars are a guide and act as information only. All our details are given in good faith and believed to be correct at the time of printing but they don't form part of an offer or contract. No Winkworth employee has authority to make or give any representation or warranty in relation to this property. All fixtures and fittings, whether fitted or not are deemed removable by the vendor unless stated otherwise and room sizes are measured between internal wall surfaces, including furnishings.