



SPRING WALK, LONDON, E1
£3,250 PER MONTH FURNISHED

STYLISH & SPACIOUS THREE-BEDROOM HOME IN A PRIME LOCATION

Shoreditch | 020 7749 7650 | shoreditch@winkworth.co.uk

Tenant Fees Apply: Details of fees for tenant referencing, tenancy agreement admin fees and renewal fees are available on the Winkworth website and the link can be found with the displayed rent for the property. Tenants should ensure they are fully conversant with these upfront fees and other costs that are involved at the outset of the tenancy before making an offer to rent and your local Winkworth office will provide written details upon request.

[winkworth.co.uk](https://www.winkworth.co.uk)

Winkworth

See things differently



DESCRIPTION:

Nestled in a quiet and secluded setting, this charming three-bedroom terraced house offers the perfect blend of modern living and convenience, just 485m from Aldgate East (District, Hammersmith & City) and Whitechapel Tube (Elizabeth line) Stations.

Designed with a neutral, contemporary finish throughout, the property is ideal for sharers and professionals alike. It features three generously sized double bedrooms, a modern bathroom, and a spacious, well-equipped kitchen with ample cupboard and worktop space. The bright and airy reception room is a true highlight, benefiting from large sliding French doors that flood the space with natural light and open onto a private patio garden—perfect for relaxing or entertaining.

Offered fully furnished, this property combines stylish interiors with an unbeatable location, making it an excellent choice for those seeking comfort and convenience in the heart of East London.

Winkworth



Winkworth

Spring Walk, E1

Approx. Gross Internal Floor Area 954 sq. ft / 88.67 sq. m

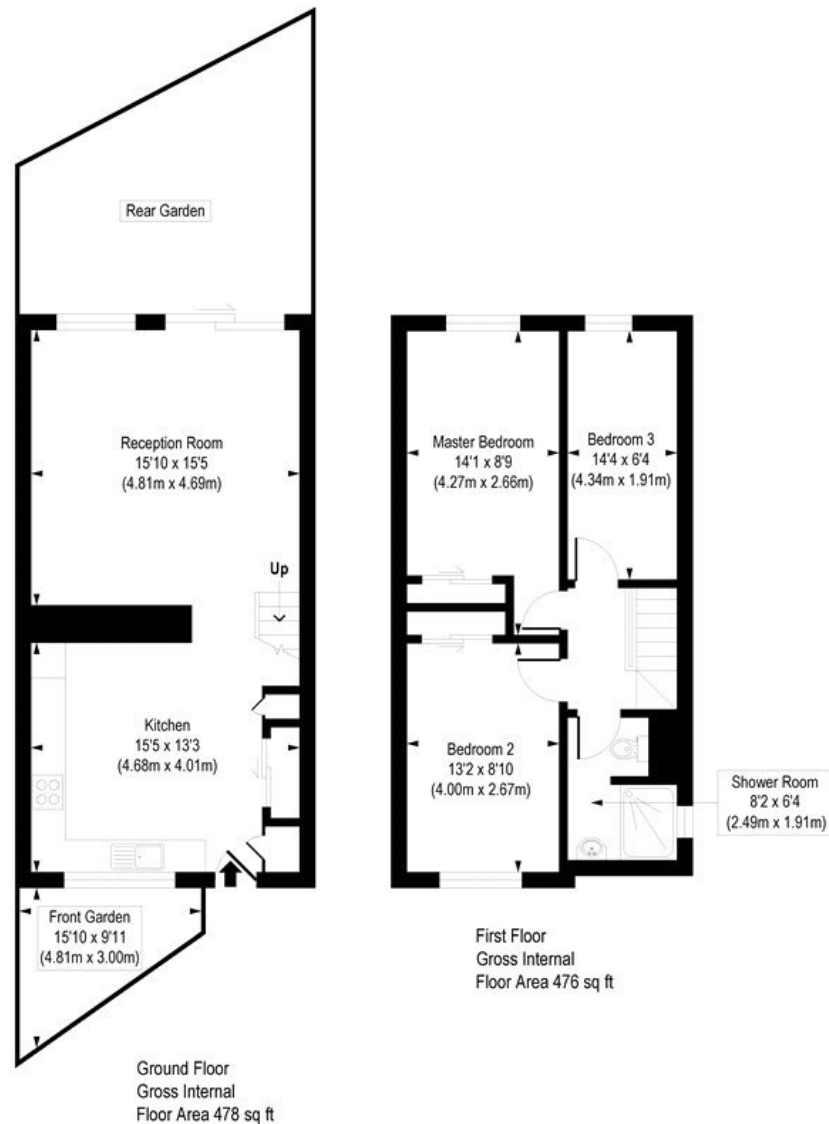

COMPLIANT WITH RICS CODE OF MEASURING PRACTICE Floorplan is for illustrative purposes only and is not to scale. Every attempt has been made to ensure the accuracy of the floorplan shown, however all measurements, fixtures, fittings and data shown are an approximate interpretation for illustrative purposes only. Liability for errors, omissions or mis-statement through negligence or otherwise is hereby excluded.

This floorplan is for illustration purposes only and is not to scale. The position and size of doors, windows, appliances and other features are approximate.

Shoreditch | 020 7749 7650 | shoreditch@winkworth.co.uk

Winkworth

winkworth.co.uk

See things differently

Winkworth wishes to inform prospective buyers and tenants that these particulars are a guide and act as information only. All our details are given in good faith and believed to be correct at the time of printing but they don't form part of an offer or contract. No Winkworth employee has authority to make or give any representation or warranty in relation to this property. All fixtures and fittings, whether fitted or not are deemed removable by the vendor unless stated otherwise and room sizes are measured between internal wall surfaces, including furnishings.