



LINKS VIEW, FINCHLEY, LONDON, N3
£699,950 FREEHOLD

**A WELL PRESENTED THREE BEDROOM END OF
TERRACE TOWNHOUSE SET IN A QUIET
RESIDENTIAL TURNING**

Finchley | 020 8349 3388 | finchley@winkworth.co.uk

Winkworth

for every step...

winkworth.co.uk



DESCRIPTION:

BLOCK VIEWING TAKING PLACE ON SATURDAY 21ST JUNE, PLEASE CALL US TO BOOK YOUR SLOT AND NOT MISS OUT.

We are pleased to offer this well-presented three bedroom, two bathroom townhouse, situated in a private cul-de-sac off Dollis Road. Ideally placed for local amenities, including Finchley Central underground station, recreational parkland and outstanding Ofsted rated schools. This lovely family home offers ample space over four floors and comprises spacious living room leading to rear garden on the lower ground floor. A modern fitted kitchen, additional reception room and downstairs WC to the ground floor. A wonderful master bedroom with en suite to the first floor and an additional two bedrooms and bathroom on the top floor. Further, as the property is at the end of the cul-de-sac, it benefits from having a larger garden with land and access to the side. An internal viewing is highly recommended!

AT A GLANCE

- End of Terrace
- Two reception rooms
- Three bedrooms
- Master with en suite
- Spacious rear garden
- Off street parking
- Modern fitted kitchen & bathroom





Links View, N3 Approx. Gross Internal Floor Area 1266 sq. ft / 117.65 sq. m

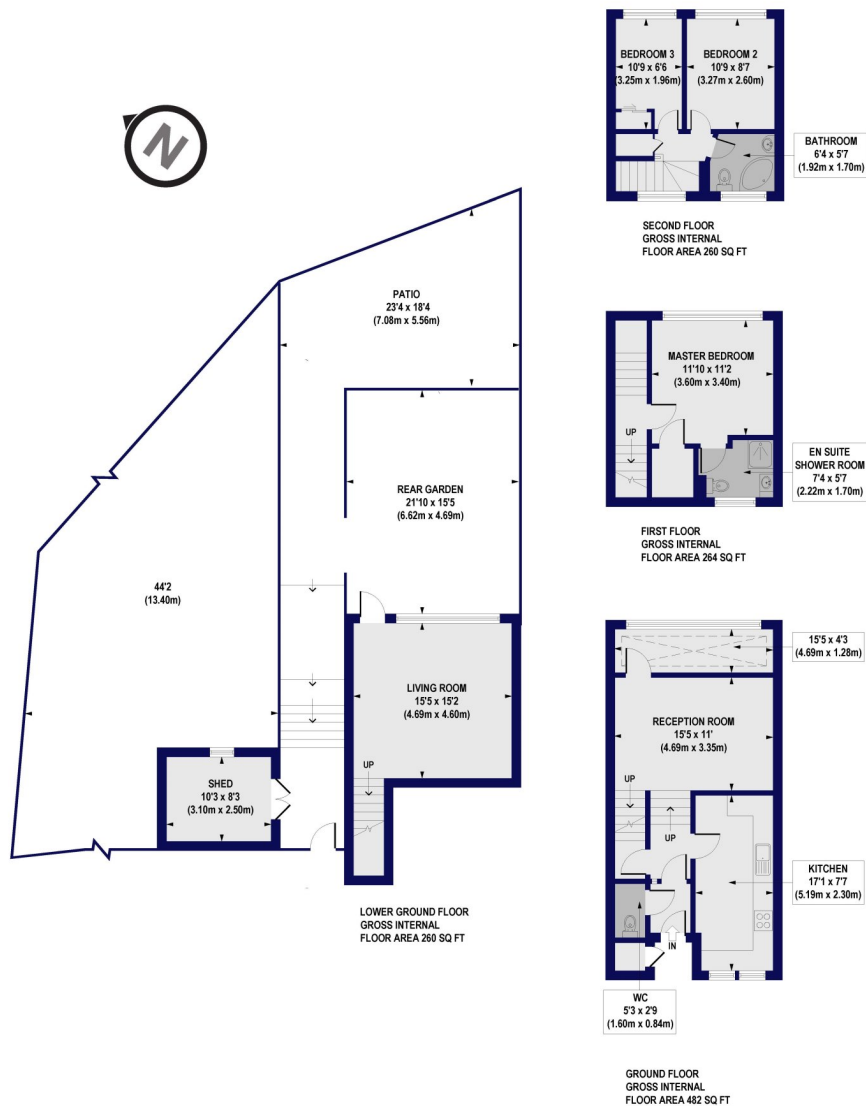

All measurements of walls, doors, windows, fittings and appliances, including their size and location, are shown as standard sizes and do not constitute any warranty or representation by the seller, their agent or CP Creative. Any intending purchaser must satisfy himself by inspection or otherwise as to the correctness of the information contained in these plans. This plan is for illustrative purposes only and should be used as such by any prospective purchasers.

Winkworth

This floorplan is for illustration purposes only and is not to scale. The position and size of doors, windows, appliances and other features are approximate.

Tenure: Freehold

Council Tax Band: E

Where no figures are shown, we have been unable to ascertain the information. All figures that are shown were correct at the time of printing.

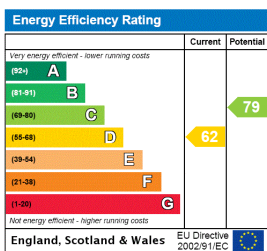

Finchley | 020 8349 3388 | finchley@winkworth.co.uk

Winkworth

for every step...

winkworth.co.uk

Winkworth wishes to inform prospective buyers and tenants that these particulars are a guide and act as information only. All our details are given in good faith and believed to be correct at the time of printing but they don't form part of an offer or contract. No Winkworth employee has authority to make or give any representation or warranty in relation to this property. All fixtures and fittings, whether fitted or not are deemed removable by the vendor unless stated otherwise and room sizes are measured between internal wall surfaces, including furnishings.