



THE PINNACLE, 2 DOVE ROAD, LONDON, N1  
£400,000 LEASEHOLD

## A WONDERFUL ONE BEDROOM APARTMENT WITH COMMUNAL GARDEN AND ROOF TERRACE

Islington | 0207 354 2480 | [islington@winkworth.co.uk](mailto:islington@winkworth.co.uk)

**Winkworth**

[winkworth.co.uk](http://winkworth.co.uk)

See things differently





## DESCRIPTION:

This superb apartment is set on the second floor of this modern block on Essex road. Spanning in excess of 500sqft, the property offers well-proportioned rooms throughout, benefits from double-glazed windows and is offered to the market chain free. A sizable reception room and adjoining kitchen offer a fantastic entertaining space. The master bedroom offers inbuilt storage which is next to the sizeable family bathroom. The property further benefits from access to a roof terrace with stunning city views, a further communal garden and is offered to the market chain free.

The Pinnacle is conveniently located close to many restaurants, bars and boutique shops on Upper Street and is just a short distance away from Highbury fields.

Highbury and Islington station (Victoria Line) is the closest underground providing easy access to the West End and Kings Cross. International travel is offered from St Pancras, whilst over ground services are provided from Canonbury for easy access to East London, Shoreditch and the City. A variety of bus routes are also on hand for effortless access across London.

**Winkworth**





Winkworth

The Pinnacle, Dove Road, N1  
Approx. Gross Internal Floor Area 512 sq. ft / 47.60 sq. m

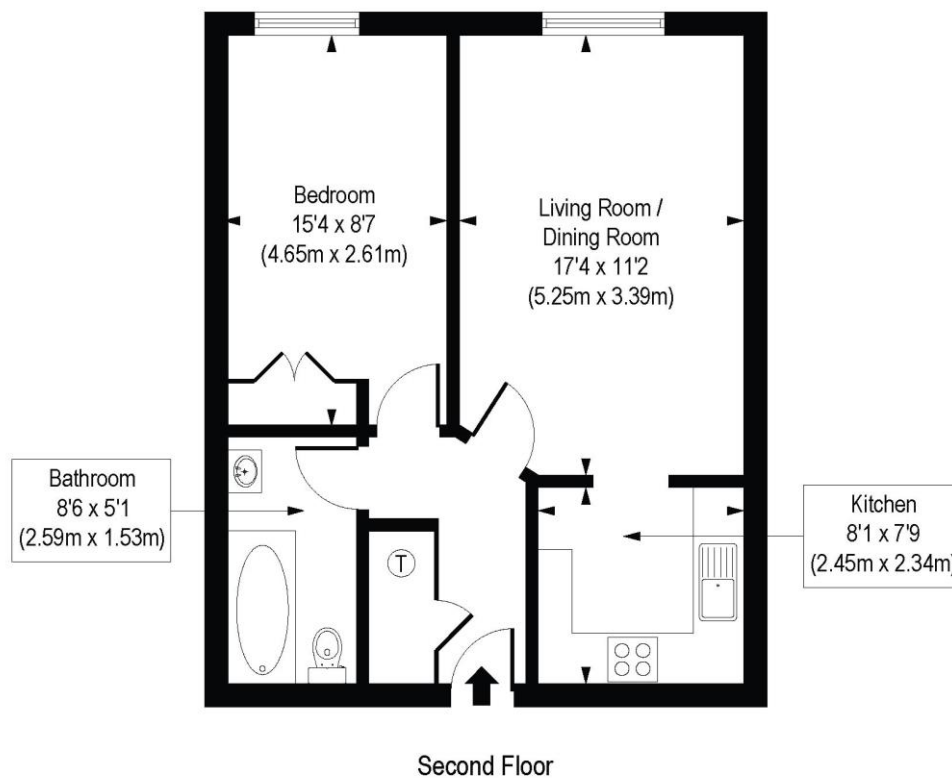

COMPLIANT WITH RICS CODE OF MEASURING PRACTICE. Floorplan is for illustrative purposes only and is not to scale. Every attempt has been made to ensure the accuracy of the floorplan shown, however all measurements, fixtures, fittings and data shown are an approximate interpretation for illustrative purposes only. Liability for errors, omissions or mis-statement through negligence or otherwise is hereby excluded.

This floorplan is for illustration purposes only and is not to scale. The position and size of doors, windows, appliances and other features are approximate.

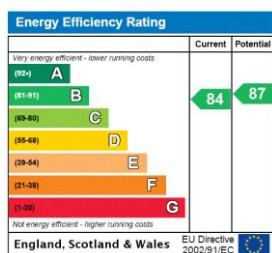

Islington | 0207 354 2480 | [islington@winkworth.co.uk](mailto:islington@winkworth.co.uk)

**Winkworth**

[winkworth.co.uk](http://winkworth.co.uk)

See things differently

Winkworth wishes to inform prospective buyers and tenants that these particulars are a guide and act as information only. All our details are given in good faith and believed to be correct at the time of printing but they don't form part of an offer or contract. No Winkworth employee has authority to make or give any representation or warranty in relation to this property. All fixtures and fittings, whether fitted or not are deemed removable by the vendor unless stated otherwise and room sizes are measured between internal wall surfaces, including furnishings.