



GREENWICH SOUTH STREET, GREENWICH, LONDON, SE10  
**£275,000 LEASEHOLD**

**WE ARE DELIGHTED TO OFFER THIS DELIGHTFUL LITTLE ONE BEDROOM CONVERSION FLAT, THAT MEASURES CIRCA 348 SQ FT, THAT WOULD MAKE A PERFECT BUY TO LET INVESTMENT AND IS LOCATED IN WEST GREENWICH.**

Greenwich | 02030533033 | [greenwich@winkworth.co.uk](mailto:greenwich@winkworth.co.uk)

**Winkworth**

*winkworth.co.uk*

See things differently

## DESCRIPTION:

We are delighted to offer this delightful little one bedroom conversion flat, that measures circa 348 sq ft, that would make a perfect BUY TO LET investment and is located in West Greenwich.

In good order and found on the first floor of this Victorian house, the property comprises a 24ft lounge with a small open plan kitchen area. This in turn leads onto a shower room and a 13ft bedroom. Added features include laminate flooring and a large storage room which is found just off the first floor landing.

Greenwich South Street is perfectly located in West Greenwich and is only a short walk to mainline rail and DLR. The town centre is also close by and offers a wide variety of shops and restaurants, along with the immensely popular Greenwich Market and Royal Park, with its Observatory.

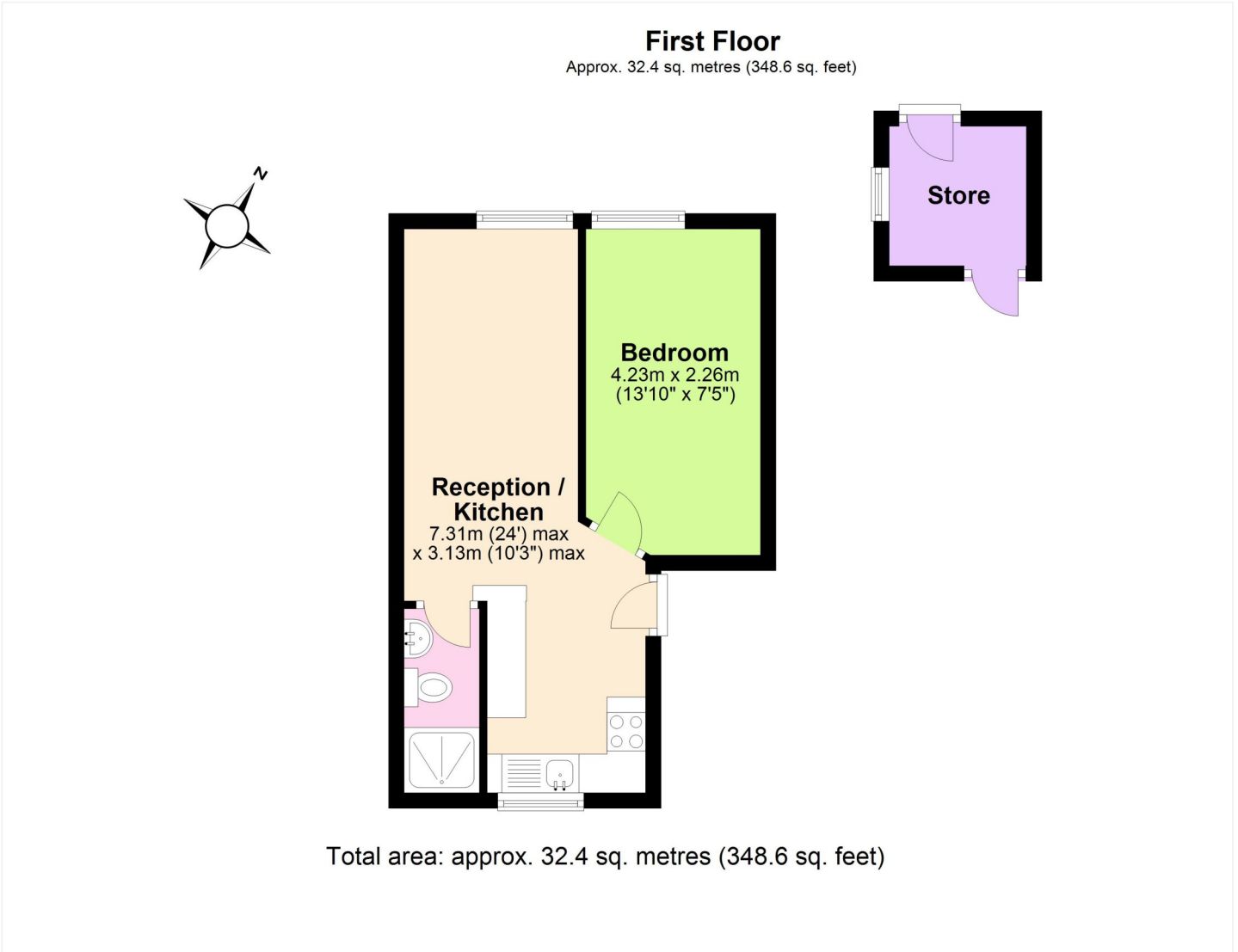

This floorplan is for illustration purposes only and is not to scale. The position and size of doors, windows, appliances and other features are approximate.

Energy Efficiency Rating		Current	Potential
<small>Very energy efficient - lower running costs</small>			
(92)	<b>A</b>		81
(81-91)	<b>B</b>		
(69-80)	<b>C</b>	69	
(55-68)	<b>D</b>		
(39-54)	<b>E</b>		
(21-58)	<b>F</b>		
(1-20)	<b>G</b>		
<small>Not energy efficient - higher running costs</small>			
England, Scotland & Wales		EU Directive 2002/91/EC	

