



ELVER GARDENS, LONDON, E2
£525,000 LEASEHOLD

BRIGHT, WESTERLY FACING MAISONETTE IN BETHNAL GREEN

Shoreditch | 020 7749 7650 | shoreditch@winkworth.co.uk

Winkworth

winkworth.co.uk

See things differently



DESCRIPTION:

A bright and well-presented two-bedroom duplex apartment, located within a quiet and well-maintained residential development in the heart of Bethnal Green, E2. Set across two floors, the property offers a spacious and practical layout with a desirable westerly-facing aspect, allowing for an abundance of natural light throughout the afternoon and evening.

The interior comprises two well-sized double bedrooms, a spacious and light-filled reception room, a separate modern kitchen, a stylish bathroom, and an additional WC for extra convenience. The thoughtful duplex layout offers a clear distinction between living and sleeping areas, ideal for both relaxing and entertaining. The property also boasts a wealth of built-in storage options throughout, providing excellent functionality for modern living.

Externally, the home benefits from a private, fenced front garden—perfect for secure bike storage, a touch of greenery, or enjoying a quiet moment outdoors.

Ideally situated, Elver Gardens is within walking distance of Columbia Road Flower Market, Broadway Market, and Victoria Park, while nearby Shoreditch and Hackney offer a wide range of independent shops, cafes, and nightlife.

Bethnal Green Underground (Central Line) and Overground stations are both close by, offering excellent links into the City, Canary Wharf, and across London.

This bright, well-located home with generous storage and private outdoor space is perfect for first-time buyers, professionals, or investors seeking a solid opportunity in a highly desirable East London postcode. Viewings are highly recommended.

Winkworth



Winkworth

Elver Gardens, E2

Approx. Gross Internal Floor Area 812 sq. ft / 75.47 sq. m

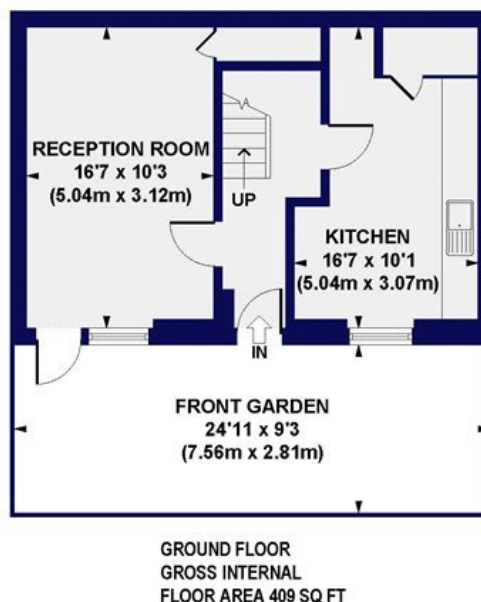
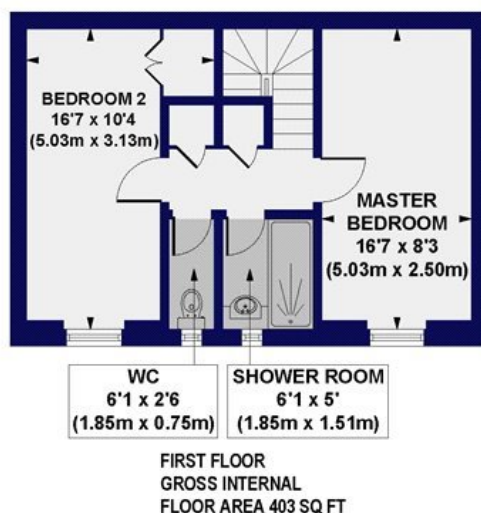

All measurements of walls, doors, windows, fittings and appliances, including their size and location, are shown as standard sizes and do not constitute any warranty or representation by the seller, their agent or CP Creative. Any intending purchaser must satisfy himself by inspection or otherwise as to the correctness of the information contained in these plans. This plan is for illustrative purposes only and should be used as such by any prospective purchasers.

Winkworth

This floorplan is for illustration purposes only and is not to scale. The position and size of doors, windows, appliances and other features are approximate.



<https://www.winkworth.co.uk/sale/property/SO250416>

Tenure: Leasehold

Term: 215 year and 0 months

Service Charge: £3179 per annum

Ground Rent: £ 10 Annually (subject to increase)

Council Tax Band: B

Where no figures are shown, we have been unable to ascertain the information. All figures that are shown were correct at the time of printing.

Shoreditch | 020 7749 7650 | shoreditch@winkworth.co.uk

Winkworth

[winkworth.co.uk](https://www.winkworth.co.uk)

See things differently

Winkworth wishes to inform prospective buyers and tenants that these particulars are a guide and act as information only. All our details are given in good faith and believed to be correct at the time of printing but they don't form part of an offer or contract. No Winkworth employee has authority to make or give any representation or warranty in relation to this property. All fixtures and fittings, whether fitted or not are deemed removable by the vendor unless stated otherwise and room sizes are measured between internal wall surfaces, including furnishings.