



**OVINGTON SQUARE, KNIGHTSBRIDGE, SW3
£460 PER WEEK FURNISHED**

LIGHT AND BRIGHT FLAT IN THIS ATTRACTIVE WHITE STUCCO FRONTED BUILDING IN KNIGHTSBRIDGE

Knightsbridge & Chelsea | 0207 589 6616 | knightsbridge@winkworth.co.uk

Tenant Fees Apply: Details of fees for tenant referencing, tenancy agreement admin fees and renewal fees are available on the Winkworth website and the link can be found with the displayed rent for the property. Tenants should ensure they are fully conversant with these upfront fees and other costs that are involved at the outset of the tenancy before making an offer to rent and your local Winkworth office will provide written details upon request.



DESCRIPTION:

A light and bright third floor flat in this attractive white stucco fronted building in the centre of Knightsbridge. This garden square property is available fully furnished.



Ovington Square, SW3

Approx. Gross Internal Area *
413 Sq Ft - 38.37 Sq M

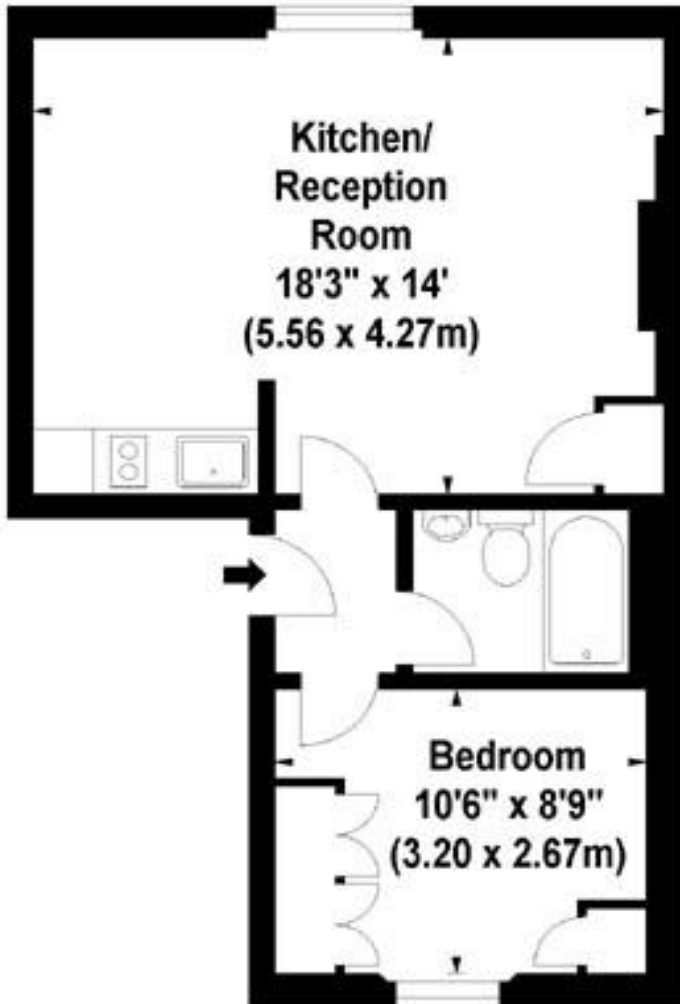

Third Floor

This floorplan is for illustration purposes only and is not to scale. The position and size of doors, windows, appliances and other features are approximate.

Energy Efficiency Rating		
	Current	Potential
<i>Very energy efficient - lower running costs</i>		
(92+) A		
(81-91) B		
(69-80) C		68
(55-68) D		
(39-54) E	42	
(21-38) F		
(1-20) G		
<i>Not energy efficient - higher running costs</i>		
England, Scotland & Wales	EU Directive 2002/91/EC	