



WOODSIDE GROVE, LONDON, N12
£300,000 LEASEHOLD

A WELL PRESENTED ONE BEDROOM FLAT
IDEALLY LOCATED FOR AMENITIES &
TRANSPORT LINKS.

Finchley | 020 8349 3388 | finchley@winkworth.co.uk

Winkworth

for every step...

winkworth.co.uk



DESCRIPTION:

A spacious one bedroom first floor flat situated within a 12 minute walk to Woodside Park underground station. This modern property comprise of large double bedroom with wardrobes, tiled bathroom, L-shaped living room, separate kitchen, door entry system, double glazed window and gas central heating. This would be an ideal purchase for a first time buyer or buy to let investment.

Offered on a chain free basis.

An internal viewing highly recommended.



Rouge Court, Woodside Grove, N12
Approx. Gross Internal Floor Area 520 sq. ft / 48.29 sq. m

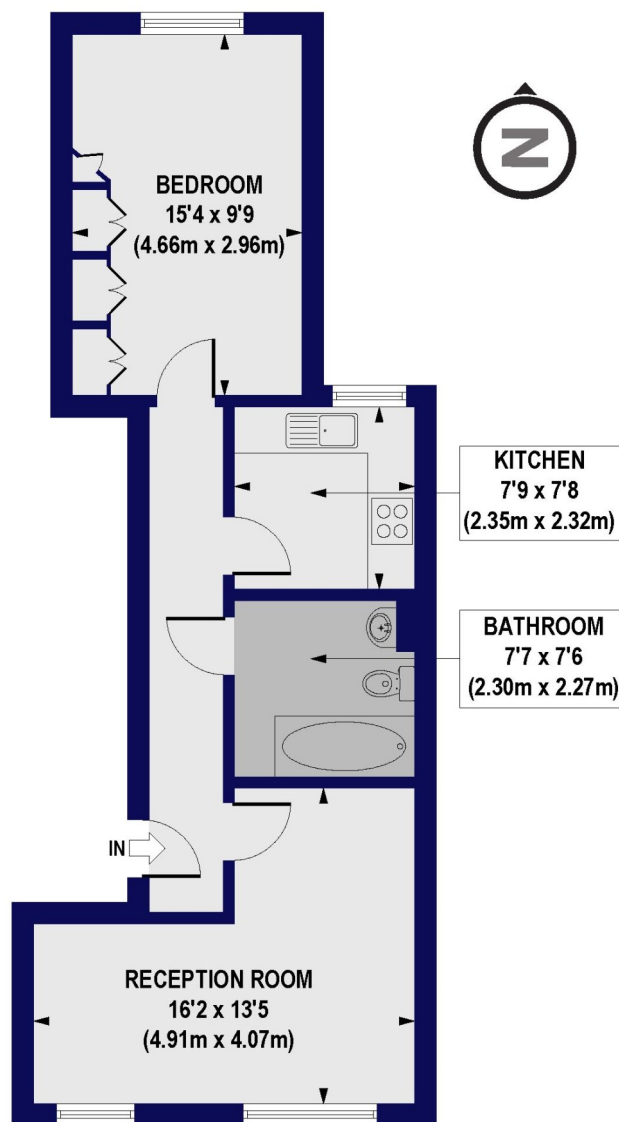

FIRST FLOOR

All measurements of walls, doors, windows, fittings and appliances, including their size and location, are shown as standard sizes and do not constitute any warranty or representation by the seller, their agent or CP Creative. Any intending purchaser must satisfy himself by inspection or otherwise as to the correctness of the information contained in these plans. This plan is for illustrative purposes only and should be used as such by any prospective purchasers.

Winkworth

This floorplan is for illustration purposes only and is not to scale. The position and size of doors, windows, appliances and other features are approximate.

| Energy Efficiency Rating | |
|---|-------------------------|
| | Potential |
| Very energy efficient - lower running costs | |
| (92-100) A | |
| (81-91) B | |
| (69-80) C | 76 78 |
| (55-68) D | |
| (39-54) E | |
| (21-38) F | |
| (1-20) G | |
| Not energy efficient - higher running costs | |
| England, Scotland & Wales | EU Directive 2002/91/EC |

Finchley | 020 8349 3388 | finchley@winkworth.co.uk

Winkworth

for every step...

winkworth.co.uk

Winkworth wishes to inform prospective buyers and tenants that these particulars are a guide and act as information only. All our details are given in good faith and believed to be correct at the time of printing but they don't form part of an offer or contract. No Winkworth employee has authority to make or give any representation or warranty in relation to this property. All fixtures and fittings, whether fitted or not are deemed removable by the vendor unless stated otherwise and room sizes are measured between internal wall surfaces, including furnishings.