



Winkworth

Athos Close, London, N2

£875,000 *Freehold*

2  1  2 

A stunning and modern, two bedroom, two bathroom house, arranged over two floors in this exclusive gated, walled development of luxury houses set in beautiful landscaped grounds.

KEY FEATURES

- Set behind security gates
- Modern development
- Two bedrooms house
- Modern fitted kitchen & bathrooms
- Private garden & Parking
- High EPC rating



Winkworth



Winkworth

Finchley

020 8349 3388 | finchley@winkworth.co.uk

Winkworth

for every step...



The property comprises of a spacious lounge area, with access to a private garden via French doors, a fully integrated kitchen and downstairs cloakroom to complete the ground floor.

The first floor consists of two double bedrooms with ensuite to the primary bedroom and family bathroom.

The property comes with parking and an internal viewing is highly recommended.





Winkworth



Winkworth



Winkworth



Winkworth

MATERIAL INFO

Tenure: Freehold
Service Charge: £1100 per annum
Council Tax Band: E
EPC rating: A

Athos Close, N2

Approx. Gross Internal Floor Area 1039 sq. ft / 96.51 sq. m

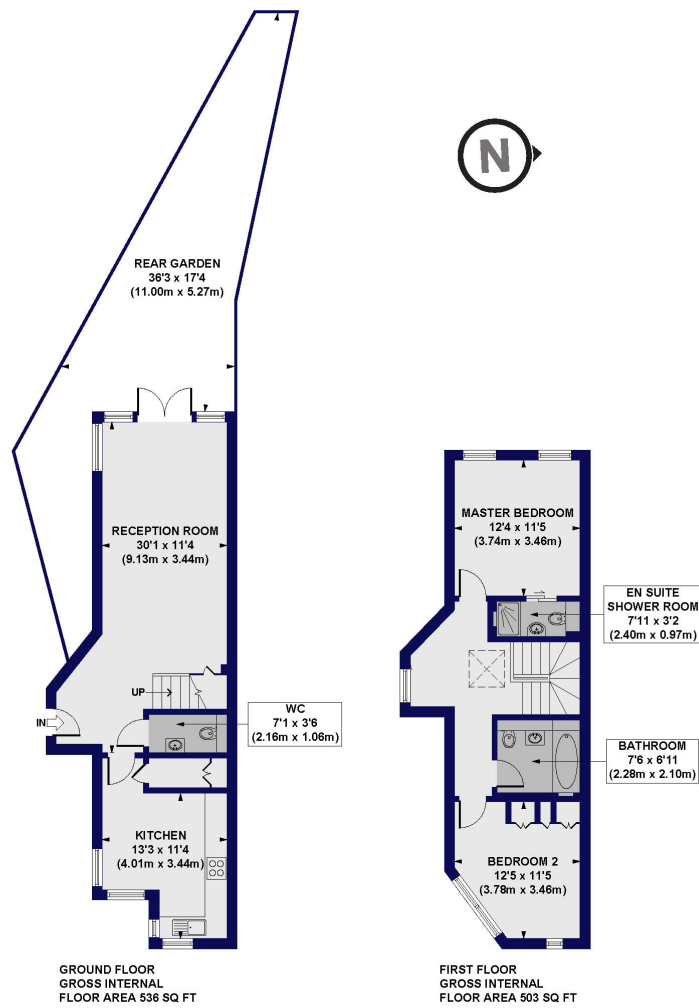

All measurements of walls, doors, windows, fittings and appliances, including their size and location, are shown as standard sizes and do not constitute any warranty or representation by the seller, their agent or CP Creative. Any intending purchaser must satisfy himself by inspection or otherwise as to the correctness of the information contained in these plans. This plan is for illustrative purposes only and should be used as such by any prospective purchasers.

Winkworth

Score	Energy rating	Current	Potential
92+	A	94 A	95 A
81-91	B		
69-80	C		
55-68	D		
39-54	E		
21-38	F		
1-20	G		

For more information, scan the QR code or visit the link below

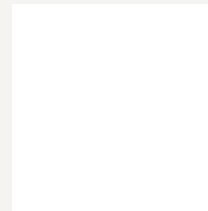

<https://www.winkworth.co.uk/sale/property/FIN260004>

Where no figures are shown, we have been unable to ascertain the information. All figures that are shown were correct at the time of printing.

Finchley

020 8349 3388 | finchley@winkworth.co.uk

Winkworth

for every step...

Winkworth wishes to inform prospective buyers and tenants that these particulars are a guide and act as information only. All our details are given in good faith and believed to be correct at the time of printing but they don't form part of an offer or contract. No Winkworth employee has authority to make or give any representation or warranty in relation to this property. All fixtures and fittings, whether fitted or not are deemed removable by the vendor unless stated otherwise and room sizes are measured between internal wall surfaces, including furnishings.